

DRAIN

ADDRESS

Permit

No. # 9

SHIRLEY ST., N. SIDE

W. OF ANGIE TEND

Enters SHIRLEY ST. SEWER

Drain Plot No. 121

From Property of D. J. REALTY CORP.

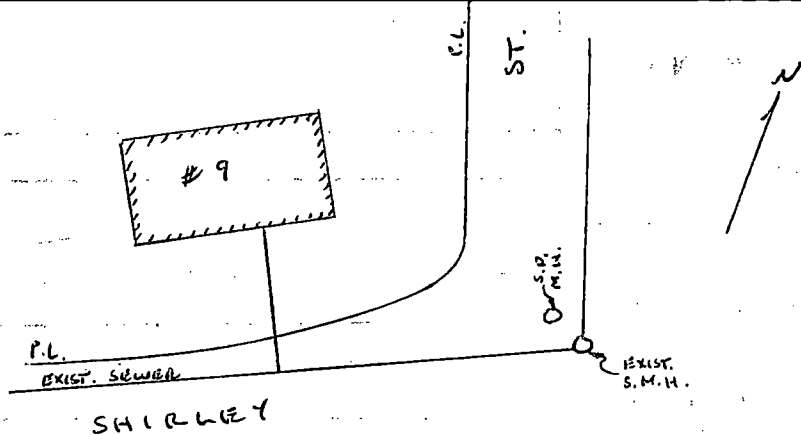

HOUSE PLOTTED FROM AERIAL PHOTO
 PIPE LOCATION " " D.J. REALTY INFO.

11-26-84