

DRAIN

Permit  
No. 9816-15

# 165 Reed St.  
Hawthorn to Maple.  
enters Reed St. sewer.

6 " pipe.

Aug. 15, 1916.

From Property of John C. Brown.

Located N. S. Reed St.

Account Misc. Ledger

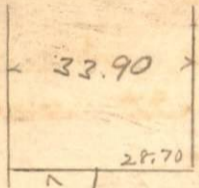

295  
 156  
 ---  
 139

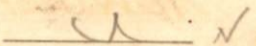

Maple St

Reed St.

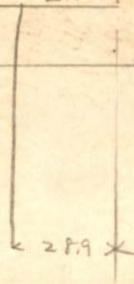

156.00

