

DRAIN

Permit

No. 9551-15

Newton St.  
Court to Elm.  
enters Newton St. sewer.  
6" pipe.

Dec. 3, 1915.

From Property of

George E. Jepson.

Located

N. S. Newton St.

Account Misc. Ledger

BY F. O. DEMELLO

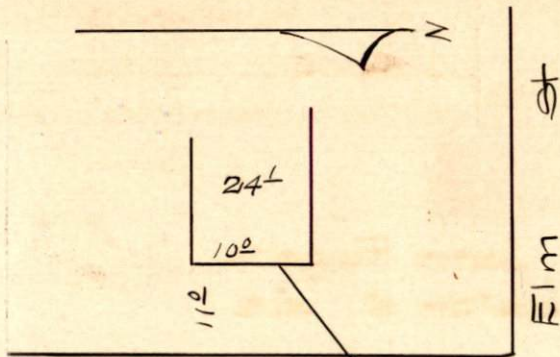

Newton

$\nwarrow \nearrow$   $224^L$   $\searrow$

$226^L$  St