

DRAIN

Permit

No. 9366-15

Taitland St.

Richmond to Shawmut Ave.

enters Taitland St. sewer?

6" pipe.

July 9, 1915.

From Property of C.T.T. Sylvia.

Located n.e. cor. Shawmut Ave.

Account Misc. Ledger

BY F O DEMELLO

SHANNON CVC.

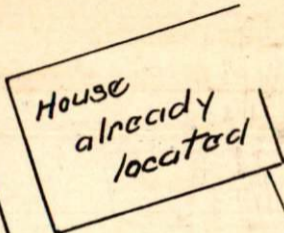

House
already
located

old private drain
discontinued.

Taitland St.



224.8
end of sewer