

✓
DRAIN

Shawmut Ave.
Parker to Locust.

Permit

No. 929-1892

Enters Shawmut Ave. Sewer.

106¹⁰ ft. n. of Parker. 6" p. Apr. 16, 1892, at 11
A.M. by John H. Coffey.

From property of

James Thorpe.

Located

Shawmut Ave. n. s. 107⁶⁰ n. of Parker.

Account

Miss Ledger 220

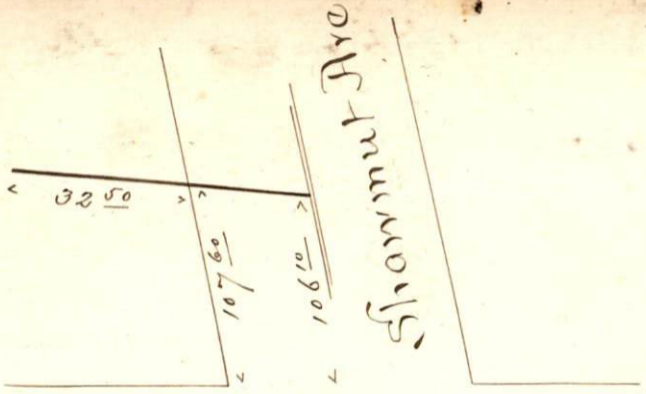

Parker



St