

✓
DRAIN

Permit

No. 64461902

Myrtle St.
Weld to Clark.

Enter Myrtle sewer at

106' so of Clark 5p, April 25 1902
at 3 P M. by F. B. Lee Mello

From property of

Calvin Jones

Located

Myrtle ns. 107.0' so of Clark

Account Misc. Ledger

p 275

Clark St

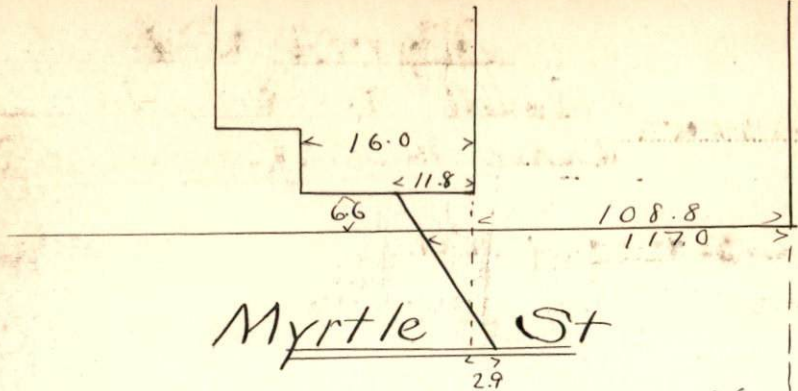

DN