

DRAIN

Permit

No. 5942-10

Earle Street
Belleville Ave. to Front St.

Enters Earle Street Sewer.
6" pipe.

June 16, 1910 at 11 A.M. by F.C. DeMello

From Property of Francis Lambert

Located N.S. east of No. Front St.

Account Misc. Ledger

Front.

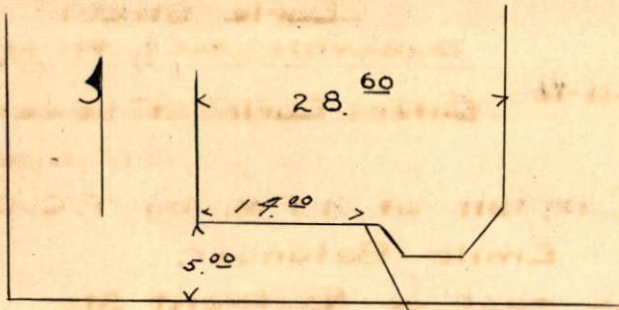

Earle St. 1900
92 30 x