

DRAIN

39

Permit
No. 4875-09

SYCAMORE ST.

Emerson to Park

Enters Sycamore St. Sewer.
6" Pipe

June 22, 1909 at 2 P.M. by F.C. DeMello

From Property of Thomas L. Parsons.

Located W.S. Emerson north of Sycamore.

Account Misc. Ledger

N 

Emerson St.

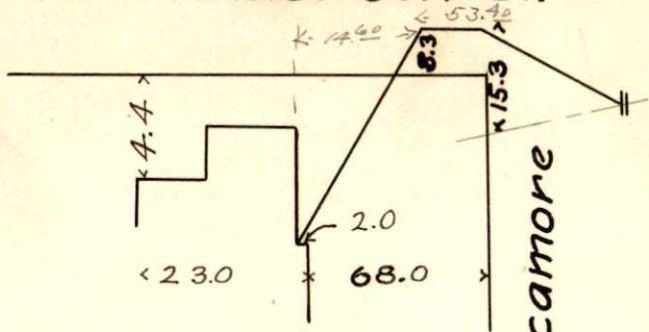

Sycamore