

DRAIN

Permit

No.

4413-08

✓  
Earle St.  
Bowditch to Brook  
Earle St. Sewer.

6" pipe.

Dec. 9, 1908 at 4 P.M. by F. C. DeMello

From Property of J. A. Bernier.

Located N.S.

Account Misc. Ledger

BROOK

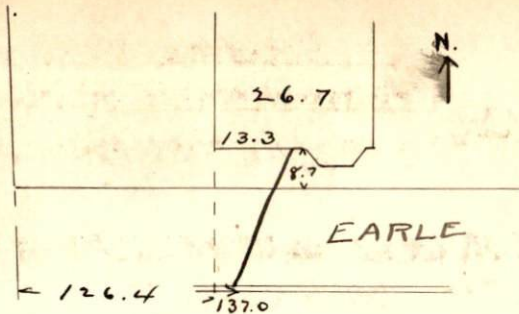

26.7

13.3

8.7

EARLE

126.4

137.0

