

✓
DRAIN

Permit
No. 258-1902

Phillips Ave
Belle Ave to Front
Enter Phillips Ave Sewer

168.9 w. of Belle Ave. 6" p. December 22
1902 at 11 AM.

BY F. G. DE MELLO

From property of Leon Branchaud

Located Phillips Ave ss 158.2 w of Belle Ave

Account Misc. Ledger p 158

Belleville Ave

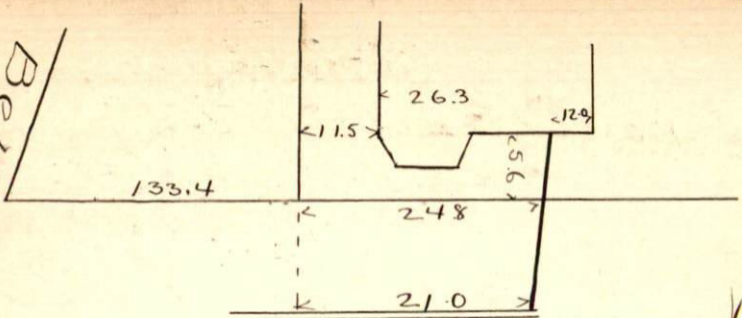

Phillips Ave

