

V
DRAIN

Wilson St.

Permit

No. 1630-1893

County to Corapo
Enter Wilson St. Sec 4

362⁸⁰ w of County (March 72) May 31,
1893 at 11⁴⁵ A.M. by John Gifford

From property of

Frank Sylvia

Located

Wilson ss 357⁰⁰ w of County

Account

Misc Ledger

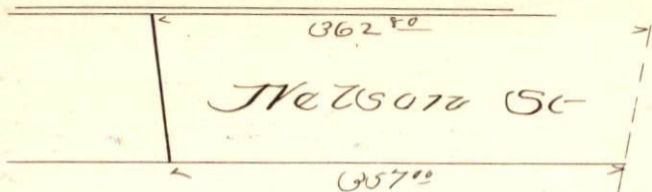

County SD