

DRAIN

Permit

No. 15544-49

PITMAN ST

ns.

W. of Shawmut Ave.

enters Pitman St. sewer

From Property of

Edward S. Glica

Located

Amount Misc. Ledger

$$20.1 \times 9.8 = \frac{8.49}{2}$$

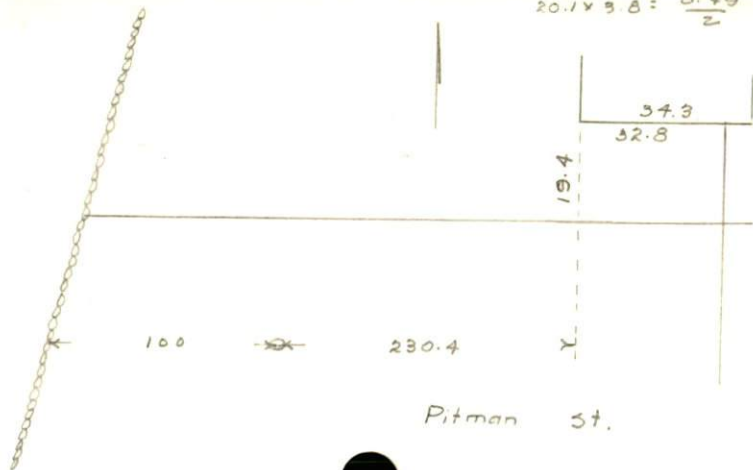

Shawmut Ave.

Pitman St.