

DRAIN

Permit

No. 14269-27

Hawthorn St.  
w. of Rockdale Ave.

enters Hawthorn St. Sewer.  
6" pipe.

Dec. 11, 1926

From Property of

Victor W. Smith.

Located

S. S.

Account Misc. Ledger

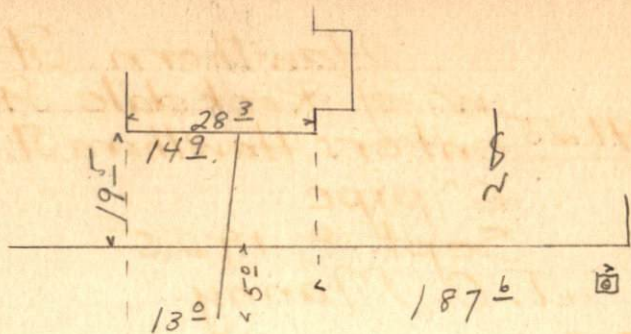

Hawthorn.

Brownell  
Ave.