

DRAIN

COUNTY ST

<sup>n.e.</sup>  
COR. OF KEMPTON

Permit  
No. 13455-25

ENTERS KEMPTON ST. SEWER  
6" PIPE

FEB 16, 1925

From Property of A.W. UENNESS.

Located

Account Misc. Ledger

County St.

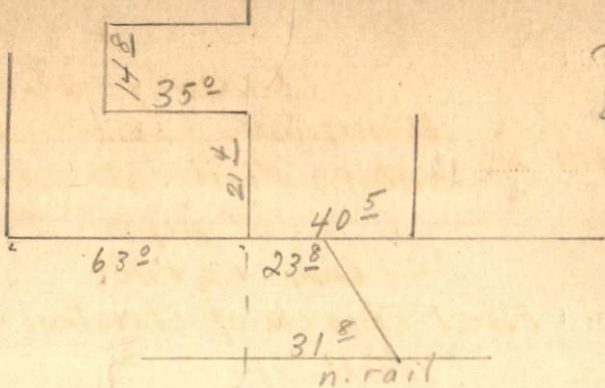

Kempton St.