

DRAIN

Permit 10591 }  
No. 10592 } 19

Sylvia St. ✓  
west of Belleville Ave  
enters Sylvia St. Sewer  
6" pipe

Oct. 27, 1919

From Property of

Oliva Robitaille

Located

s.s. Sylvia

Account Misc. Ledger

BY F O DANIELLO

Bellerive Av.

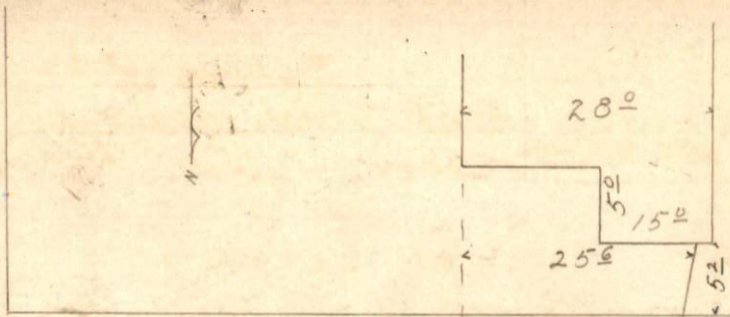

2036

Sylvia St.

23°

4" and 6"  
enter same  
trench