

APPLICATION No.: 7300

LOCATION: 49 Division St

OWNER:

31-313

MEASURES: 01/14/2019 Lead Service Line Replacement Program

Phase 1, Contractor P Gioioso & Son

Type CU, Diameter 1in, Water Pressure 90

1" Copper Service

Distance from main to curb stop (ft) 23

Distance from curb stop to meter (ft) N/A

Distance from curb face to curb stop (ft) 1.5

Depth of service (ft) 4

Total length of new pipe installed (ft) 23

Curb stop replaced: yes size 1"

Corporation replaced: yes size 1"

Ball valve furnished: no

TAP CLEARED

DATE _____

BEF.

AFT.

REMARKS

[illegible]

CHARGE OUTS

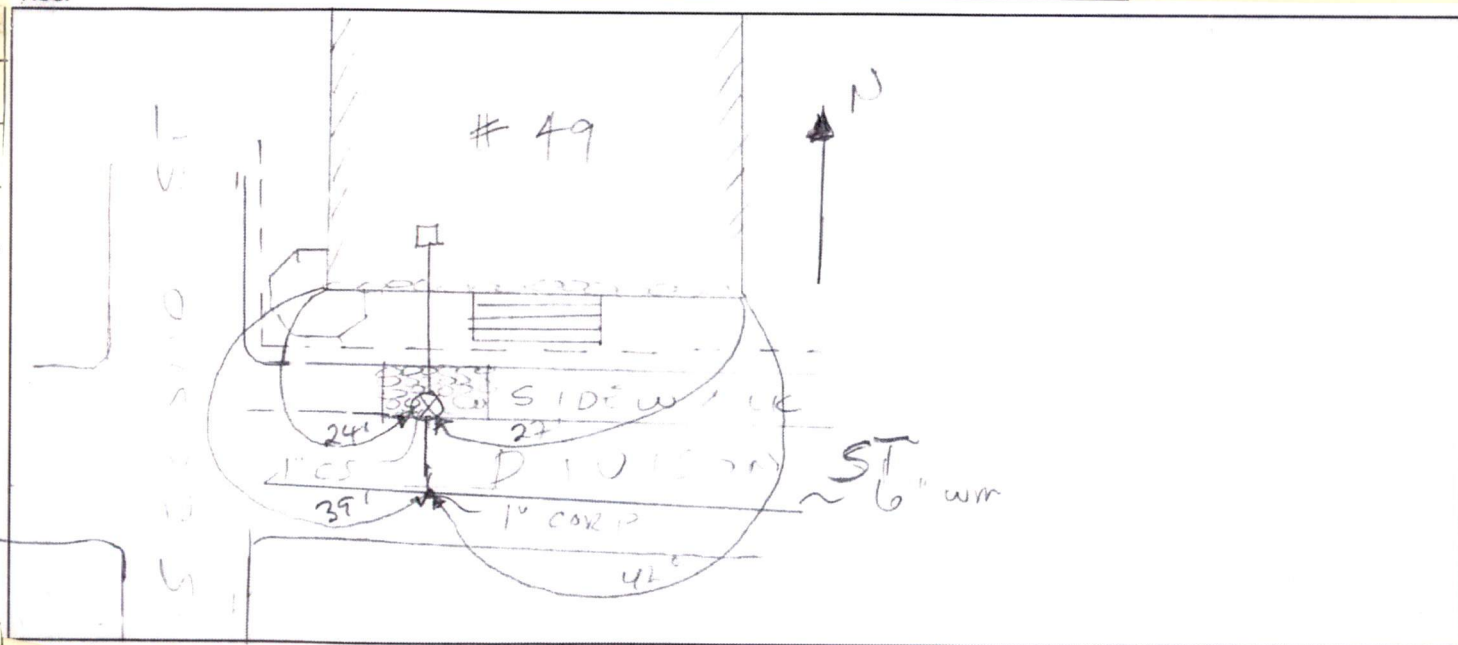

APPLICATION No.: 7300

TAP CLEARED

LOCATION: 49 Division St.OWNER: Joao I. CardosoMEASURES: $\frac{1}{2}$ " H lead Aug. 10, 1892

E from Second St. 18.2 ft.

S from N line Division St. 6.5 ft.

E from W line house 12.9 ft.

July 15, 1952 Renewed from curb stop to inside cellar
17 ft. of $\frac{3}{4}$ " copper tubing type K, soft

Alves

Mendes

Cambra

Frasier

Jan. 10. 1961 - Renewed from 1 ft. outside curb stop to curb stop
1 ft. of $\frac{3}{4}$ " copper tubing $\frac{3}{4}$ " copper stop, fig 415
 $\frac{3}{4}$ " cop. to cop. cplg., A-1525 1 lb. wiping solder

1/3/08 - Renewed from main to a point 2 ft
2 ft - $\frac{3}{4}$ " copper tubing; 1 - $\frac{5}{8}$ " x $\frac{3}{4}$ " lead to cop adapt xs;
1 - $\frac{5}{8}$ " x $\frac{3}{4}$ " Fig. 413. Tap reamed Foreman: D. Monty

DATE

BEF.

AFT.

REMARKS

1-3-08

10:00

Tap Reamed

Dig Safe
2008-0101873

[illegible]

CHARGE OUTS

[illegible]