

APPLICATION No.: 5530

TAP CLEARED

LOCATION: 68 County St

OWNER: ✓

31-313

MEASURES: 1" Copper Service

04/04/2019 - Lead Service Line Replacement Program

Phase 1, Contractor P Gioioso and Son

Type CU, Diameter (in) 1, Water Pressure 100

Distance from main to curb stop (ft) n/a

Distance from curb stop to meter (ft) 47.5

Distance from curb stop to curb face (ft) 4

Depth of service (ft) 4

Total length of new pipe installed (ft) 47.5

Curb stop replaced: NO, Corporation replaced: NO

Ball valve furnished: Yes, size 1"

DATE

BEF.

AFT.

REMARKS

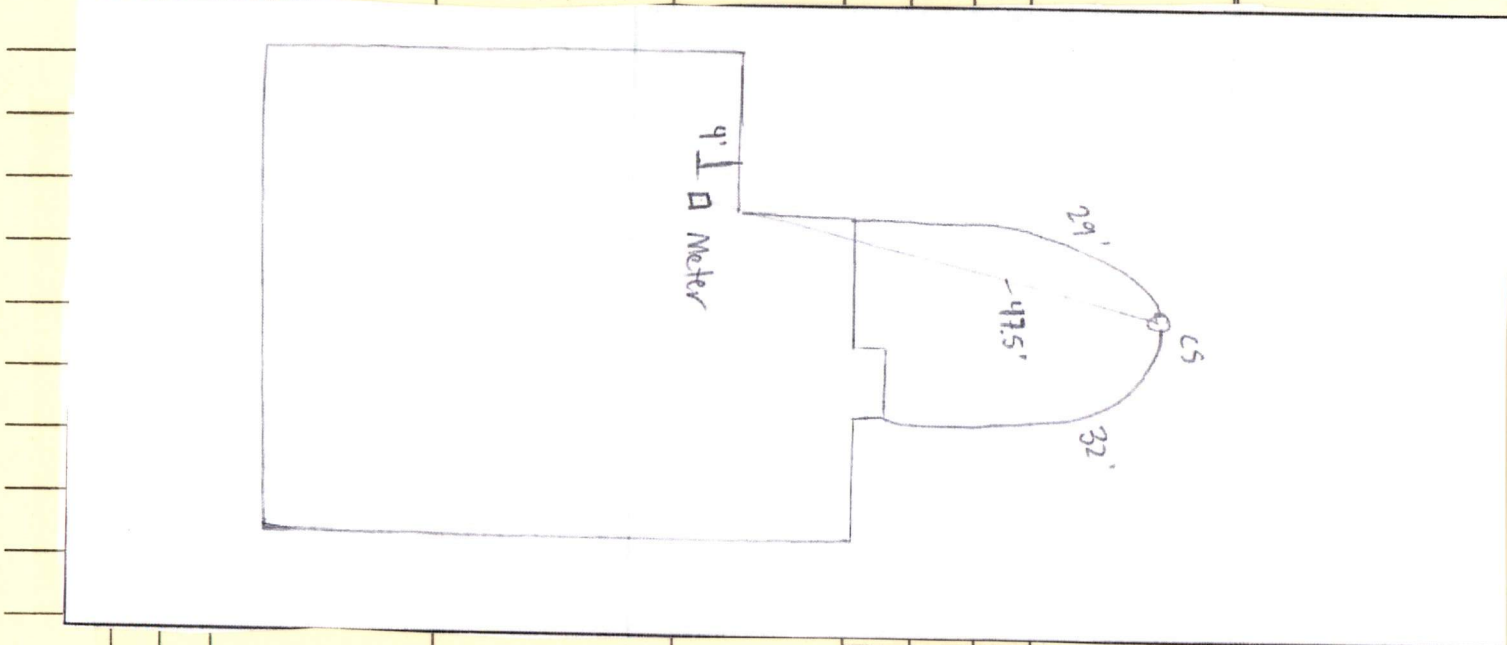
[illegible][illegible][illegible]

APPLICATION No. 5530 $\frac{1}{8}$ "

TAP CLEARED

LOCATION: 68 County St.

OWNER: Joseph A. Lammer

DATE

BEF.

AFT.

REMARKS

6/9/75

Reamed ✓

MEASURES: $\frac{1}{8}$ " N x N line Nelson St. 111.0 ft.~~S from~~ Division ~~251.0 ft.~~W from Eline County 2.5 ~~7.2 ft.~~N from S line Body of House 14.5 ~~0.8 ft.~~

June 2, 1975 Renewed from the main to a point 13 ft. east of the main.

13 ft. - $\frac{3}{4}$ " Copper tubing $\frac{3}{4}$ " x $\frac{3}{4}$ " Fig. 413 $\frac{5}{8}$ " x $\frac{3}{4}$ " lead to copper adaptor XS

- - -

June 9, 1975 Renewed from the main to the prop. line.

32 ft. - $\frac{3}{4}$ " Copper tubing $\frac{3}{4}$ " Curb Stop

1 wipe joint

(curb stop inside meter box)

 $\frac{3}{4}$ " x $\frac{3}{4}$ " Fig. 413 - - -

9/15/93: Renewed from curb stop to a point 2.1ft

✓ Stock: 2.1ft $\frac{3}{4}$ " copper tubing same curb stop1-Caldwell stop box 1- $\frac{3}{4}$ x $\frac{3}{4}$ cop-cop cplg.comp

=====

[illegible]

CHARGE OUTS

[illegible]