

APPLICATION No.: 21670

TAP CLEARED

LOCATION: 7 Bedford Place

OWNER: Muriel Brodd

MEASURES:	3/4"	Copper	July 30, 1936
	S from	Bedford St.	77.8 ft.
	E from E line	House	28.2 ft.
	S from N line	House	10.1 ft.

MEASURES OF 1 1/2' STOP 7/31/36
 E x Ash St. 84.0 ft.
 N x S line Bedford St. 6.0 ft.

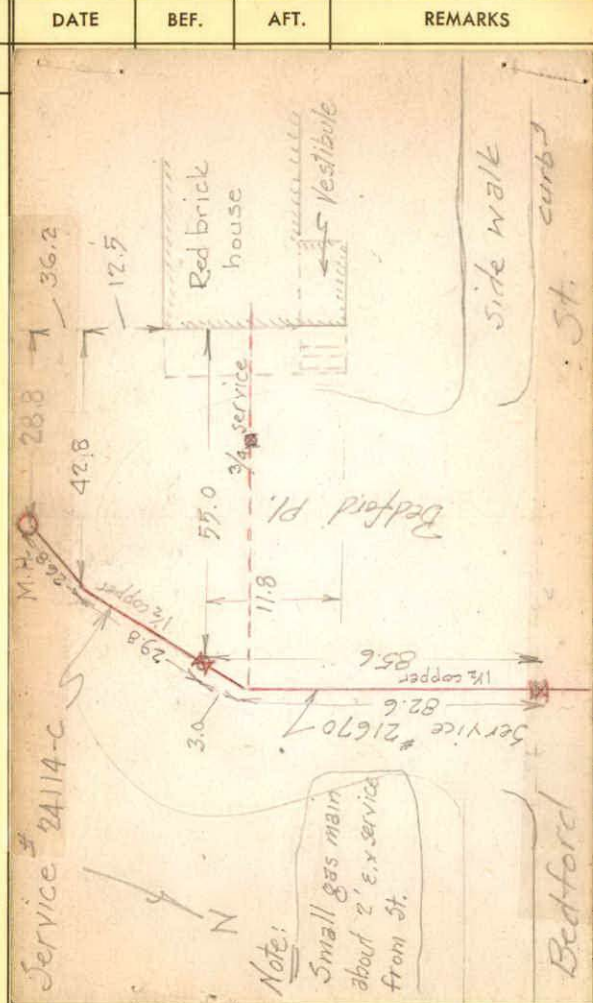

METER HISTORY

[illegible]

CHARGE OUTS