

APPLICATION No.: 21440 1" L lead

TAP CLEARED

LOCATION: 29 Middleboro Rd.

Box

DATE

BEF.

AFT.

REMARKS

OWNER: Kimball Harrison

MEASURES:

1"

L lead

June 2, 1930

S from Hyd. near Desmonds house

135.6 ft.

N from S line W.W. Engr's house

563.9 ft.

E from W line (stonewall) Middleboro Rd.

7.2 ft.

Stop is in meter box

232 ft. 1" L lead pipe

April 12, 1995 Checked in computer - this service is not a valid account.

[illegible]

CHARGE OUTS

[illegible]

21440

LOCATION:

31-313

S x Hydt.Near Desmond's House	135.6ft
N x S line Water Eng. ' s house	563.6ft
E x Weline Stonewall Middleboro Rd.	7.2ft

232ft 1in. l. lead

Service not in computer

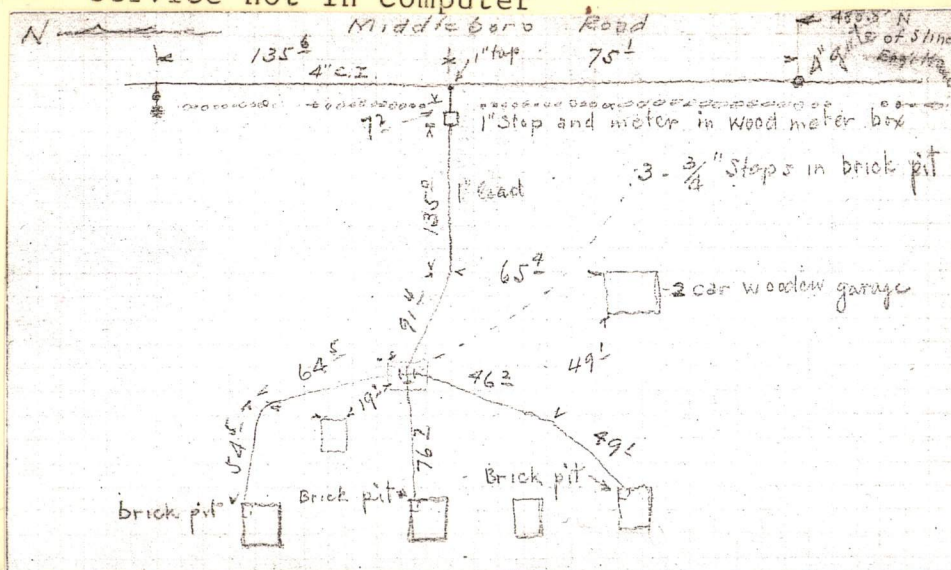

METER HISTORY

[illegible]

CHARGE OUTS