

175 HARWICH ST

APPLICATION No.: ~~20572~~ 20573

TAP CLEARED

LOCATION: ~~8-10~~ Plympton E.S., N. of Harwich

OWNER: A. Bouchard

MEASURES: 5/8"

E from	Plympton	32.8 ft.
S from N line	Harwich	8.6 ft.
W from E line	Corner House	25.8 ft.

6/29/07 Renewed from main to property line. Stock: 32 ft. 3/4"
copper tubing; 3/4" curb stop; Caldwell stop box; 3/4" lead-cop
adapt., XXS; 3/4" Fig. 413 Tap reamed Foreman: D Perry

NOTE: SEE ADDED INFO ATTACHED TO BACK OF CARD

- - - - -

DATE

BEF.

AFT.

REMARKS

[illegible]

CHARGE OUTS

[illegible]

- _____ Renewed from main to a point ft.
 _____ Renewed from main to curb stop.
 ✓ _____ Renewed from main to property line.
 _____ Renewed from main to inside cellar. (ft. ins. prop. line)

 _____ Renewed from ½' outside curb stop to a point ft.
 _____ Renewed from ½' outside curb stop to prop. line.
 _____ Renewed from ½' outside curb stop to ins. cellar. (ft. ins. prop. line)

STOCK:

- ✓ 32 ft. - ¾" Copper tubing
 ✓ 1 - ¾" Curb Stop
 ✓ 1 - Caldwell Stop Box
 ✓ 1 - XX OVERSIZED lead to cop. adapt. ¾"
 _____ - _____ cop to cop cplg., comp.
 ✓ 1 - ¾" Fig. 413
 _____ - " Corporation tap
 _____ - _____ Service Saddle
 ✓ ✓ - Tap Reamed

Active Service # 20573

ST. CUT: 5X15 ASPHALT
 SIDE. CUT: 12X5 GRASS

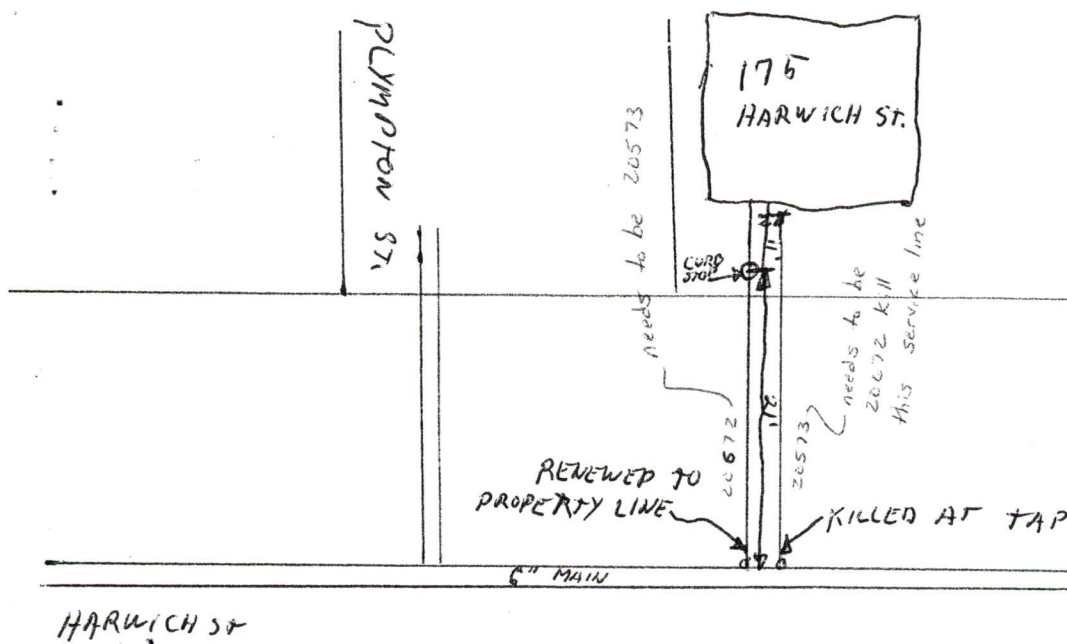

Killed service # 20672

Cliff - you need
 to swap acct. #'s
 on the plans
 + Cheryl needs to
 change measures
 on Cards.