

APPLICATION No.: 19199 5/8"

TAP CLEARED

LOCATION: 35-37 Clifford St. N.S. W. of Acushnet Ave.

OWNER: J. Stubbs

MEASURES: 5/8"

W from	Acushnet Ave.	336.3 ft.
S from N line	Clifford	9.8 ft.
E from W line	House	11.7 ft.

Aug. 9, 1977: Renewed from 6" outside curb stop to property line.
10 $\frac{1}{2}$ ft.-3/4" copper; curb stop; Caldwell stop box; 2 wipe joints

9/7/2021: Curb stop to meter renewed by RJ CANESSA
Inspector P. Reynolds

W x E Line 14'

S x S line house 18'

Main to property line 32'

Pipe inside property 11'

3/4" COPPER

1" Copper Service

08/29/2022 2022 Water main improvement program

Contractor: C. Naughton Corp.

Type CU Diameter 1"

Distance from main to curb 24.5'

Distance from curb stop to meter N/A

Distance curb face to curb stop 1.5'

Depth of Service 4.5'

Total length of new pipe installed 28'

Curb Stop replaced yes size 1"

Corporation replaced yes 1"

Ball Valve replaced yes N/A

Remarks: Type B -Connect to 3/4" Copper @ PL.

DATE

BEF.

AFT.

REMARKS

METER HISTORY

CHARGE OUTS

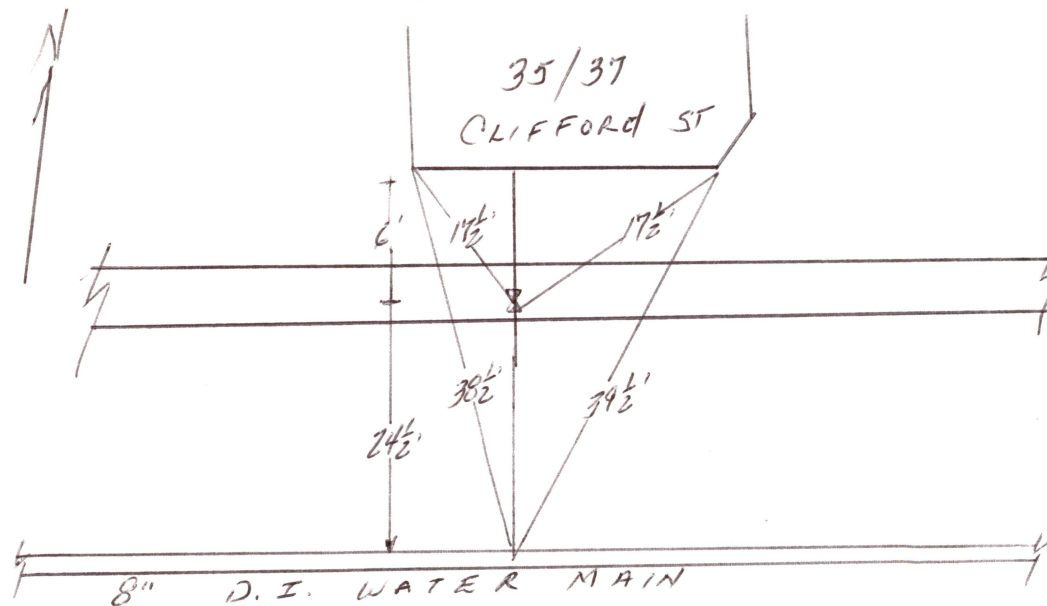
[illegible]

C L I F F O R D S t.

Record of Water Service Connection

PROJECT: 2022 Water Main Improvements Program New Bedford, MA

STREET: Clifford ST.

HOUSE No: 35 / 37

Contractor: C. Naughton Corp.

Date: 8-29-22

Type: CU

Diameter (in):

1

Distance from main to curb stop (ft):

24 1/2'

Distance curb stop to meter (ft):

-

Distance from curb face to curb stop (ft):

1 1/2'

Depth of Service (ft):

4 1/2'

Total length of new pipe installed (ft):

28'

Curb Stop Replaced: Yes

Size (in):

1

Corporation Replaced: Yes

Size (in):

1

Ball Valve Replaced:

Size (in):

Ties:

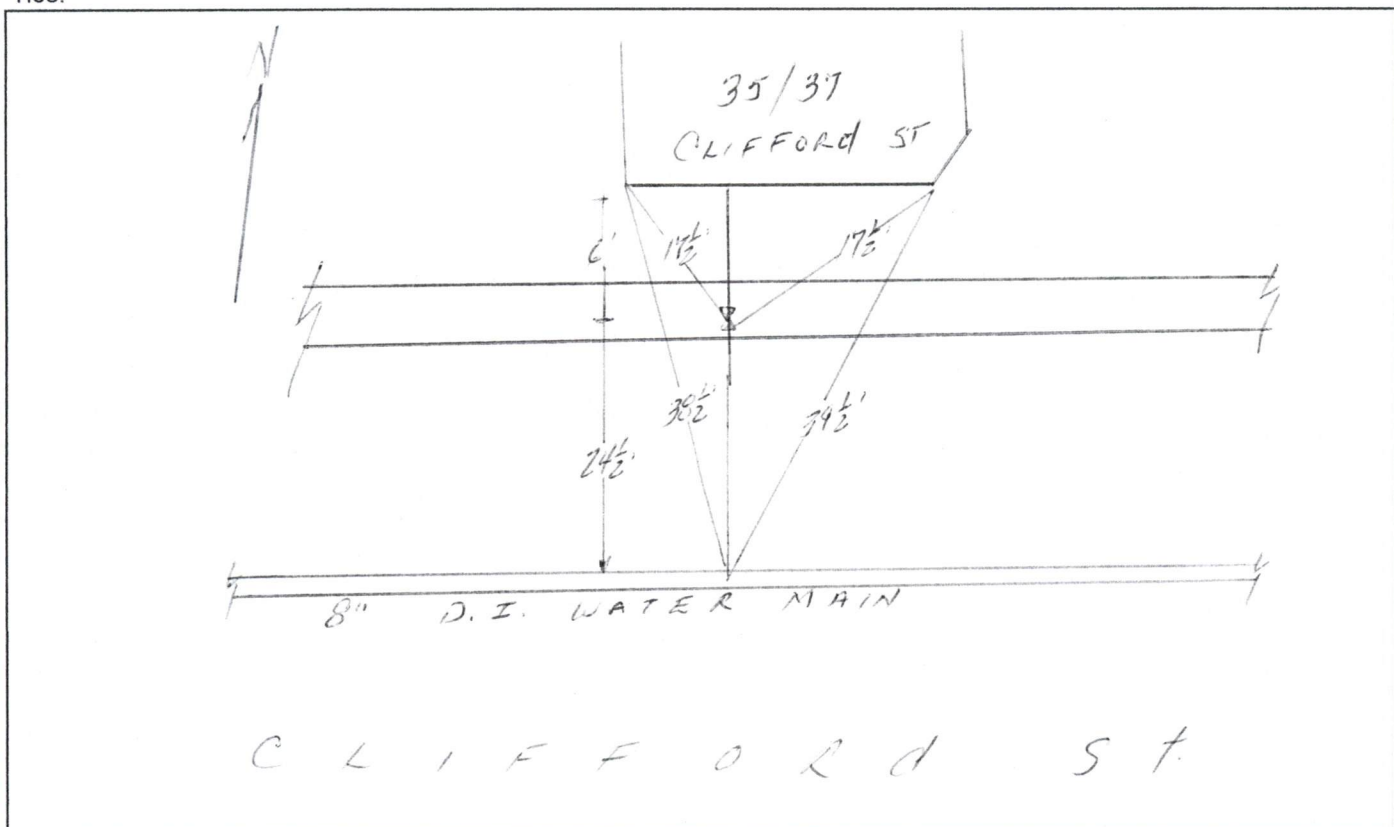

Remarks:

TYPE B - CONNECT TO 3/4" COPPER @ #2.