

APPLICATION No.: 19116

TAP CLEARED

LOCATION: 97 Clara St

OWNER:

31-313

## MEASURES:

09.03.2019-Lead Service Line Replacement - Phase 1

Contractor: P.Gioioso and Sons

Type:Cu, Diameter (in) 1, Water Pressure 100

Distance from main to curb stop (ft) 25

Distance curb stop to meter (ft) N/A

Distance from curb face to curb stop (ft) 1.5

Depth of Service (ft) 4.5

Total length of new pipe installed (ft) 25

Curb stop replaced: Yes, Size 1"

Corporation replaced: Yes, Size 1"

Ball Valve Furnished:No

DATE

BEF.

AFT.

REMARKS

# METER HISTORY

CHARGE OUTS

DATE	SET OUT	SIZE	MAKE	NUMBER	READING	TEST			REMARKS

FIG.

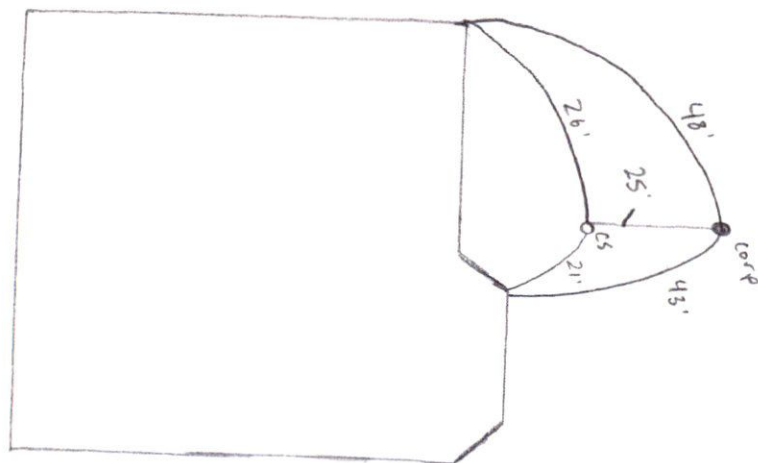

APPLICATION No.: 19116

TAP CLEARED 8227-1385

LOCATION: 97-9 Clara St.

OWNER: Bertha Swaye

MEASURES: 5/8" H lead Dec. 2, 1922

E from Cleveland St. 315.6 ft.

S from N line Clara St. 8.7 ft.

qW from E line house 11.6 ft.

JUL 13 1982 --Renewed 6" outside curb stop to 6 ft. in-  
 side curb stop. (property line) 6.6 ft. - 3/4" copper;  
 3/4" curb stop; stop box; 2- 5/8" x 3/4" lead-cop. adapt.

Sept. 19, 1994

- - - - -

Contractor renewed service from a point 4.5 ft.  
 north of the curb stop to the house.

Stock supplied in this order:

At point 4.5 ft. n x curb stop a 3/4" copper cplg.  
 3/4" copper tubing bends 90° westerly in sidewalk -  
 for 6 ft. where a 3/4" x 1" coupling is installed,  
 continues for 13 ft. before it bends 90° northerly  
 and runs along the west side of the house.

This work authorized by Mr. Hasey &amp; J. Garcia

DATE

BEF.

AFT.

REMARKS

XXS;

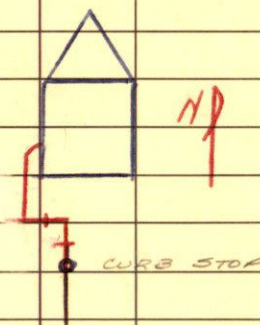



## METER HISTORY

## CHARGE OUTS

[illegible]