

APPLICATION No.: 17914 3/4"

TAP CLEARED 8252 0875

LOCATION: 64 Clifford St. S.S. E. of Concord St.

OWNER: J. Cabral

MEASURES: 3/4"

E from	Concord	49.3 ft.
N from S line	Clifford	9.3 ft.
E from Wline	House	3.4 ft.
Change over to 3/4" form curb to cellar		7/31/68

July 31, 1958 Renewed from 1/2' outside curb stop to inside cellar
23 1/2 ft. - 3/4" copper tubing used.9 1/2 ft. - 3/4" copper tubing from 1/2 ft. outside curb stop to
property line.

14'-3/4" copper tubing from property line to inside cellar.

1-3/4" curb stop. 1-wipe joint.

DEC 30 1982 --Renewed from main to the curb stop. 8.0 ft. -
3/4" copper; 3/4" curb stop; stop box; 5/8" x 3/4" lead-
cop. adapt. XS;

1" Copper Service

08/24/2022 2022 Water main improvement program

Contractor: C. Naughton Corp.

Type CU Diameter 1"

Distance from main to curb 9.5'

Distance from curb stop to meter N/A

Distance curb face to curb stop 1.5'

Depth of Service 4.5'

Total length of new pipe installed 17'

Curb Stop replaced yes size 1"

Corporation replaced yes 1"

Ball Valve replaced yes 1"

Remarks: Type B - Connect to existing 3/4" Copper @ PL.

DATE

BEF.

AFT.

REMARKS

METER HISTORY

CHARGE OUTS

DATE	SET OUT	SIZE	MAKE	NUMBER	READING	TEST			REMARKS
7/31/68		3/4	Rock Mag	19986298					

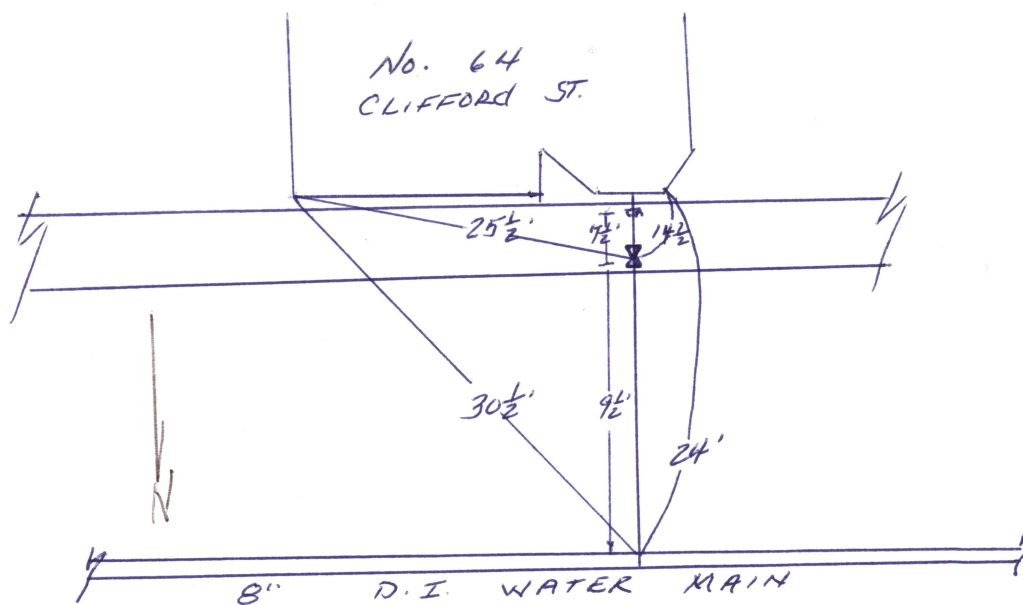

C L I F F O R D S T.

Record of Water Service Connection

PROJECT: 2022 Water Main Improvements Program New Bedford, MA

STREET: CLIFFORD ST.

HOUSE No: 64

Contractor: C. Naughton Corp.

Date: 8-24-02

Type: CU

Diameter (in):

1

Distance from main to curb stop (ft):

9.5'

Distance curb stop to meter (ft):

-

Distance from curb face to curb stop (ft):

1.5'

Depth of Service (ft):

4.5'

Total length of new pipe installed (ft):

17'

Curb Stop Replaced: Yes

Size (in):

1

Corporation Replaced: Yes

Size (in):

1

Ball Valve Replaced:

Size (in):

1

Ties:

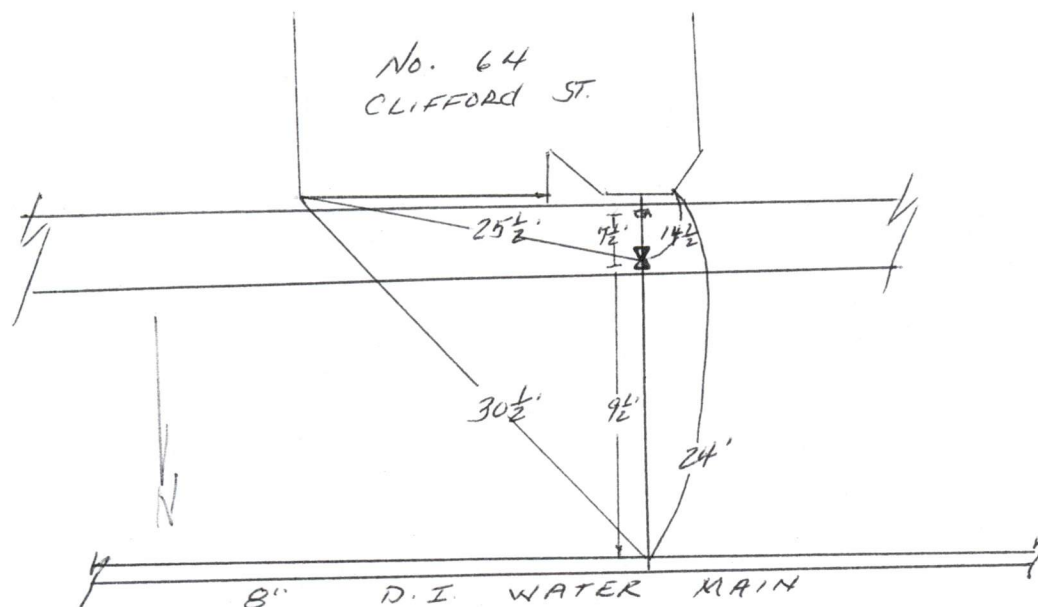

C L I F F O R D S T.

Remarks:

TYPE B - Connect to existing 3/4" Copper @ RD.