

APPLICATION No.: 16680

LOCATION:

OWNER:

31-313

Measures:

5/8"

E from

Concord

6'

S from N line

Clifford

8'

E from W line

House

4'

1" Copper Service

08/30/2022 2022 Water main improvement program

Contractor: C. Naughton Corp.

Type CU Diameter 1"

Distance from main to curb 24'

Distance from curb stop to meter 9'

Distance curb face to curb stop 1.5'

Depth of Service 4.5'

Total length of new pipe installed 33'

Curb Stop replaced yes size 1"

Corporation replaced yes 1"

Ball Valve replaced yes 1"

Remarks: Type C - 1" Copper to meter 7' Lead pipe removed.

TAP CLEARED

DATE _____

BEF.

AFT.

REMARKS

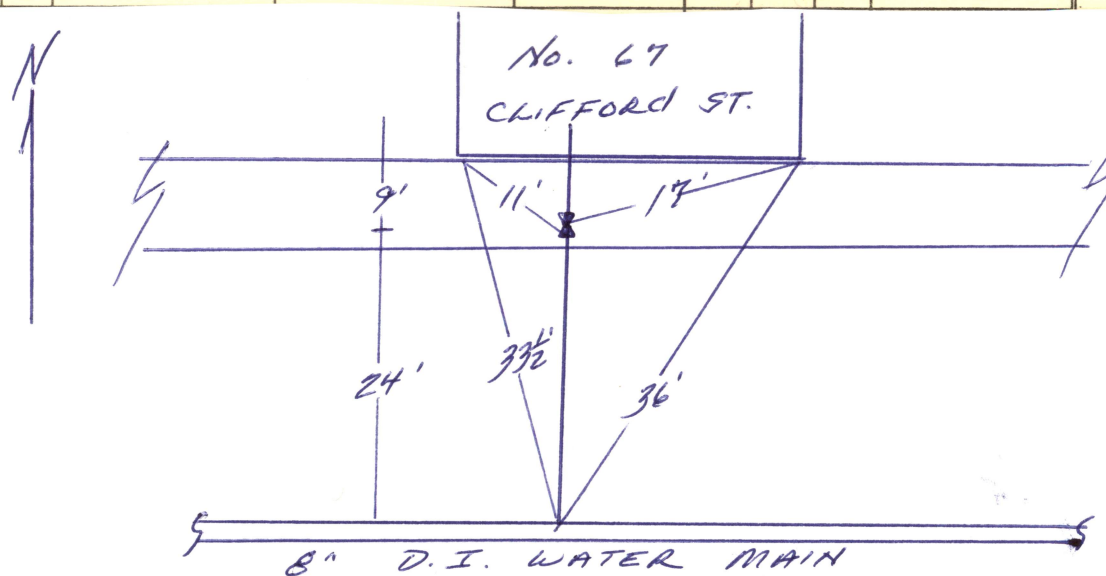
[illegible]

C L I F F O R D ST

Record of Water Service Connection

PROJECT: 2022 Water Main Improvements Program New Bedford, MA

STREET: CLIFFORD ST

HOUSE No: 67

Contractor: C. Naughton Corp.

Date: 8-30-22

Type: CU Diameter (in): 1

Distance from main to curb stop (ft): 24'

Distance curb stop to meter (ft): 9'

Distance from curb face to curb stop (ft): 1.5'

Depth of Service (ft): 4.5'

Total length of new pipe installed (ft): 33'

Curb Stop Replaced: Yes Size (in): 1

Corporation Replaced: Yes Size (in): 1

Ball Valve Replaced: Size (in): 1

Ties:

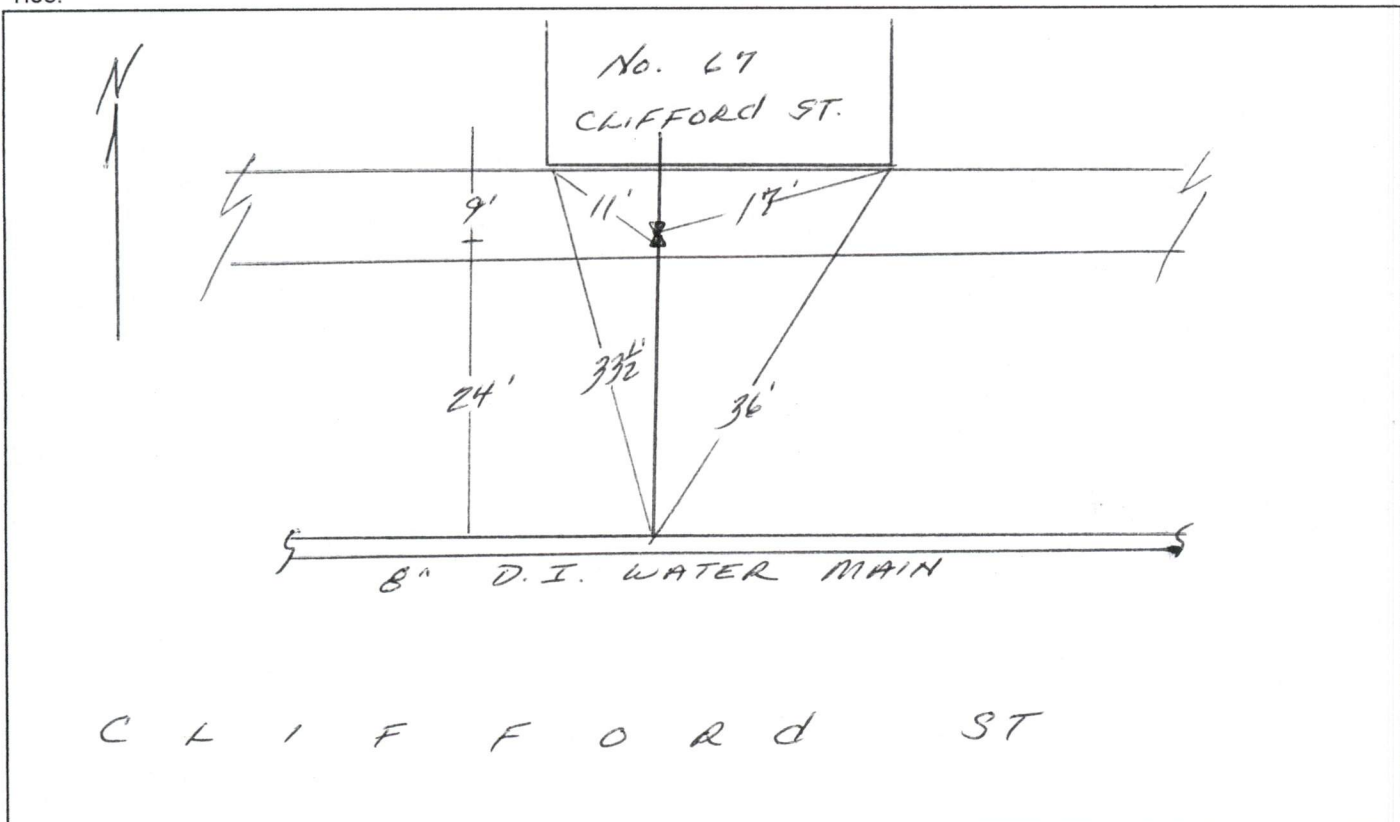

Remarks:

TYPE C - 1" Copper to meter 7' LEAD PIPE REMOVED