

14021
APPLICATION No.:

TAP CLEARED 8420-0758

LOCATION: 223 Belleville Rd

OWNER:

31-313

MEASURES:

May 3, 1954

W from Ashley Blvd 163.0'

S from N line Belleville Rd 8.3'

E from W line house 11.7'

1" COPPER

5-4-2018: Lead service line replacement program
phase 1, TYPE CU, Diameter 1, Water Pressure 60

Contractor: P. Gioiosio & sons

Distance from main to curb stop 23.0'

Distance curb stop to meter 18.0'

Distance from curb face to curb stop 2.0'

Depth of service 3.5'

Total length of new pipe installed 44.0'

Curb stop replaced: YES Size 1"

Corporation replaced: YES Size 1"

Ball Valve furnished: YES Size 1"

Remarks: 23.0' Corp to curb stop

17.0' curb stop to house

1.0' house to meter

3.0' whip

44.0' -- 1" copper installed

DATE

BEF.

AFT.

REMARKS

2/8/1954 reamed

METER HISTORY

DATE	SET OUT	SIZE	MAKE	NUMBER	READING	TEST			REMARKS

CHARGE OUTS

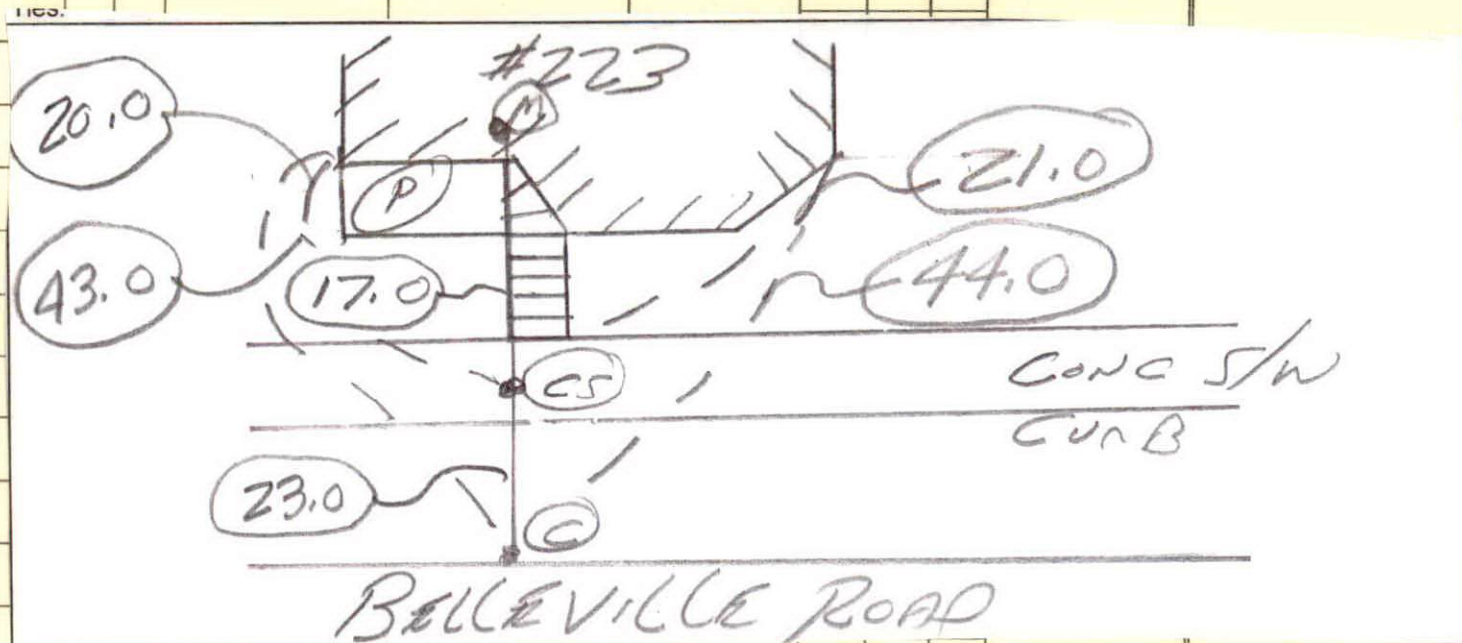

Remed