

APPLICATION No.: 13824 5/8"

TAP CLEARED 8804-171 ✓

LOCATION: 156 Clifford St.

OWNER: Ernest T. Silva

MEASURES: 5/8"

E from	Ashley Blvd.	259.2 ft.
N from S line	Clifford	9.0 ft.
E from W line	House	9.6 ft.

1/29/88 Renewed from 1/2' outside curb stop to ins. cellar
(7ft. ins. prop. line) 15ft-3/4" copper tubing, 1-3/4" curb stop
1-Caldwell stop box, 1-5/8x3/4 lead to cop adapt xs

1" Copper Service

09/12/2022 2022 Water main improvement program

Contractor: C. Naughton Corp.

Type CU Diameter 1"

Distance from main to curb 12.5'

Distance from curb stop to meter N/A

Distance curb face to curb stop 2'

Depth of Service 4'

Total length of new pipe installed 18.5'

Curb Stop replaced yes size 1"

Corporation replaced yes 1"

Ball Valve replaced yes N/A

Remarks: Type B- Connect to 3/4" Copper @ PL.

DATE

BEF.

AFT.

REMARKS

METER HISTORY

CHARGE OUTS

DATE	SET OUT	SIZE	MAKE	NUMBER	READING	TEST			REMARKS
3/11/43		5/8	King	192555					

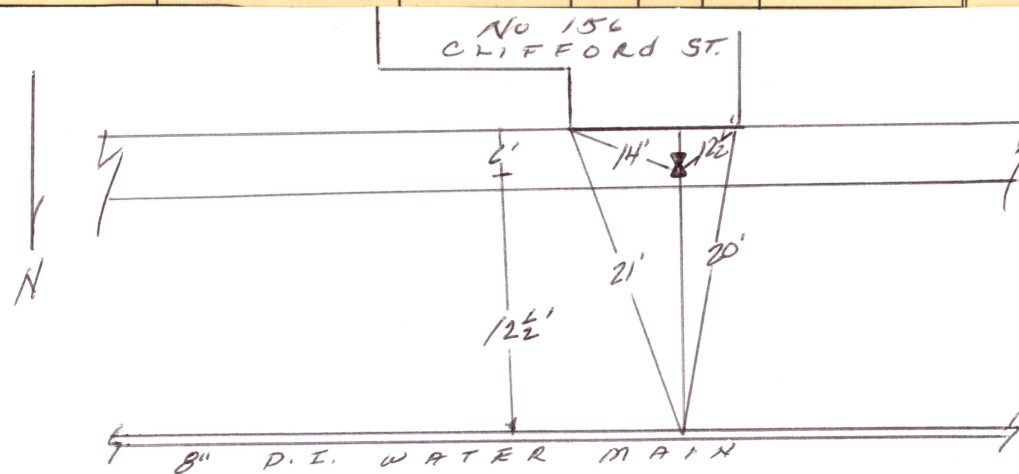

C L I F F O R D S T.