

APPLICATION No.: 13788

LOCATION: 103 CLIFFORD ST.

OWNER:

'31-313

1" Copper Service

08/31/2022 2022 Water main improvement program

Contractor: C. Naughton Corp.

Type CU Diameter 1"

Distance from main to curb 23.5'

Distance from curb stop to meter N/A

Distance curb face to curb stop 1.5'

Depth of Service 4.5'

Total length of new pipe installed 30.5'

Curb Stop replaced yes size 1"

Corporation replaced yes 1"

Ball Valve replaced yes N/A

Remarks: Type B - 3/4" Copper connection @ PL.

TAP CLEARED

DATE _____

BEF.

AFT.

REMARKS

METER HISTORY

CHARGE OUTS

DATE	SET OUT	SIZE	MAKE	NUMBER	READING	TEST			REMARKS

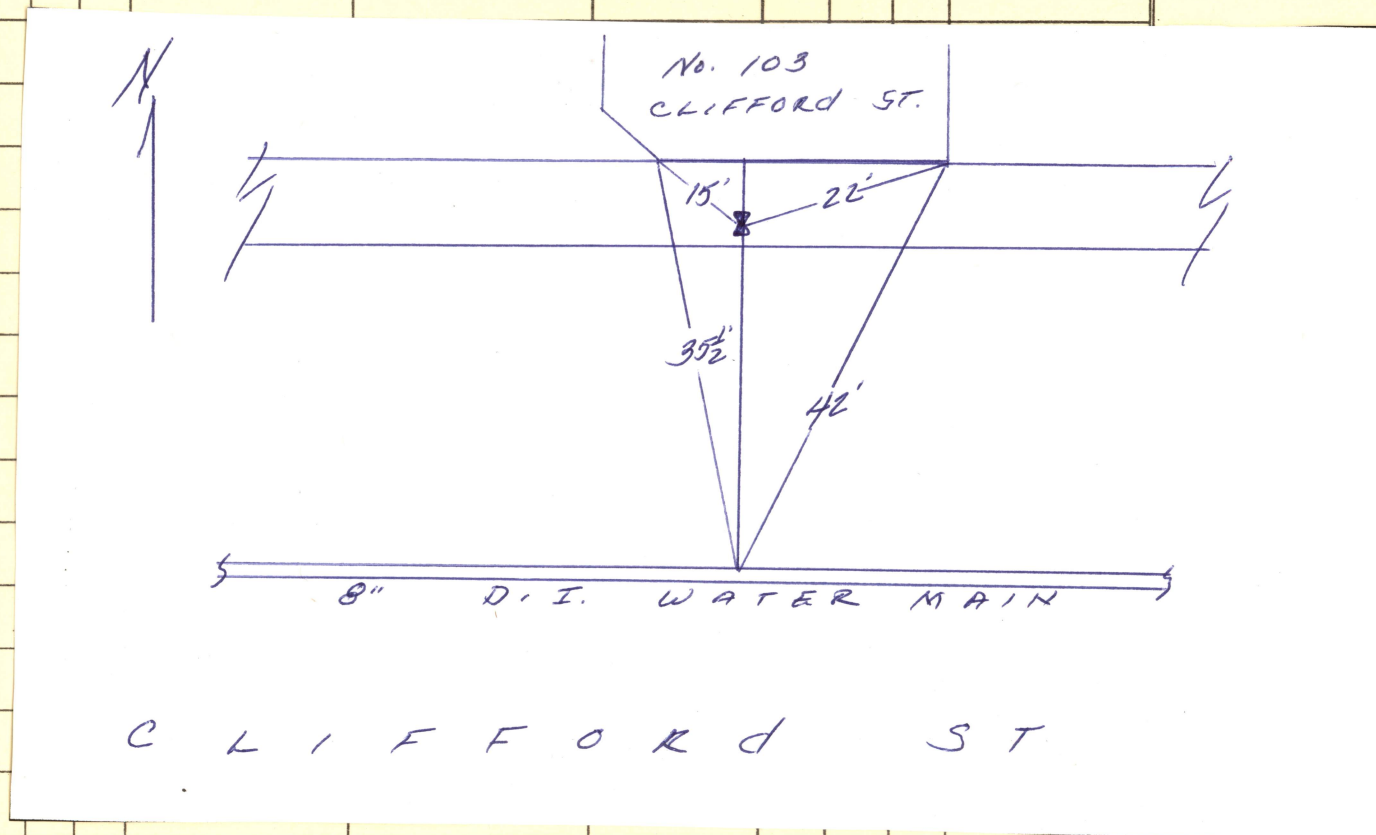

APPLICATION No.: 13788 3/4" L lead

TAP CLEARED

LOCATION: 103 Clifford St. N.S. E. of Arlington St.

OWNER: Bruno Charbonneau

MEASURES:	3/4"	L lead	Oct. 25, 1910
	E from	Arlington	264.0 ft.
	S from N line	Clifford	8.4 ft.
	E from W line	House	15.0 ft.

Aug. 3, 1962 Renewed from a point to 1 ft. outside curb stop to
curb stop. 1 ft. of 3/4" copper tubing
3/4" cop. to cop. stop, fig 415 1 lb. of wiping solder.

Aug. 1, 1962 Renewed from main to a point $\frac{1}{2}$ ft. from main.
3/4" Corporation cplg. (reused)
3/4" cop. to cop. cplg. A-1525

Feb. 27, 1953 Renewed from curb stop to inside cellar
15 ft. of 3/4" Copper tubing 1 lb. wiping solder

03/10/14 City crew renewed service from main to
curb stop
Stock: 23ft - 3/4" copper tubing; 1 - 3/4" curb stop;
1 - Caldwell stop box; 1 - 5/8"x3/4" FIG 413;
Tap reamed. J. Medeiros

DATE

BEF.

AFT.

REMARKS

METER HISTORY

[illegible]

CHARGE OUTS