

SERVICE 33560

NEW BEDFORD WATER WORKS

APPLICATION FOR SERVICE AND METER

NEW BEDFORD

10/14/09

I HEREBY ACKNOWLEDGE the receipt of a copy of the Regulations prescribed in the Ordinance of the City, for the use of Water, and I request that the water may be furnished through a

1" inch copper

meter at

1/2 Duplex

Braley Rd. (ES) 590' Sx Town Line (North Side of Bldg)

at such rates as may from time to time be established by the City.

I hereby agree to pay promptly the bill for the Service pipe laid down for my premises, and to pay all dues for water, and I agree to conform to the said Regulations and to all provisions of the Water Ordinances, until written notice is given by me or my agent to cut off the supply.

P. 137

L. 230

X Robert Schechter

Robert Schechter, Exodus R.T.

PO Box 2
Fall River, MA 02722

TELEPHONE 508-675-7773

cell 508-889-7065

Service laid

6/15/2009

Size and kind of pipe

1" copper

From

Braley Rd.

St.

Turned on

Meter Set

Reading

Location

Inside cellar stairwell

Building rates

Paid

Cost of Service

\$480.00

Paid

31-727

picked up 1" meter blank 3/26/10

Braley Rd. (ES) 590' S x Town Line (North Side) Service # 33560

(Lot 230)

Measures to 1" Curb Stop

| | |
|-------------------------------|----------|
| N x hydrant # 5-0111 | 41.0 ft. |
| W x E line Braley Rd. | 8.0 ft. |
| N x N line of House | 7.5 ft. |
| N x S line of House | 47.6 ft. |
| W x W line House | 29.6 ft. |
| Bldg to edge of pavement | 38.0 ft. |
| Edge of Pavement to curb stop | 8.0 ft. |

| | |
|-----------------------|----------|
| Main to Property Line | 43.0 ft. |
| Pipe Inside Property | 30.0 ft. |

NOTE: This service comes off of #30944
and this service has a coupline 25.0 ft from
curb stop.

Work done: June 15, 2009

| | |
|-----------------|-----------------|
| Application Fee | \$ 350.00 |
| Inspection | \$ 70.00 |
| Couplings | \$ 30.00 |
| Turn on charge | <u>\$ 30.00</u> |
| | \$ 480.00 |

Owner: *Robert Schechter, Exodus Realty Trust*

Contractor: *W.C. Smith & Son*

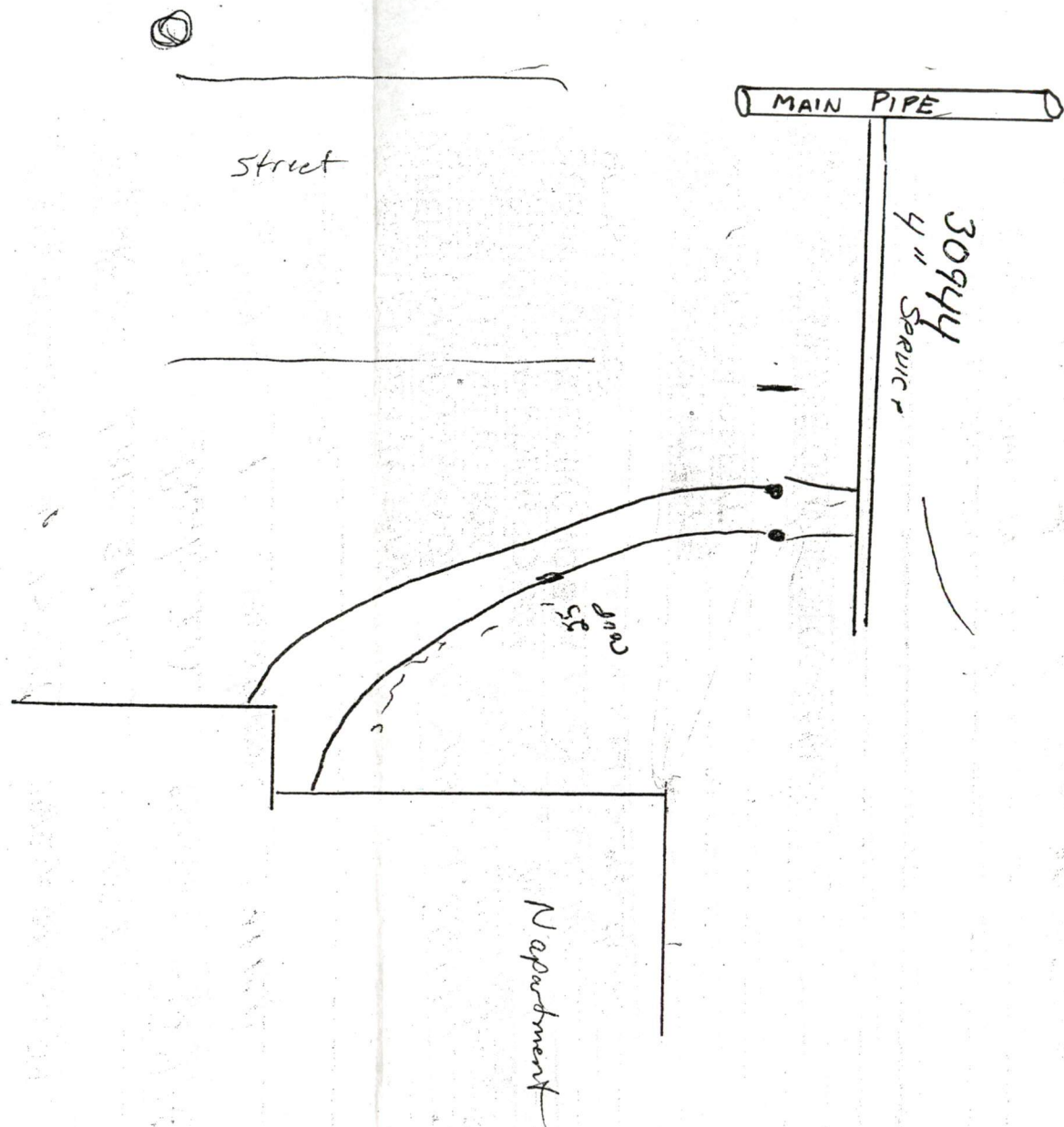

1911

1912

1913

1914

1915

1916