

SERVICE 33545-FS

NEW BEDFORD WATER WORKS  
APPLICATION FOR SERVICE AND METER

NEW BEDFORD

9-1-09

I HEREBY ACKNOWLEDGE the receipt of a copy of the Regulations prescribed in the Ordinance of the City, for the use of Water, and I request that the water may be furnished through a

10" inch Fire Supply meter at Commercial Building.  
Silva St - cul-de-sac - 310' S x Blackmer St.

at such rates as may from time to time be established by the City.

I hereby agree to pay promptly the bill for the Service pipe laid down for my premises, and to pay all dues for water, and I agree to conform to the said Regulations and to all provisions of the Water Ordinances, until written notice is given by me or my agent to cut off the supply.

Sewer Permit # 24141

P 25 A

L 45

MARV P. COTE

MPC

136 RIVER RD. NEW BEDFORD, MA.

TELEPHONE 508 998-8466

Service laid

10/27/2009

Size and kind of pipe

10" D.I

From

St.

Turned on

Meter Set

Reading

Location

Building rates

Paid

Cost of Service

\$ 450.00

Paid

31-727

Silva St. (NE lot on cul-de-sac) Service # 33545  
310' S x Blackmer St. (Lot 45)

**Measures to 10" Gate Valve**

S x S line Blackmer St.	239.0 ft.
S x N line prop line (cul-de-sac)	20.0 ft.
N x N line Building	9.5 ft.
W x W line Building	31.0 ft.
 Pipe Inside Property	 70.1 ft.

Notes: Tapped in right of way – easement  
Bldg to main – W x W line Building 33.0 ft.

Work done: October 27, 2009

Application Fee	\$350.00
Inspection	\$ 70.00
Couplings	\$ 0.00
Turn on charge	<u>\$ 30.00</u>
	\$ 450.00

**Owner:** Mark P. Cote, on behalf of  
Robert Gardner

**Contractor:** Menard Brothers

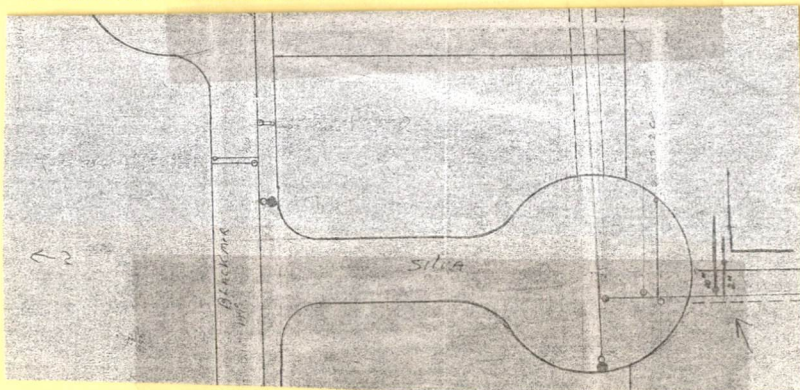



# CITY OF NEW BEDFORD MASSACHUSETTS

D.P.I. -Engineering Division

1105 Shawmut Ave.

New Bedford, Ma. 02746

Tel: 508-991-6150

Fax: 508-991-6152

Ronald Labelle  
Commissioner

Duarte M. Andrade  
Acting City Engineer

# 033544A + # 033545A

To Whom It May Concern:

I ROBERT GARDOVAR 109 GIFFORD ST. NEW BEDFORD, MA. being  
(Name) (Mailing Address)

Owner of property located at 66 SILVA ST (CHL DE SAC)

Plot 25A, Lot 45, hereby agree to allow MARK COTE  
(Name)

136 RIVER RD NEW BEDFORD, MA. to act on my behalf including affixing my  
(Mailing Address)

signature in securing permit for:

- ☒ Sewer/Drain Service Permits
- ☒ Water Service Permits
- ☐ Driveway Installation Permits
- ☐ Sidewalk Installation Permits

I further agree to conform to, and abide by, All City rules and ask regulations applicable to the permit (s) being applied for:

Name

Signature

Address

9/1/09

508-994-2944