

Tel. 995-6154

1938 Acushnet Ave.

July 11, 1979

127D

#29794

Roland Gendron

S.S. Adelaide St., E. x Metcalf St.

Please install 1" copper service to supply
1 family home. Tap main at inter. Adelaide &
Metcalf Sts. Service from Metcalf St. Meter
inside cellar wall.

Measures of 1" Curb Stop:

E x E line Metcalf St.

56.8 ft.

N x S line Adelaide St.

6.5 ft.

W x E line House

4.3 ft.

N x N line House

24.4 ft.

~~Main is~~

Work done July 24, 1979

113 ft. - 1" Copper tubing by Owner
(90' out: 23' ins.)

Labor.	\$	145.54
1" Corporation	\$	12.06
1" Curb Stop	\$	28.42
1 Caldwell Stop Box, compl	\$	16.75
Carting.	\$	10.00
B-100 Mueller Tapping Machine use.	\$	14.00
2 1" Meter cpls. @ 2.50 ea.	\$	5.00
Loader use: 3 hrs. @ 7.00 hr.. . . .	\$	21.00
Compressor use: 1 hr.. . . .	\$	6.00
St. cut: 22' x 3' Warrenite @ 5.--SY		36.65
Side. cut: 90' x 3' Dirt.	\$	N/C
Turn on charge.	\$	5.00
	\$	<hr/> 300.42

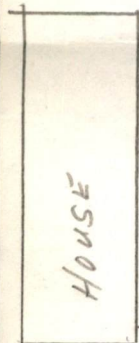

PROPERTY LINE

Adelaide

TAP 2015

1" COPPER

72'

18 FT

6" WATER MAIN

Adelaide St

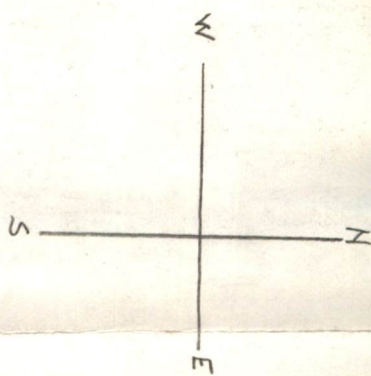

and each of us, our heirs, executors, administrators, successors and assigns, jointly and severally firmly by these presents.

Whereas the principal has by means of a written agreement dated _____ entered into a Contract with the said City for _____ a copy of which agreement is attached hereto and by reference made a part hereof.

NOW THEREFORE, the condition of this obligation is such that if the principal should faithfully perform the Contract on his part, and shall keep and perform all the covenants, conditions and agreements therein contained and on his part to be kept and performed, shall satisfy all claims and demands incurred under the same, and shall fully indemnify and save harmless the City of New Bedford