

3 fam.
7 fcts.
3 wets.
3 bts.
METER.

154 Phillips Ave.

NEW BEDFORD WATER WORKS.

SERVICE PIPE RETURN.

No. **11622**

For **Arsene Roberge,**

No. **N. side Webster Ct. E. of N. Front**

Street.

The expense for labor and materials to be paid by the applicant is as follows:

19 - 18

.....	lineal feet of earth excavated at	cents per foot,	.		
.....	lineal feet of rock excavated at	cents per foot,	.		
14	lineal feet of 3/4H inch lead pipe at 33	cents per foot,	.	4	62
74	lineal feet of 5/8H inch ^{Lead} iron pipe at 25	cents per foot,	.	18	50
.....	lineal feet of	inch tin lined pipe at	cents per foot		
	Labor \$ 11.03 ; 2 lbs. solder @ 30¢ = 60¢			11	63
Taps Nash Road main. 3/4 in. Pipe from Nash Rd. main south 32 feet. Join pipe from this point south through lot to house on Webster Court.					
	Proportion of other expenses for putting services into premises .			2	00
	Amount, \$			36	75 R

Office of Superintendent,

January 5th, 1907.

R. B. P. Baggeshall Superintendent.

WATER REGISTRAR'S OFFICE.

December 4th, 1906.

To the Superintendent of the New Bedford Water Works :

Please put in a Service upon the premises described above, and make return of the expense of the same to this office.

C. Baylis

Water Registrar.

By **A. M. Hamilton**

154 Phillips Ave.

154
153
152
151
150
149
148
147
146
145
144
143
142
141
140
139
138
137
136
135
134
133
132
131
130
129
128
127
126
125
124
123
122
121
120
119
118
117
116
115
114
113
112
111
110
109
108
107
106
105
104
103
102
101
100
99
98
97
96
95
94
93
92
91
90
89
88
87
86
85
84
83
82
81
80
79
78
77
76
75
74
73
72
71
70
69
68
67
66
65
64
63
62
61
60
59
58
57
56
55
54
53
52
51
50
49
48
47
46
45
44
43
42
41
40
39
38
37
36
35
34
33
32
31
30
29
28
27
26
25
24
23
22
21
20
19
18
17
16
15
14
13
12
11
10
9
8
7
6
5
4
3
2
1

Aracne Roberts.

N. side Webster Ct. E. of N. Front

#11622
N. F. Webster Ct., E. of No. Street
Aracne Roberts

6

December 4th.

Front St.

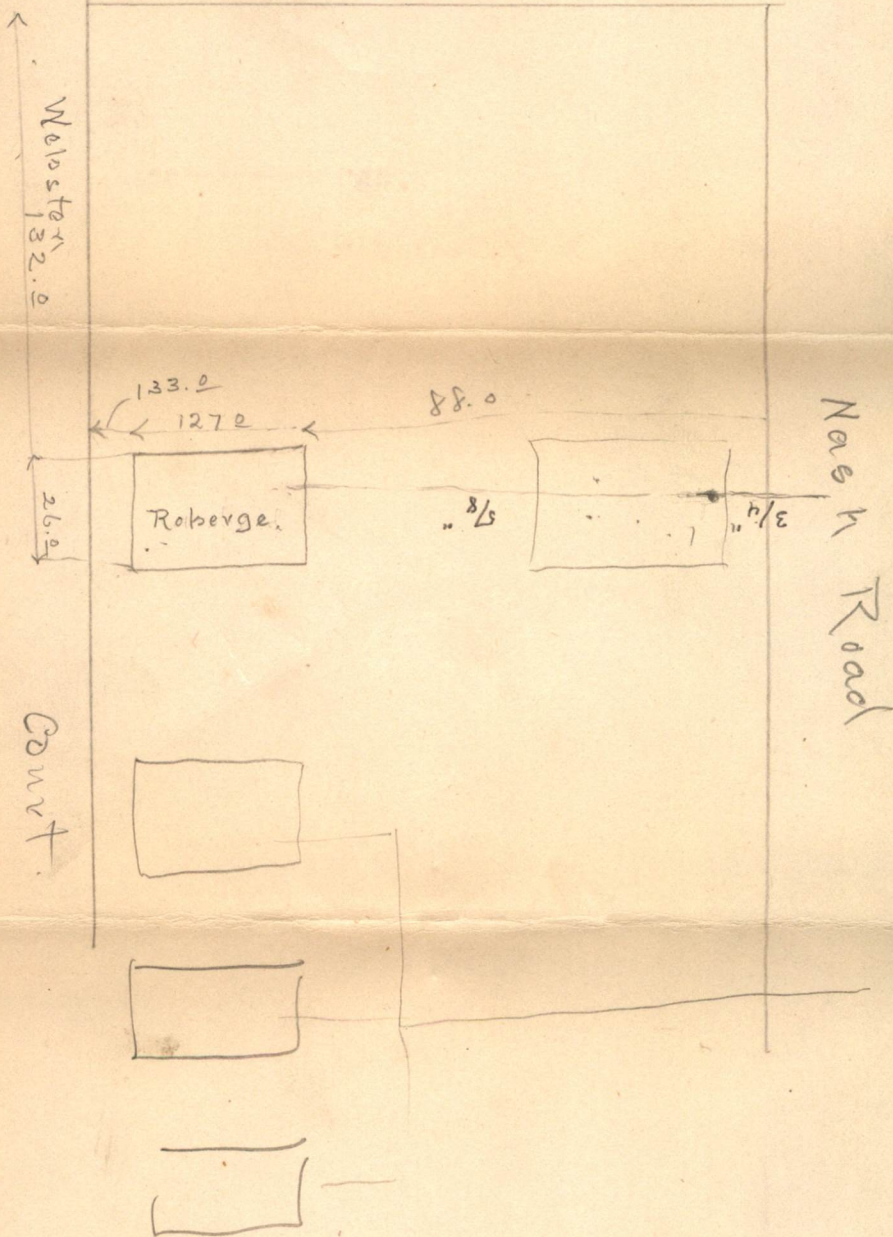

Archie Roberts,

W. and Webster Co. R. of N. Front

with rounded