

New Bedford Regulator Specification Sheet

Regulator #: R-030A

Location: Potomska St. at S. Second St.

Date: 6/25/25

Structure Measurements

Structure Type: Multichamber (3)

Rim Elevation (ft City Datum): 7.2

Regulator Type: Stop Plank Weir

Overflow Height (ft or in): 2.2'-2.4'

Rim to Top of Weir (ft): 4.3' - 4.5'

Weir Dims (ft or in): Stop Plank Length: 2.5', Stop Plank

Width: 3-5", Height: 2.2'-2.4' above inlet elevation

Influent pipe ø (in): 30

Rim to Influent Invert (ft): 6.7

Dry Weather Connection ø (in): 20

Rim to Dry Weather Invert (ft): 6.7

Overflow pipe ø (in): 30

Rim to Overflow Invert (ft): n/a

Sensor Measurements

Block Present: Missing

Level Sensor Status: Metered

Sensor Installation Date: 7/25/2022

Intra-System Status: No

Tide Gate Status: Gate gone

Notes: Measurements and dimensions from Redzone scan and record drawing A-8181 on Potomska St Siphon. Weir and overflow dimensions were taken from record drawings since the 2023 Redzone scan did not reach far enough. Tide gate is gone. The block was missing during 3/21/25 inspection. There is a large buildup of debris in front of the weir, see Figure 2.

Location Sketch:

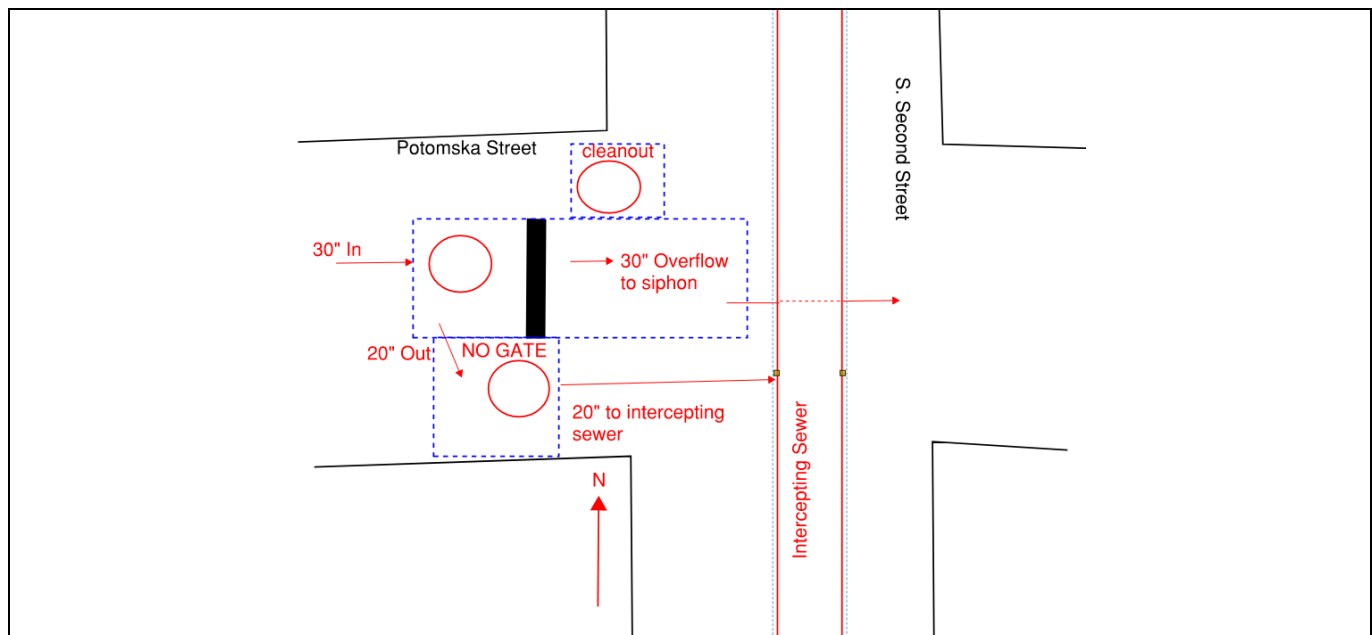

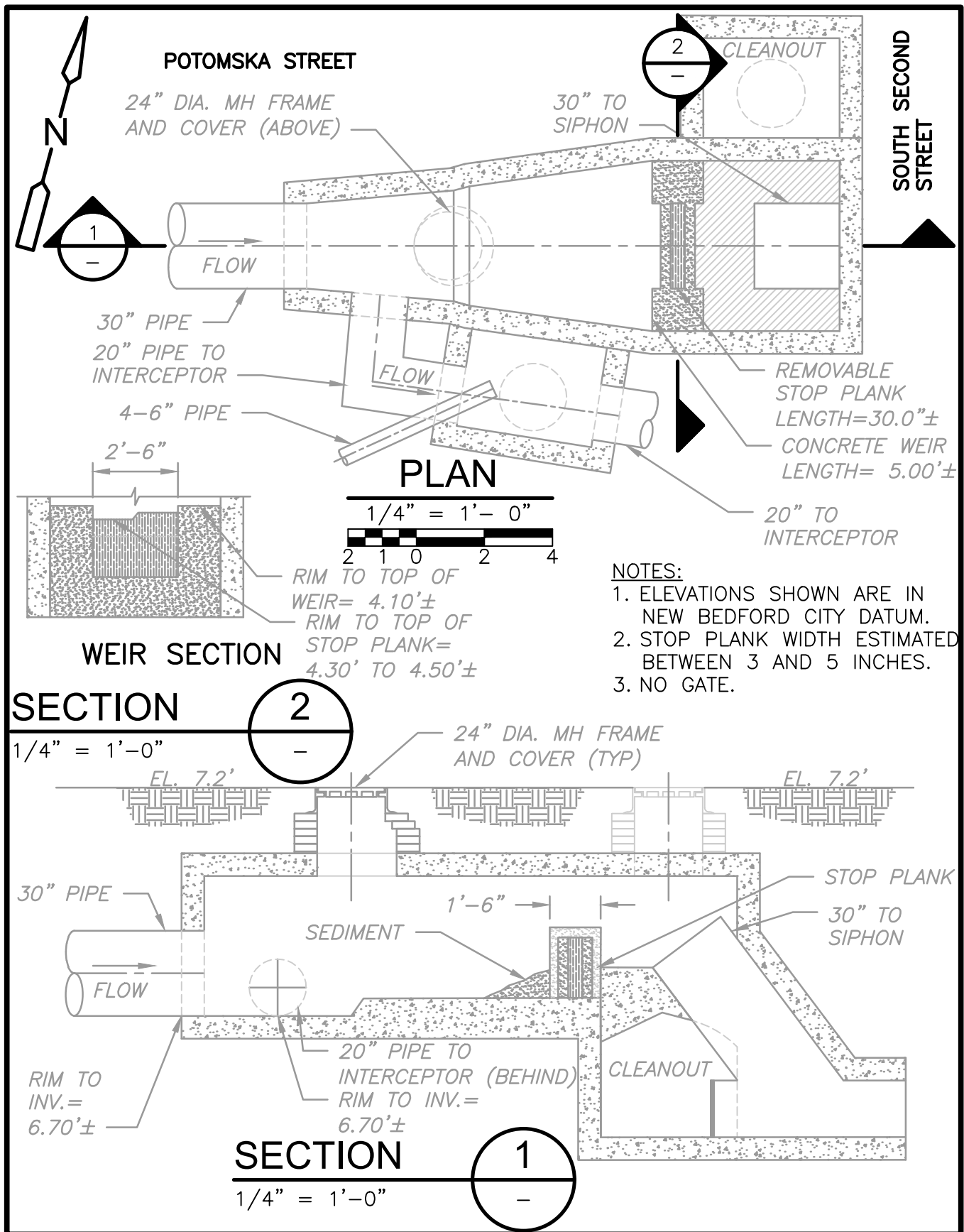

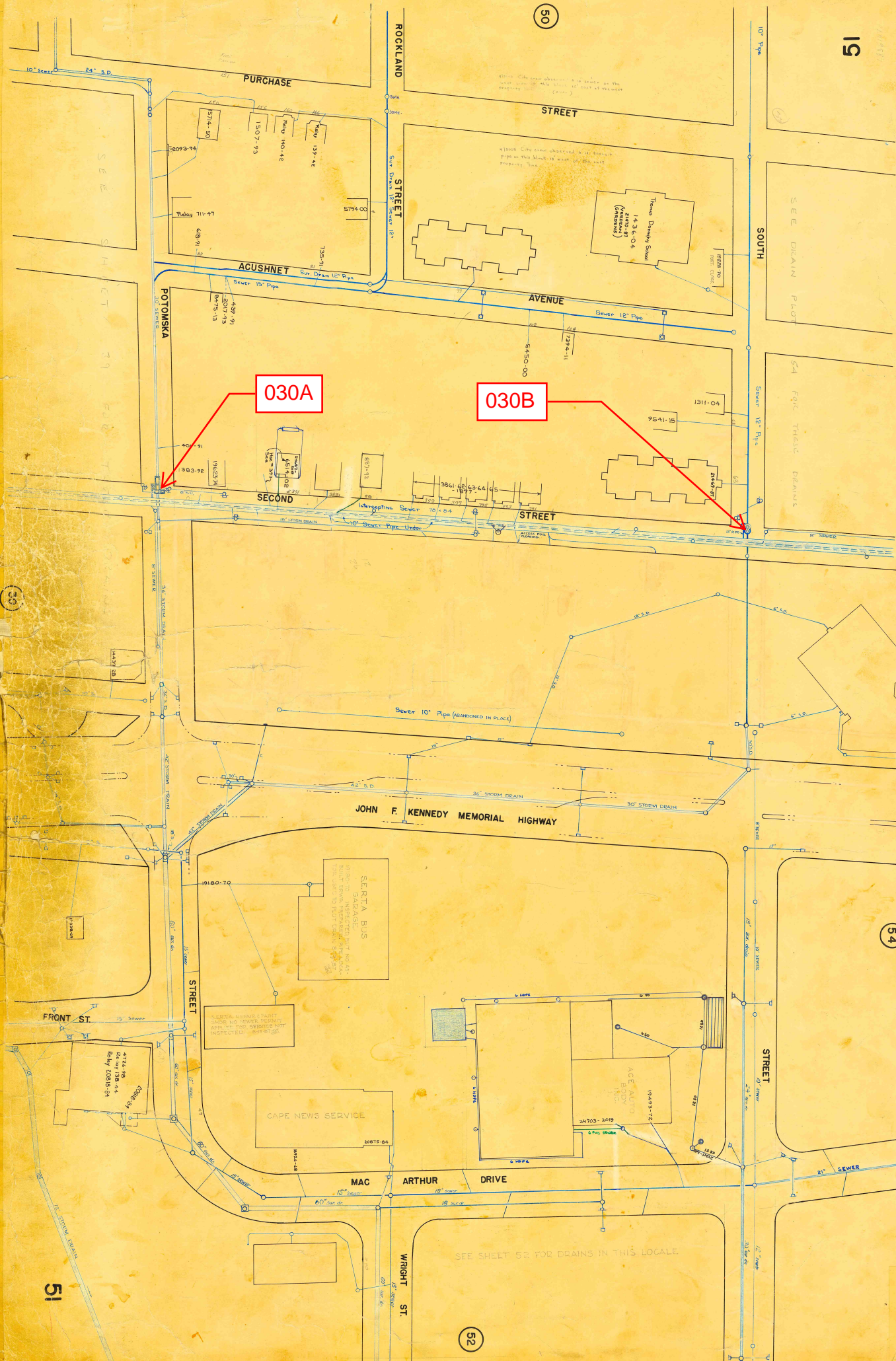

030A

030B

REGULATOR FIELD PHOTOS

Figure 1



Figure 2



Figure 3



Figure 4



Descriptions:

Figure 1: Inside of R-030A. Inflow, outflow and step with block shown.

Figure 2: Inside of R-030A. Weir and build up of sediment shown.

Figure 3: Location of manhole. facing east down Potomska Street.

Figure 4: Aerial location with arrow pointing to corresponding manhole.