

# New Bedford Regulator Specification Sheet

**Regulator #:** R-018B

**Location:** Cove St. near Cleveland St.

**Date:** 6/25/25

## Structure Measurements

**Structure Type:** Single manhole

**Rim Elevation (ft City Datum):** 4.5

**Regulator Type:** Fixed Weir

**Overflow Height (ft or in):** 0.8'

**Rim to Top of Weir (ft):** 5.3'

**Weir Dims (ft or in):** Length: 1.5', Height: 0.8'

**Influent pipe ø (in):** 18

**Rim to Influent Invert (ft):** 6.1

**Dry Weather Connection ø (in):** 15

**Rim to Dry Weather Invert (ft):** 6.1

**Overflow pipe ø (in):** 18

**Rim to Overflow Invert (ft):** 6.2

## Sensor Measurements

**Block Present:** Yes

**Level Sensor Status:** Metered

**Sensor Installation Date:** 10/20/2020

**Intra-System Status:** Yes

**Tide Gate Status:** Duckbill in R-018A

**Notes:**

**Location Sketch:**

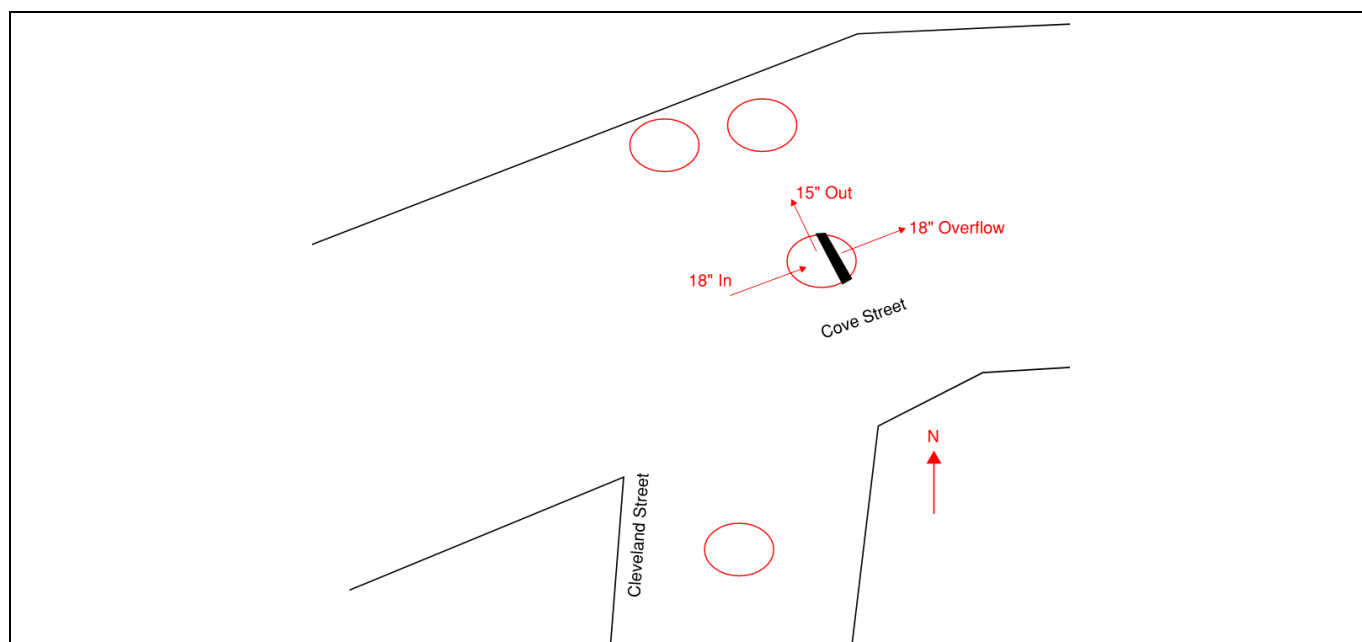

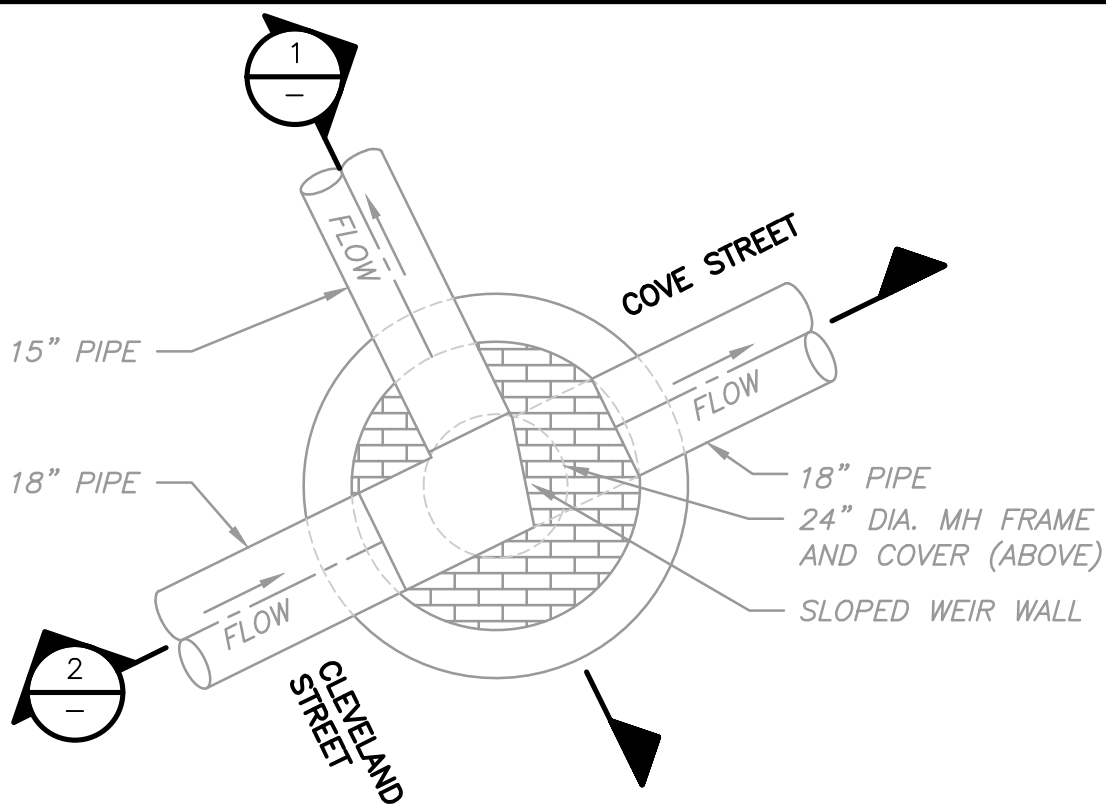

# PLAN

$$3/8'' = 1'-0''$$

NOTE:

ELEVATIONS SHOWN ARE IN  
NEW BEDFORD CITY DATUM.

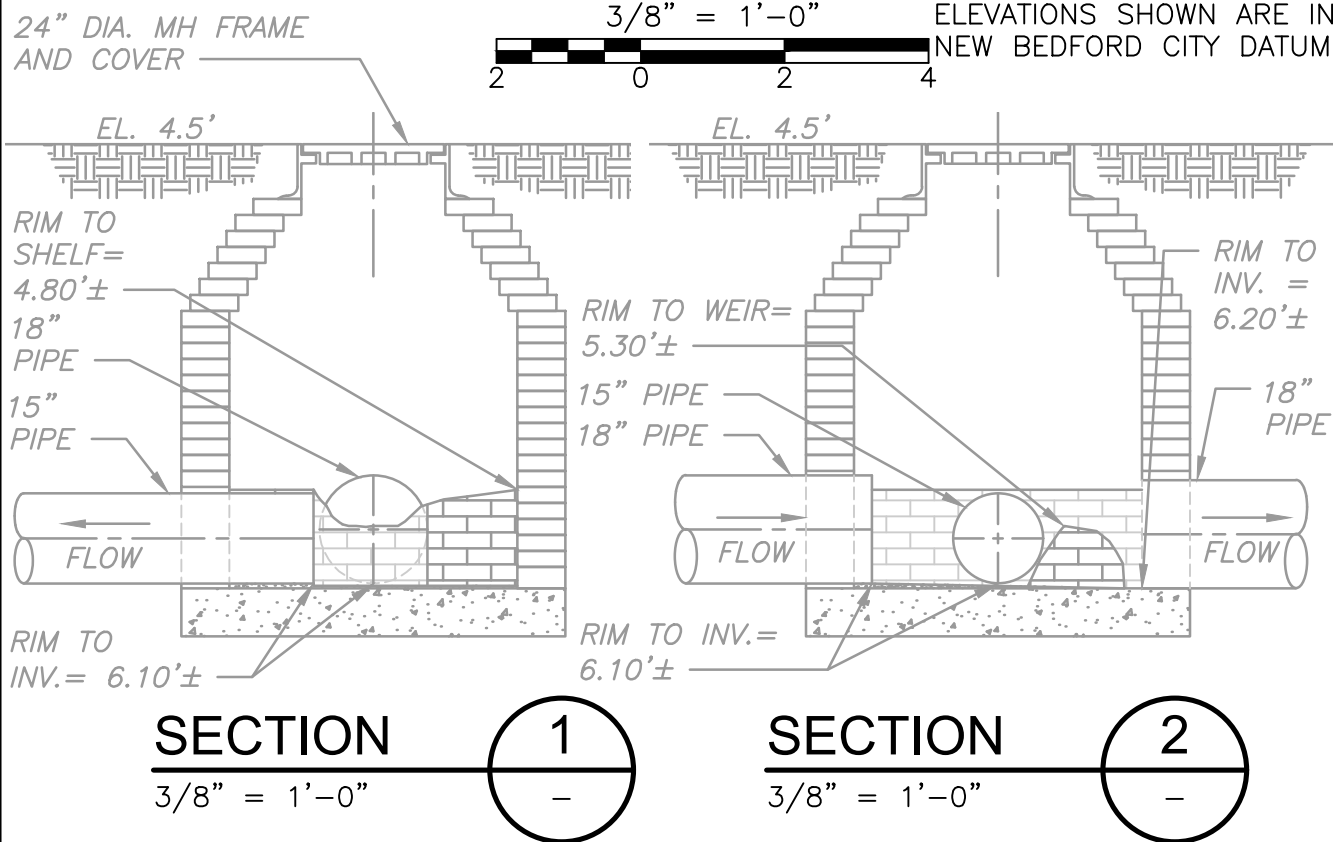
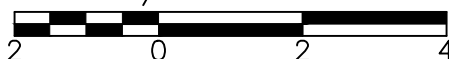



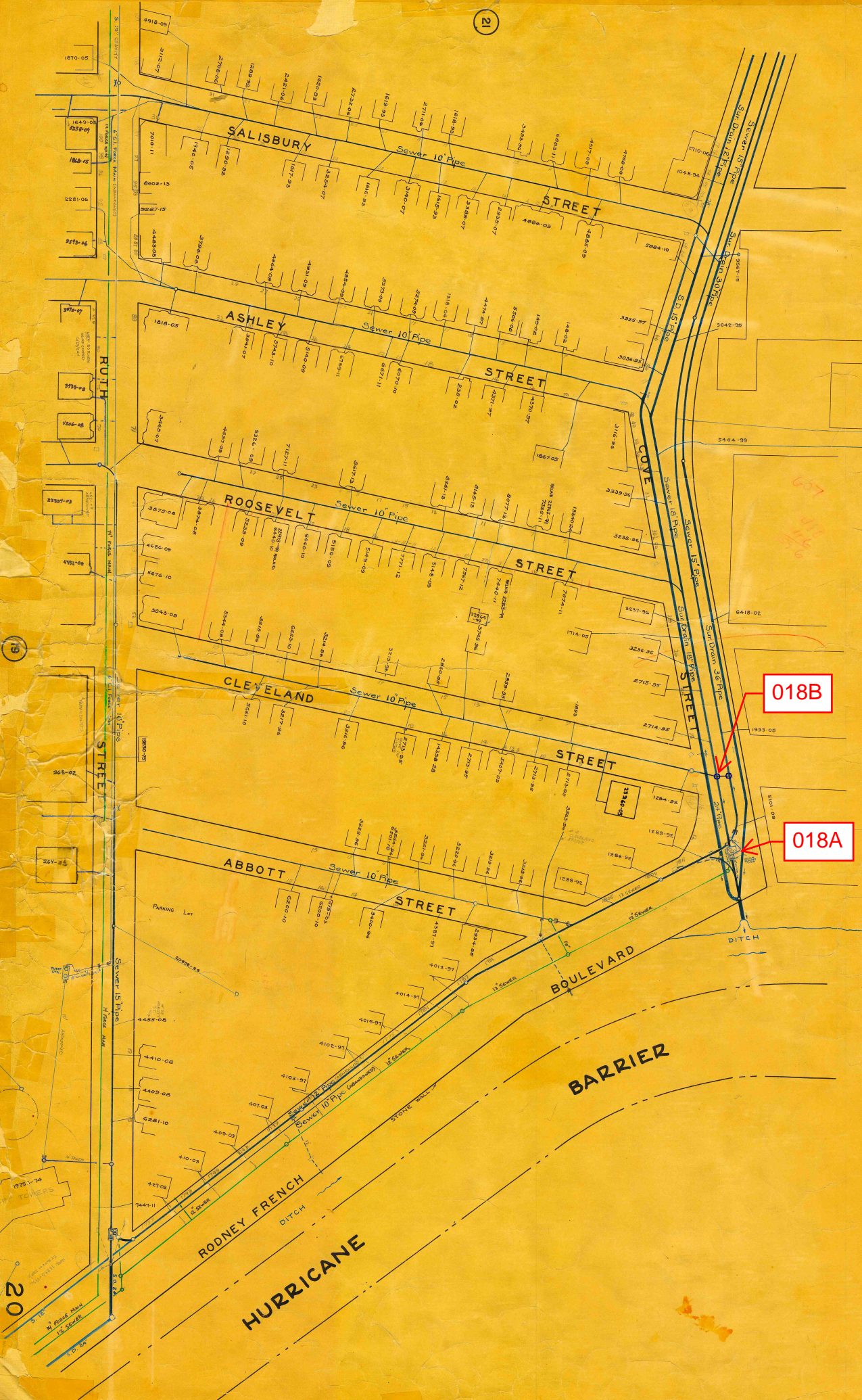



## REGULATOR FIELD PHOTOS

**Figure 1**



**Figure 2**



**Figure 3**



### Descriptions:

**Figure 1:** Inside of R-018B. Inflow, outflow, overflow, and weir visible.

**Figure 2:** Location of manhole marked in red. Google Earth snapshot facing east on Cove Street.

**Figure 3:** Aerial location with red circle around corresponding manhole.