

CSO SPEC SHEET

Structure #: REG 006 D

Date: 08/ 22/ 2012

Insp. By: AH and AK

Location: At the Intersection of Lucas St and French Rodney Blvd.

Structure Type: Cast Iron

Regulator Type: Weir Wall/Block Regulator

Structure DIM's: _____

Weir Dim's: 3.0' x 2.7'

Size of Sewer Pipe: 10" 15"

Rim to Top of Weir: 2.7'

Size of Storm Drain Pipe: 10"

Rim to Storm Drain Invert: 6.4'

Sewer Direction: East to South

Rim to Top of Sewer (Normal Flow): 5.6'

Free Board: 2.9'

Over All Rating: (Circle One)

Poor

Fair

Good

Excellent

Comments: Looks like there is infiltration to the sewer side. No Repairs Needed.

Field Sketch:

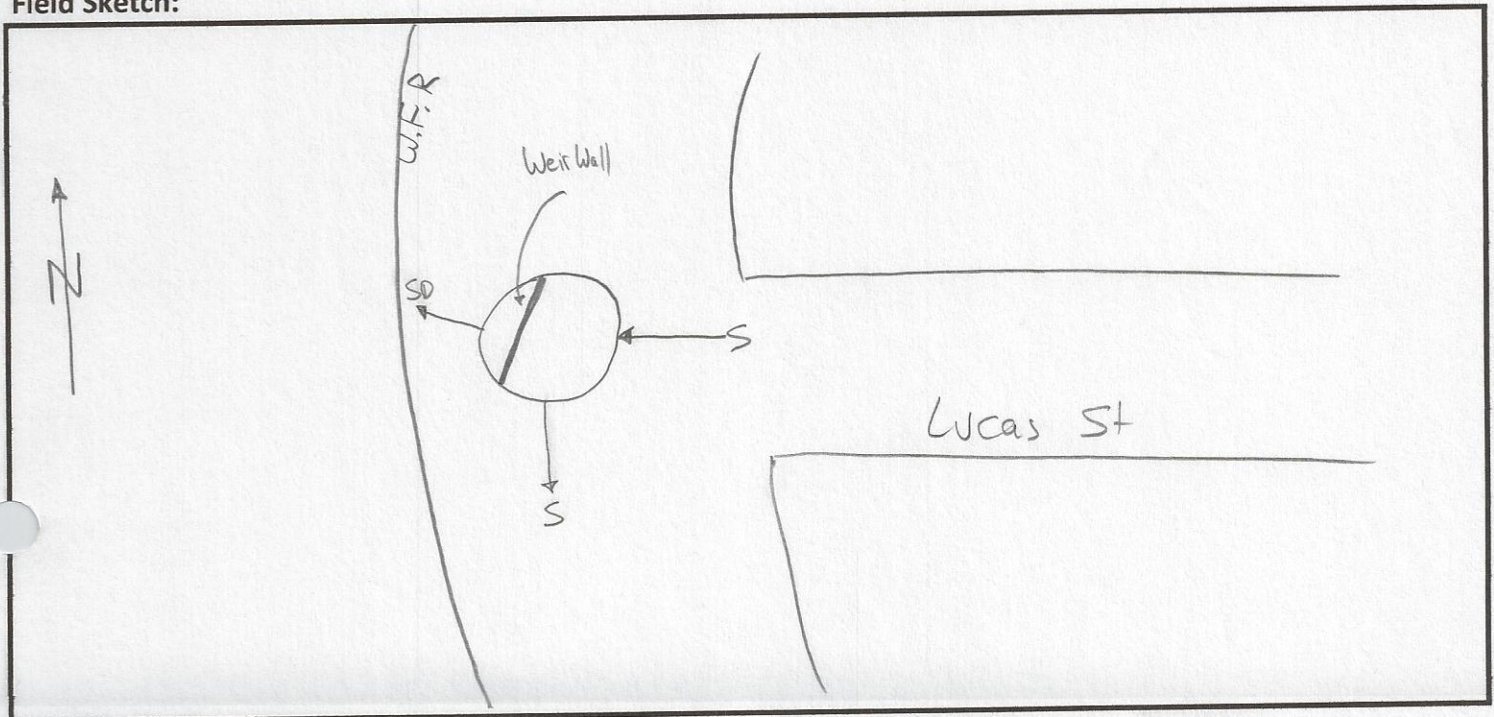

CSO FIELD PHOTOS

Structure#: REG 006 D

Location: At the Intersection of Lucas St and French Rodney Blvd.

Figure 1.



Figure 2.



Figure 3.



Figure 4.



Descriptions

Figure 1: View of Regulator 006 D. Facing North.

Figure 2: Inside view of manhole. A-Storm Drain; B- Weir Wall; C- Sewer.

Figure 3: Street view of Regulator 006 D. Facing North East.

Figure 4: Google Earth image of Regulator 006 C. A- REG 006B; B- CSO 006 outfall pipe.

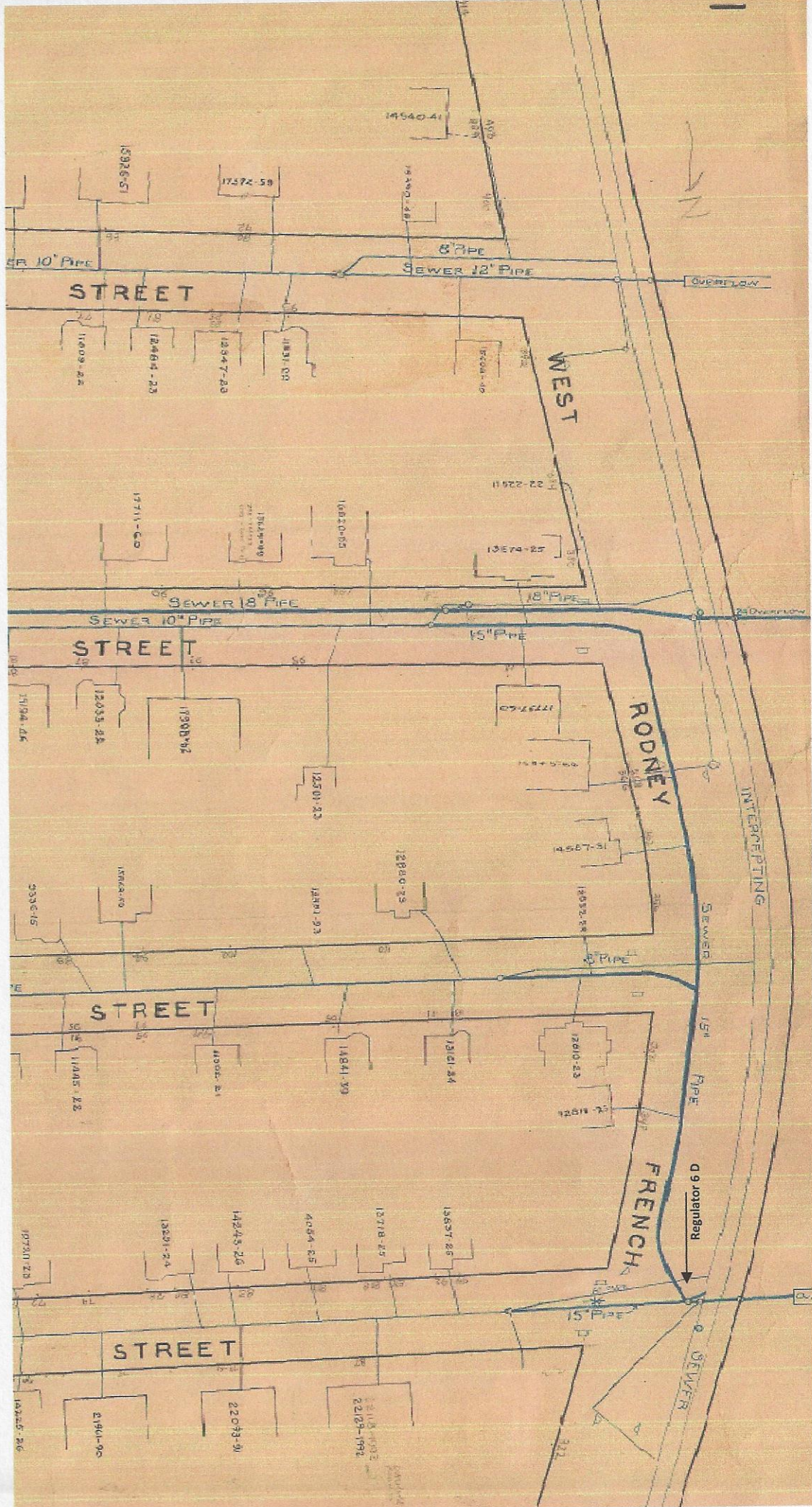

CSO/Regulator Repair Log

Structure #: Reg 006D

[illegible]