

## CSO SPEC SHEET

Structure #: REG 006 B

Date: 08/ 22/ 2012

Insp. By: AH and AK

Location: At the West End of Oaklawn St Near French Rodney Blvd.

Structure Type: Cast Iron

Regulator Type: Weir Wall

Structure DIM's: \_\_\_\_\_

Weir Dim's:

Size of Sewer Pipe: 10"

Rim to Top of Weir: 8.4'

Size of Storm Drain Pipe: 8"

Rim to Storm Drain Invert: 8.8'

Sewer Direction: East to South

Rim to Top of Sewer (Normal Flow): 8.7'

Free Board: 0.1'

Over All Rating: (Circle One)

Poor

Fair

Good

Excellent

Comments: The weir wall is made out of one brick. It can not prevent sewer from going into the CSO even when flow is bellow average. Block regulator is missing.

Field Sketch:

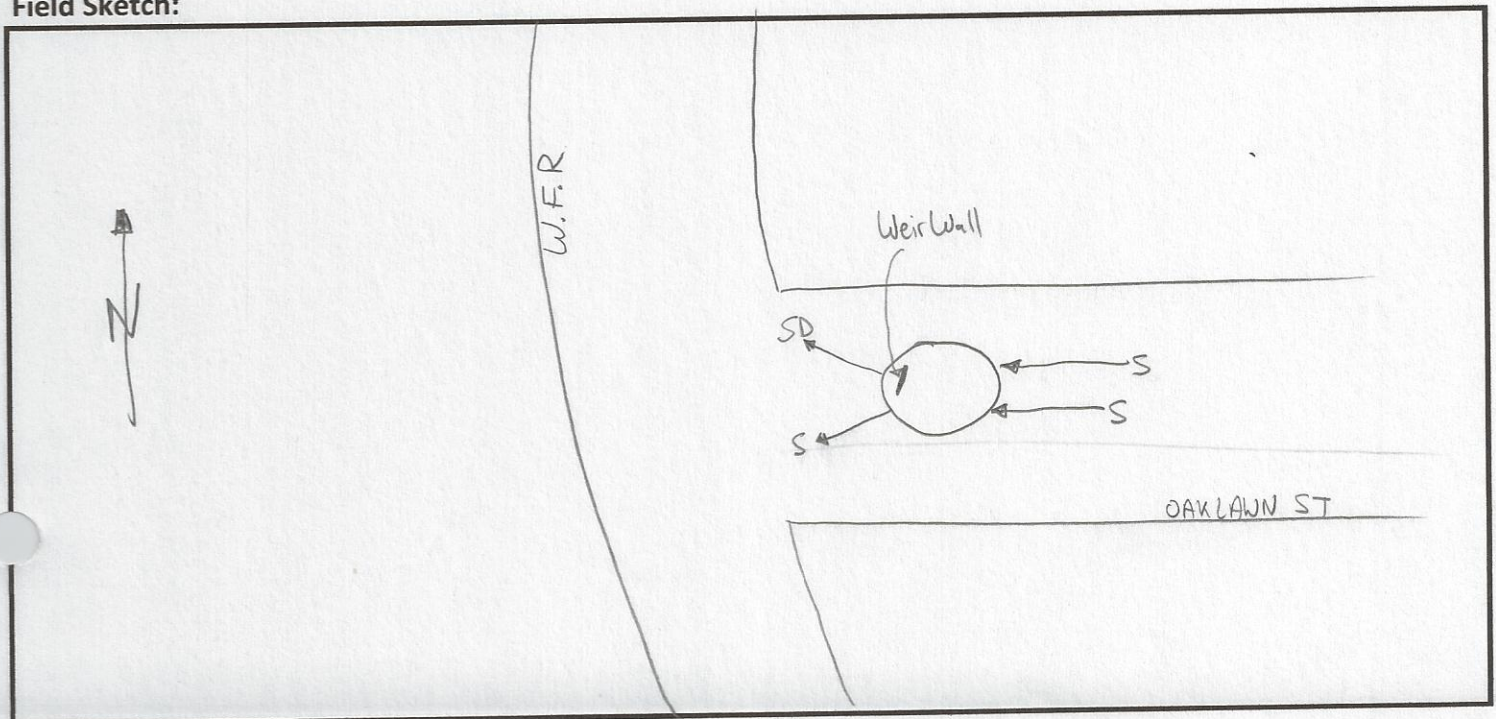



## CSO FIELD PHOTOS

Structure#: REG 006 B

Location: At the West End of Oaklawn St Near French Rodney Blvd.

Figure 1.



Figure 2.



Figure 3.



Figure 4.



### Descriptions

**Figure 1:** View of Regulator 006 B. Facing North.

**Figure 2:** Inside view of manhole. A-Storm Drain; B- Weir Wall; C- Sewer.

**Figure 3:** Street view of Regulator 006 B. Facing Clark's Cove.

**Figure 4:** Google Earth image of Regulator 006 B. A- REG 006B; B- CSO 006 outfall pipe.



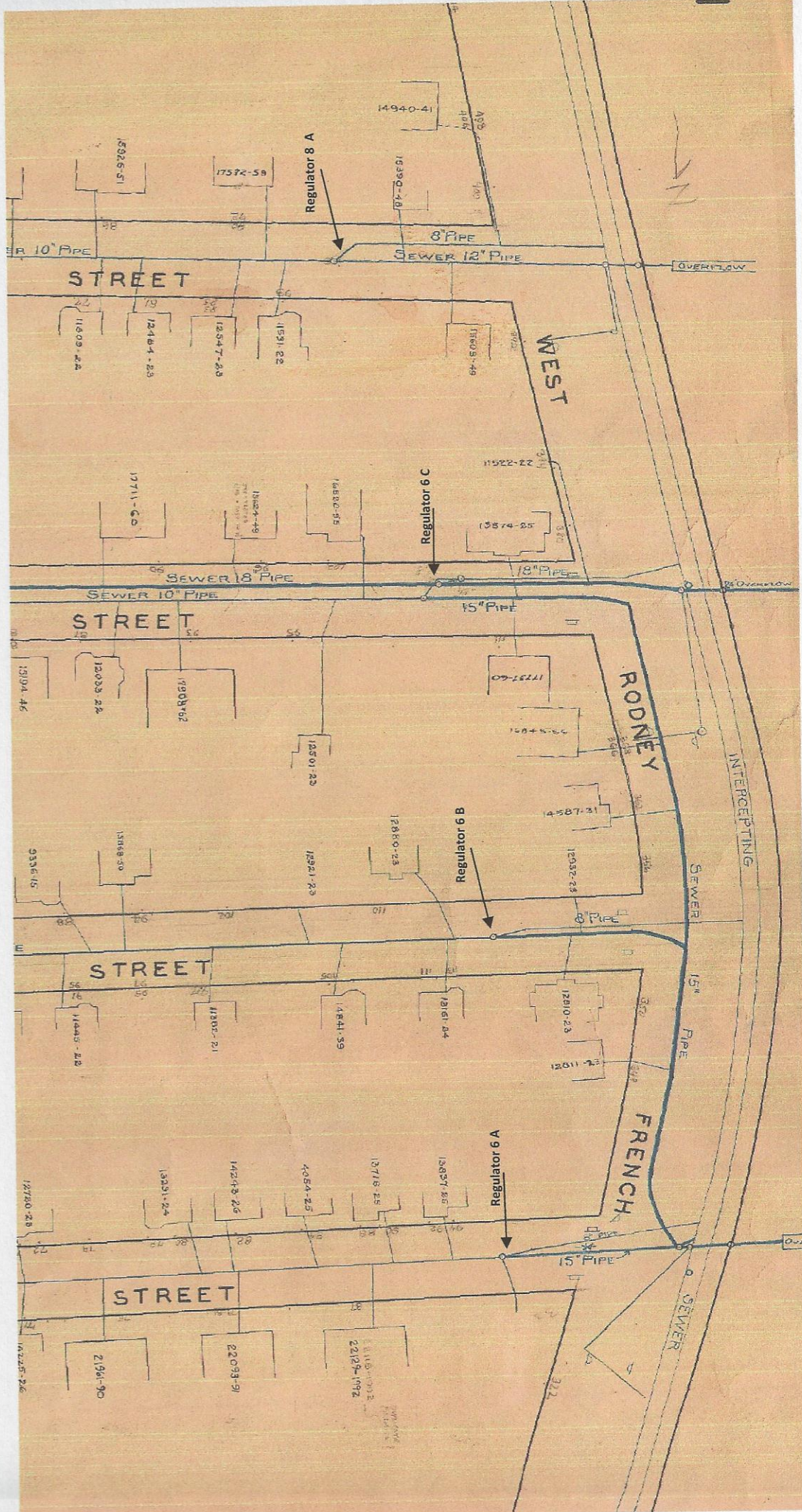



## CSO/Regulator Repair Log

Structure #: 006 B

[illegible]