

New Bedford Regulator Specification Sheet

Regulator #: R-006A**Location:** Lucas St. near W. Rodney French Blvd.**Date:** 6/25/25

Structure Measurements

Structure Type: Single manhole**Rim Elevation (ft City Datum):** 8.7**Regulator Type:** Fixed Weir**Overflow Height (ft or in):** 8"**Rim to Top of Weir (ft):** 5.9**Weir Dims (ft or in):** Width: 3", Height: 8"**Influent pipe \varnothing (in):** 10**Rim to Influent Invert (ft):** 6.7**Dry Weather Connection \varnothing (in):** 8**Rim to Dry Weather Invert (ft):** 6.7**Overflow pipe \varnothing (in):** 10**Rim to Overflow Invert (ft):** 6.7

Sensor Measurements

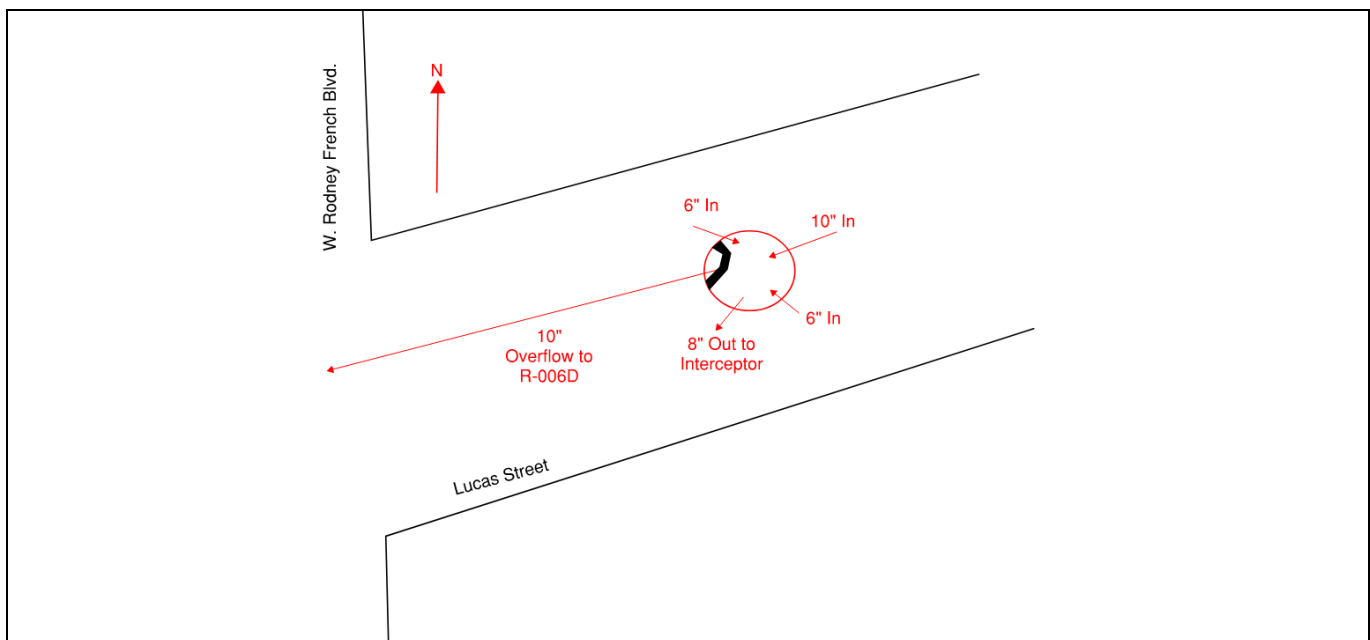
Block Present: Yes**Level Sensor Status:** Not Metered**Sensor Installation Date:** n/a**Intra-System Status:** Yes**Tide Gate Status:** None**Notes:****Location Sketch:**

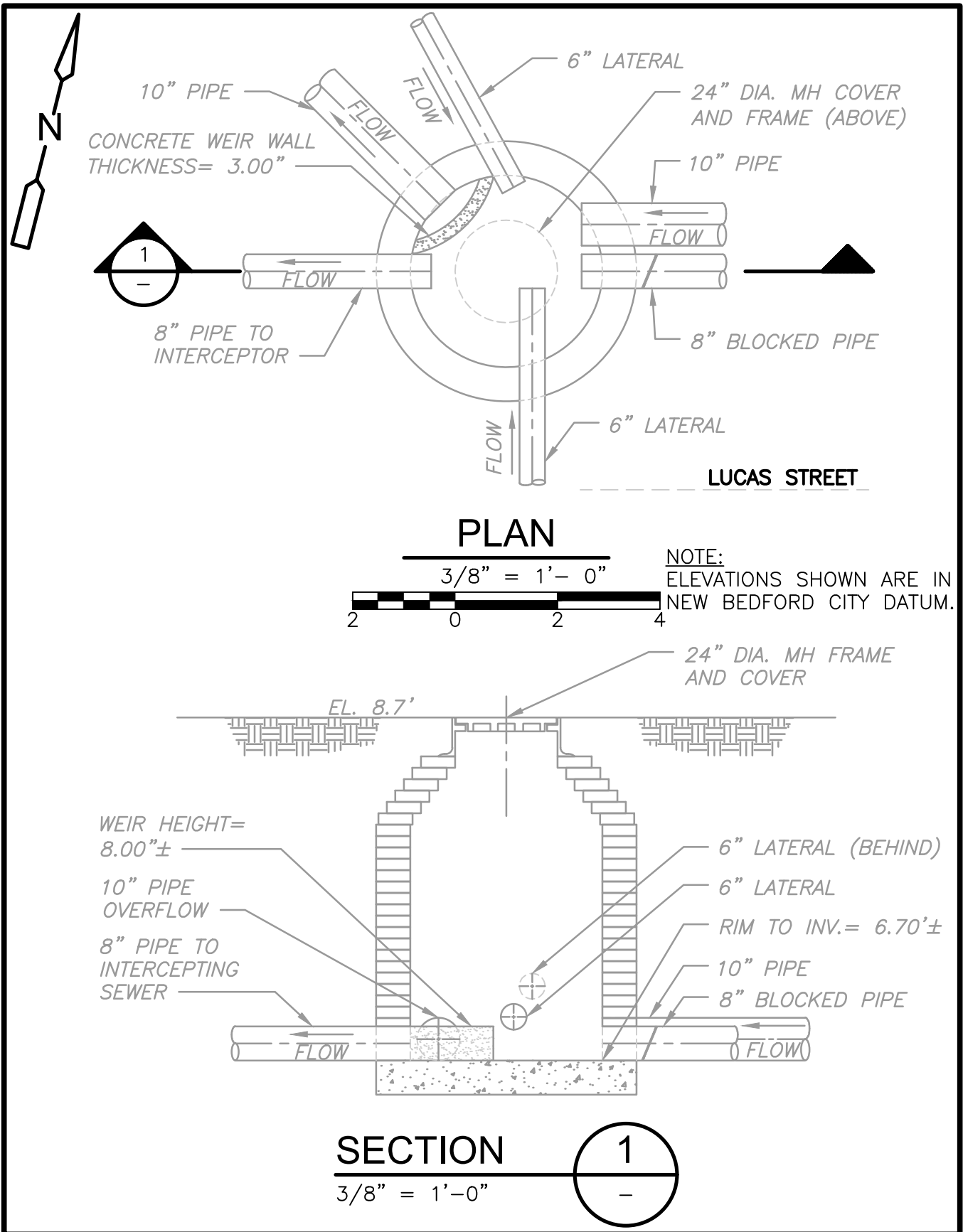

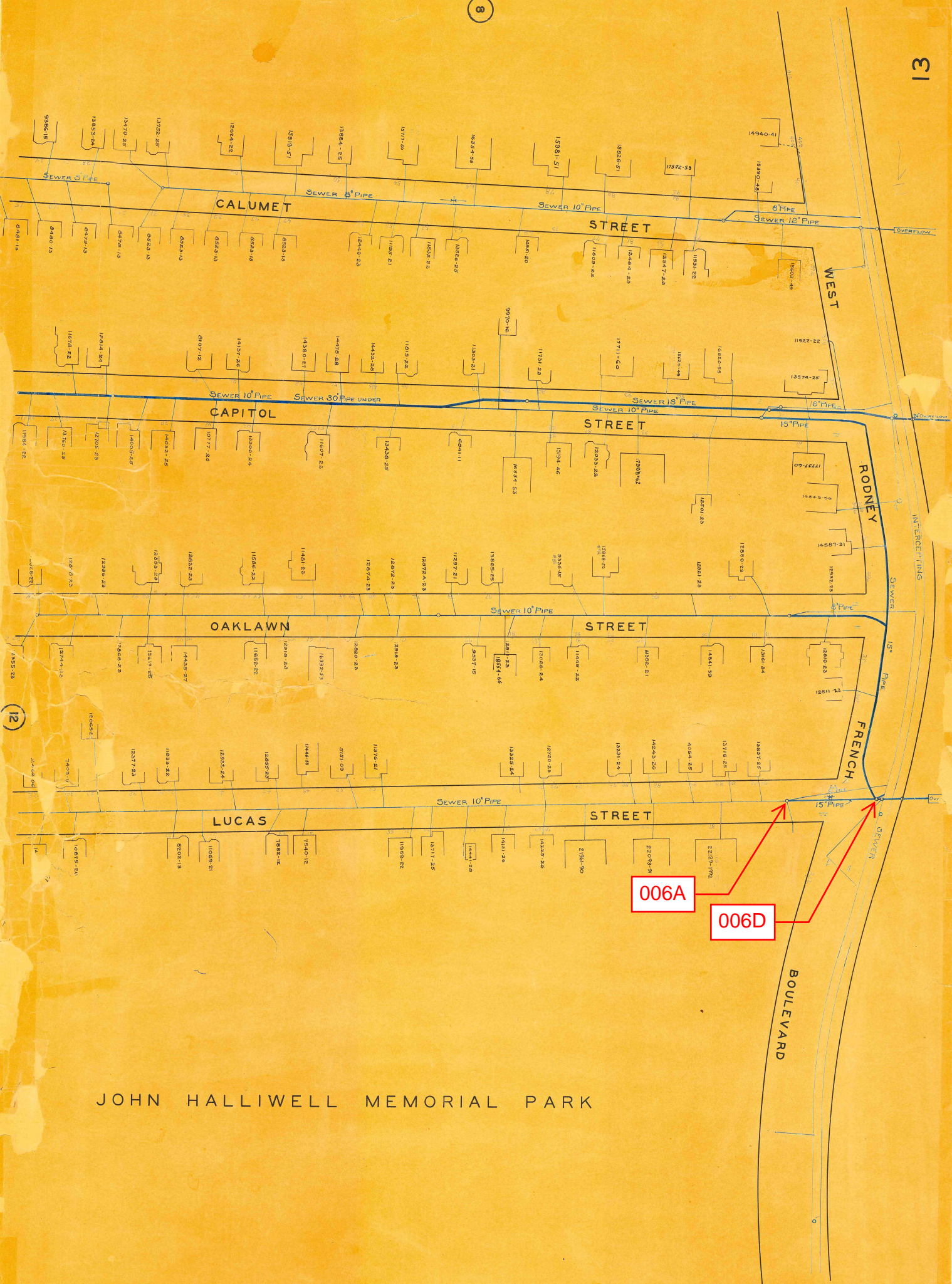

JOHN HALLIWELL MEMORIAL PARK

REGULATOR FIELD PHOTOS

Figure 1



Figure 2



Figure 3



Figure 4



Descriptions:

Figure 1: Inside of R-006A. Inflows, outflows, weir, and overflow visible.

Figure 2: Inside of R-006A. Inflows, outflows, weir, and overflow visible.

Figure 3: Google Earth snapshot facing west along Oaklawn Street. Manhole marked in red.

Figure 4: Aerial location with arrow pointing to corresponding manhole.