



Expires 6/12/19

PERMIT NO.

CITY OF NEW BEDFORD
SEWER AND/OR STORM DRAIN PERMIT

DATE 6/12/19

24589

This certifies that permission is granted to

Property Owner 18 Shady Ln. New Bedford, MA 02740 Address 18 Shady Ln. Tel. 508-977-9680

To connect a sewer and/or storm drain located at 18 Shady Ln. 2nd sewer

Assessor's Plot 73 Lot 35 to the sewer and/or storm drain in Shady Ln. Street

To be laid in accordance with the conditions in this application and the City of New Bedford ordinances.

TYPE OF USE: RESIDENTIAL COMMERCIAL INDUSTRIAL FLOW G.P.D.

If applicant other than actual property owner, attach Letter of Authorization from Property Owner.

Name N/A Tel.

Mailing Address N/A

The Bonded Contractor/Drain Layer authorized to perform this work is:

Name SDR 35 Address Tel.

Type of Pipe Required: SDR 35

PERMIT EXPIRES ONE YEAR AFTER DATE OF ISSUE

- Requires separate connections for sewage and storm drain where applicable. Storm water cannot be discharged to a sanitary sewer.
- All work must be inspected and approved by a D.P.I. inspector before backfilling.
- If this connection is to be part of a private service shared jointly with other building owners, attach copy of Recorded Joint Maintenance Agreement.
- Permits can be issued to Industrial and/or Commercial Applicants only upon receipt and approval by the Commissioner of Public Infrastructure of required plans and supplemental information.
- In addition, a City-issued Industrial User Discharge Permit and/or a Sewer Extension/Connection Permit issued by the Commonwealth of Massachusetts D.E.P. shall be required by the City for Industrial Discharge into the sewer system.

Industrial User Discharge Permit No. Date

Comm. Mass. Sewer Conn./Ext. Permit No. Date

A Filing and Inspection Fee of \$450.00 plus an Entrance Fee of \$ where applicable, must accompany this application.

Bank# Bank of America Check# 5695 Date 6/12/18 Receipt# 1716014

Other requirements:

Connection made to Sewer Part of jointly-shared private line YES NO
Storm Drain

Applicant agrees to abide by the above terms, as well as all pertinent ordinances of the City of New Bedford, and such other special rules as the Commissioner of Public Infrastructure and/or City Engineer may deem necessary

Manuel H. Silva
City Engineer

Signature of Property Owner or Representative

INSPECTOR'S REPORT

INSPECTED BY: SEE WHITE SHEET
DATE:
COMMENTS:

APPROVED DISAPPROVED

SIGNATURE

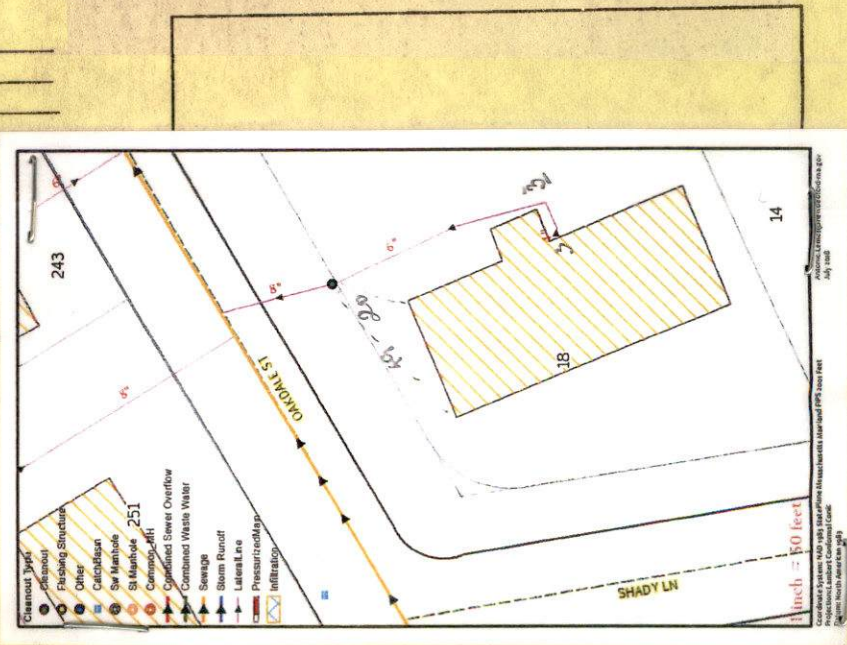



inspection
7/6/18 @
12:00

Expires 6/12/19

PERMIT NO.
24589

CITY OF NEW BEDFORD
SEWER AND/OR STORM DRAIN PERMIT

DATE 6/12/18

This certifies that permission is granted to

Miss Bettencourt 18 Shady Ln. New Bedford, MA 02740
Property Owner Address Tel. 508-977-9680

To connect a sewer and/or storm drain located at 18 Shady Ln. 8th sewer
Assessor's Plot 73 Lot 35, to the sewer and/or storm drain in Oakdale St. Street

To be laid in accordance with the conditions in this application and the City of New Bedford ordinances.

TYPE OF USE: RESIDENTIAL COMMERCIAL INDUSTRIAL FLOW G.P.D.

If applicant other than actual property owner, attach Letter of Authorization from Property Owner.

Name Mailing Address Tel.

The Bonded Contractor/Drain Layer authorized to perform this work is:

Nelson Cardozo
Name Address Tel.
Type of Pipe Required: SDR 35

PERMIT EXPIRES ONE YEAR AFTER DATE OF ISSUE

- Requires separate connections for sewage and storm drain where applicable. Storm water cannot be discharged to a sanitary sewer.
 - All work must be inspected and approved by a D.P.I. inspector before backfilling.
 - If this connection is to be part of a private service shared jointly with other building owners, attach copy of Recorded Joint Maintenance Agreement.
 - Permits can be issued to Industrial and/or Commercial Applicants only upon receipt and approval by the Commissioner of Public Infrastructure of required plans and supplemental information.
 - In addition, a City-issued Industrial User Discharge Permit and/or a Sewer Extension/Connection Permit issued by the Commonwealth of Massachusetts D.E.P. shall be required by the City for Industrial Discharge into the sewer system.
- Industrial User Discharge Permit No. Date

Comm. Mass. Sewer Conn./Ext. Permit No. Date
A Filing and Inspection Fee of \$450.00 plus an Entrance Fee of \$ where applicable, must accompany this application.

Bank# Bank of America Check# 5695 Date 6/12/18 Receipt# 1716014

Other requirements: FOR INSPECTION ONLY A 24 HOUR NOTICE IS REQUIRED AND THE CONTRACTOR/APPLICANT IS REQUIRED TO NOTIFY THE D.P.I. @ 508 979-1550 Press 4 Repair PERMIT EXPIRES 1 YEAR

Connection made to Sewer Storm Drain

Applicant agrees to abide by the above terms, as well as all pertinent ordinances of the City of New Bedford, and such other special rules as the Commissioner of Public Infrastructure and/or City Engineer may deem necessary

Manuel H. Silva City Engineer
Signature of Property Owner or Representative

INSPECTOR'S REPORT

INSPECTED BY: Antonio Lemos
DATE: 7/6/2018
COMMENTS: Abandonment of septic system 6" Dve + 20
APPROVED DISAPPROVED
Antonio Lemos
SIGNATURE

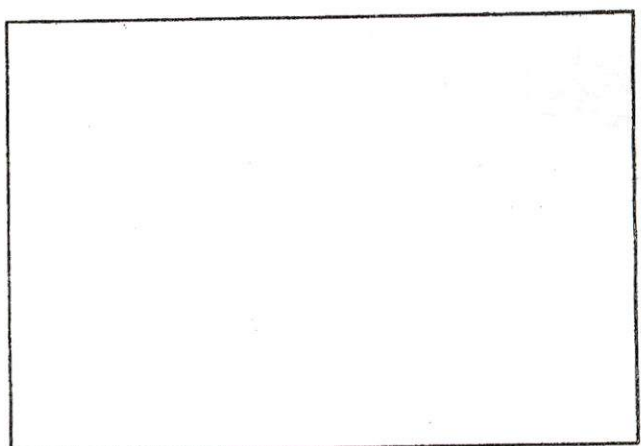

SKETCH PLAN

FOR INSPECTION ONLY A 24 HOUR NOTICE IS REQUIRED AND THE CONTRACTOR/APPLICANT IS REQUIRED TO NOTIFY THE D.P.I. @ 508 979-1550 Press 4 Repair PERMIT EXPIRES 1 YEAR

W2-18-41

Expires 6/12/19



PERMIT NO.
24589

CITY OF NEW BEDFORD
SEWER AND/OR STORM DRAIN PERMIT

DATE 6/12/18

This certifies that permission is granted to

Miss Bettencourt 18 Shady Ln. New Bedford, MA 02740
Property Owner Address Tel. 508-977-9680

To connect a sewer and/or storm drain located at 18 Shady Ln. 8th sewer

Assessor's Plot 73 Lot 35, to the sewer and/or storm drain in Oakdale St. Street

To be laid in accordance with the conditions in this application and the City of New Bedford ordinances.

TYPE OF USE: RESIDENTIAL COMMERCIAL INDUSTRIAL FLOW G.P.D.

If applicant other than actual property owner, attach Letter of Authorization from Property Owner.

Name Mailing Address Tel.

The Bonded Contractor/Drain Layer authorized to perform this work is:

Nelson Cardoso

Name Address Tel.

Type of Pipe Required: SDR 35

PERMIT EXPIRES ONE YEAR AFTER DATE OF ISSUE

- Requires separate connections for sewage and storm drain where applicable. Storm water cannot be discharged to a sanitary sewer.
- All work must be inspected and approved by a D.P.I. inspector before backfilling.
- If this connection is to be part of a private service shared jointly with other building owners, attach copy of Recorded Joint Maintenance Agreement.
- Permits can be issued to Industrial and/or Commercial Applicants only upon receipt and approval by the Commissioner of Public Infrastructure of required plans and supplemental information.
- In addition, a City-issued Industrial User Discharge Permit and/or a Sewer Extension/Connection Permit issued by the Commonwealth of Massachusetts D.E.P. shall be required by the City for Industrial Discharge into the sewer system.

Industrial User Discharge Permit No. Date

Comm. Mass. Sewer Conn./Ext. Permit No. Date

A Filing and Inspection Fee of \$450.00 plus an Entrance Fee of \$ where applicable, must accompany this application.

Bank# Bank of America Check# 5695 Date 6/12/18 Receipt# 1716014

Other requirements: FOR INSPECTION ONLY A 24 HOUR NOTICE IS REQUIRED AND THE CONTRACTOR/APPLICANT IS REQUIRED TO NOTIFY THE D.P.I.

Connection made to Sewer F @ 508 979-1550 Press 4 Repair

Storm Drain NO

Applicant agrees to abide by the above terms, as well as all pertinent ordinances of the City of New Bedford, and such other special rules as the Commissioner of Public Infrastructure and/or City Engineer may deem necessary

Manuel H. Silva City Engineer Signature of Property Owner or Representative

INSPECTOR'S REPORT

INSPECTED BY: DATE: COMMENTS:

APPROVED DISAPPROVED

SIGNATURE

FOR INSPECTION ONLY A 24 HOUR NOTICE IS REQUIRED AND THE CONTRACTOR/APPLICANT IS REQUIRED TO NOTIFY THE D.P.I. @ 508 979-1550 Press 4 Repair PERMIT EXPIRES 1 YEAR

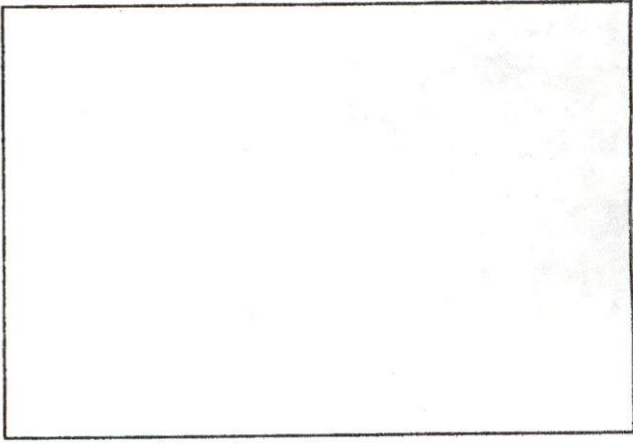

SKETCH PLAN

No. 18-06

FEE 60

COMMONWEALTH OF MASSACHUSETTS

Board of Health, New Bedford, MA.

DISPOSAL SYSTEM CONSTRUCTION PERMIT

Permission is hereby granted to; Construct() Repair() Upgrade() Abandon(☒) an individual sewage disposal system at 18 Shady Lane New Bedford Ma as described in the application for Disposal System Construction Permit No. 18-06, dated 6/12/10.

Provided: Construction shall be completed within three years of the date of this permit. All local conditions must be met.

Date 6/12/10 Board of Health Paul A. Joseph

James Battencourt
774-644-1872
18 Shady fn.

- Septic system is broken & can't use @ all

- needs to tie into City sewer

- depth of line (sewer) 6' deep per City

- has sump pump in cellar to push septic waste to tank

- no information re: stub or sewer in this area

- Jim to have the line filmed on Fri. 6/8/18



Commonwealth of Massachusetts

City of New Bedford

133 William Street New Bedford, MA 02740

SEWER PERMIT



Date: **6/22/2018**

No. **WW-18-41**

Sewer Connection Fee: **\$450.00**

Pipe Size: **0.00**

Trench Length: **0.00**

Service Location: **18 SHADY LN**

Owner Name: **BETTENCOURT LUIS RANDRE**

Type of Occupancy: **Residential**

Type of Work: **Sewer - New Sewer Service**

Work Description: **sewer# 24589**

P.73

L.35

18 Shady Lane

expires 06/12/19

No. of Units : **0**

Required Design Daily Flow : **0.00**

Provided Daily Flow : **0.00**

The undersigned petitions you to grant permission to ENTER INTO THE MAIN SEWER and, if such permission is granted, hereby agrees to the following:

1. To abide by the conditions and regulations imposed by the Commissioner of Public Works by statute or by ordinance now in force, or as amended from time to time.
2. That the connection of said sewer with the main sewer shall be inspected by an employee of the department of Public Works or by a designated agent of the Town before burial of said connection.
3. That the work shall at all times be under the direction and control of the Commissioner of Public Works or his authorized agent, and that any expense incurred by the Town shall be charged to the permittee, and said permittee agrees to reimburse the Town for said expense.

Installing Company Name: **Nelson Cardoso**

License Type: **Hoisting Engineer**

Address: **PO Box 30360**

City/Town/State: **Acushnet**

MA

Call (781) 942-9077 For Inspection

DISPLAY PERMIT IN A CONSPICUOUS PLACE ON THE PREMISES



Commonwealth of Massachusetts

City of New Bedford

133 William Street New Bedford, MA 02740

SEWER PERMIT



GRANTED WITH THE USUAL CONDITIONS

COMMISSIONER

Call (781) 942-9077 For Inspection

LUIS R. BETTENCOURT
IDALECIA M. ANDRE
18 SHADY LN.
NEW BEDFORD, MA 02740-1850

5695

63-13/110 MA
26738

6/12/2018

Date

Pay to the
Order of

City of New Bedford
Four hundred and 14/100

\$ 150.00

Dollars



Printed
Safe
Deposit
Check only

Bank of America

ACH R/T 011000138

For

Debit to the

⑆011000138⑆ 000899507008⑈5695

Work Order Number: 18-009182

7/6/2018
11:49 AM

Category: Service Lateral Pressure Priority: _____
Problem: Locate Request Crew: _____
Cause: _____ Supervisor: STEPHANIE DUPRAS
Main Task: Inspection Status: New Work Order
Work Order Start Date/Time: _____ Work Order End Date/Time: _____

Location (s) _____
18 SHADY LN

Comments from Request _____
SEWER INSPECTION FOR NELSON CARDOSO .. TODAY ASAP .. SEWER PERMIT #24589

Task Start Date/Time: _____ Task End Date/Time: _____

Task Code: SWT180 Task Description: Inspection

Employee Number	Employee Name	Time Type				Units
		Reg	OT	Normal	Type	
14950	ANTONIO LEMOS	0.00	0.00	0.00	REGULAR TIME	Hours

_____	_____	_____	_____	_____	_____	_____
_____	_____	_____	_____	_____	_____	_____
_____	_____	_____	_____	_____	_____	_____

Equipment Code	Equipment Description	Units
_____	_____	_____
_____	_____	_____
_____	_____	_____

Material Code	Material Description	Units
_____	_____	_____
_____	_____	_____
_____	_____	_____

Fluid Code	Fluid Description	Units
_____	_____	_____
_____	_____	_____
_____	_____	_____

7/9 Geolocate 00 ✓