



Expires 4/10/19

PERMIT NO.  
**24574**

CITY OF NEW BEDFORD  
SEWER AND/OR STORM DRAIN PERMIT

DATE 4/10/18

This certifies that permission is granted to

Carmelina DaCosta 567 Middle St. Acushnet, Ma. 508-326-8732  
Property Owner Address Tel.

To connect a sewer and/or storm drain located at 1033-1035 Marlboro St.

Assessor's Plot 132-H Lot 199, to the sewer and/or storm drain in Marlboro St. Street

To be laid in accordance with the conditions in this application and the City of New Bedford ordinances.

TYPE OF USE: RESIDENTIAL COMMERCIAL INDUSTRIAL FLOW \_\_\_\_\_ G.P.D.

If applicant other than actual property owner, attach Letter of Authorization from Property Owner.

Name \_\_\_\_\_ Tel. \_\_\_\_\_

Mailing Address \_\_\_\_\_

The Bonded Contractor/Drain Layer authorized to perform this work is:

Cardoso Contracting

Name \_\_\_\_\_ Address \_\_\_\_\_ Tel. \_\_\_\_\_

Type of Pipe Required: SDR 35

PERMIT EXPIRES ONE YEAR AFTER DATE OF ISSUE

- Requires separate connections for sewage and storm drain where applicable. Storm water cannot be discharged to a sanitary sewer.
- All work must be inspected and approved by a D.P.I. inspector before backfilling.
- If this connection is to be part of a private service shared jointly with other building owners, attach copy of Recorded Joint Maintenance Agreement.
- Permits can be issued to Industrial and/or Commercial Applicants only upon receipt and approval by the Commissioner of Public Infrastructure of required plans and supplemental information.
- In addition, a City-issued Industrial User Discharge Permit and/or a Sewer Extension/Connection Permit issued by the Commonwealth of Massachusetts D.E.P. shall be required by the City for Industrial Discharge into the sewer system.

Industrial User Discharge Permit No. \_\_\_\_\_ Date \_\_\_\_\_

Comm. Mass. Sewer Conn./Ext. Permit No. \_\_\_\_\_ Date \_\_\_\_\_

A Filing and Inspection Fee of \$ 450, plus an Entrance Fee of \$ 44.25 where applicable, must accompany this application.

Bank# Bank of America Check# 110 / 109 Date 4/10/18 Receipt# #1612266  
#1612298

Other requirements: 24 hr. notice for sewer inspection

Connection made to Sewer Part of jointly-shared private line YES NO  
Storm Drain

Applicant agrees to abide by the above terms, as well as all pertinent ordinances of the City of New Bedford, and such other special rules as the Commissioner of Public Infrastructure and/or City Engineer may deem necessary

Adam Amato  
City Engineer

Carmelina DaCosta  
Signature of Property Owner or Representative

INSPECTOR'S REPORT

INSPECTED BY: SEE WHITE SHEET  
DATE: \_\_\_\_\_  
COMMENTS: \_\_\_\_\_

APPROVED

DISAPPROVED

SIGNATURE

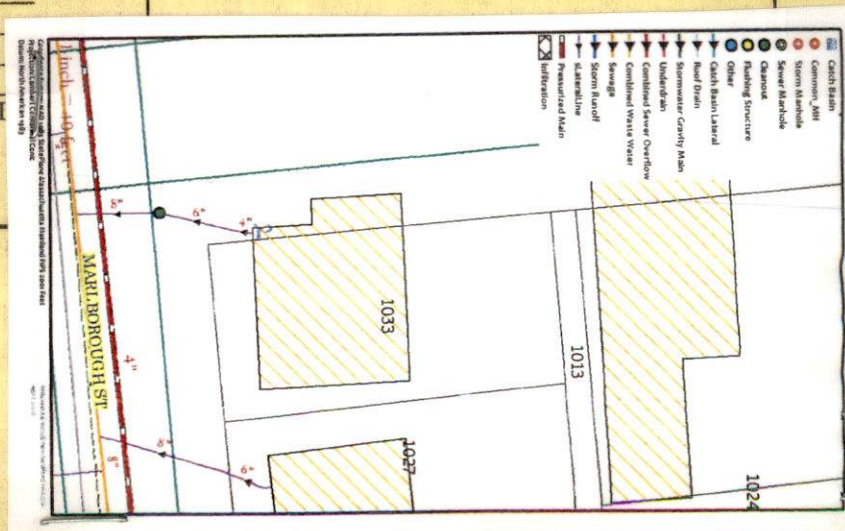



TW 18-12

maxing:  
expired 4/10/19



PERMIT NO.  
24574

ABonchinnat

CITY OF NEW BEDFORD  
SEWER AND/OR STORM DRAIN PERMIT

DATE 4/10/18

This certifies that permission is granted to

Property Owner Carmelina DaCosta Address 567 Middle St. Acushnet, Ma. Tel. 508-320-8732

To connect a sewer and/or storm drain located at 1033-1035 Marlboro St.

Assessor's Plot 132-H Lot 199, to the sewer and/or storm drain in Marlboro St. Street

To be laid in accordance with the conditions in this application and the City of New Bedford ordinances.

TYPE OF USE: RESIDENTIAL COMMERCIAL INDUSTRIAL FLOW \_\_\_\_\_ G.P.D.

If applicant other than actual property owner, attach Letter of Authorization from Property Owner.

Name \_\_\_\_\_ Tel. \_\_\_\_\_  
Mailing Address \_\_\_\_\_

The Bonded Contractor/Drain Layer authorized to perform this work is:

Cardoso Contracting  
Name \_\_\_\_\_ Address \_\_\_\_\_ Tel. \_\_\_\_\_  
Type of Pipe Required: SDR 35

PERMIT EXPIRES ONE YEAR AFTER DATE OF ISSUE

- Requires separate connections for sewage and storm drain where applicable. Storm water cannot be discharged to a sanitary sewer.
- All work must be inspected and approved by a D.P.I. inspector before backfilling.
- If this connection is to be part of a private service shared jointly with other building owners, attach copy of Recorded Joint Maintenance Agreement.
- Permits can be issued to Industrial and/or Commercial Applicants only upon receipt and approval by the Commissioner of Public Infrastructure of required plans and supplemental information.
- In addition, a City-issued Industrial User Discharge Permit and/or a Sewer Extension/Connection Permit issued by the Commonwealth of Massachusetts D.E.P. shall be required by the City for Industrial Discharge into the sewer system.

Industrial User Discharge Permit No. \_\_\_\_\_ Date \_\_\_\_\_

Comm. Mass. Sewer Conn./Ext. Permit No. \_\_\_\_\_ Date \_\_\_\_\_

A Filing and Inspection Fee of \$450, plus an Entrance Fee of \$450, where applicable, must accompany this application.

Bank# Bank of America Check# 110 / 109 Date 4/10/18 Receipt# #1612298

Other requirements: 24 hr. notice for sewer inspection

Connection made to Sewer Part of jointly-shared private line YES NO  
Storm Drain

Applicant agrees to abide by the above terms, as well as all pertinent ordinances of the City of New Bedford, and such other special rules as the Commissioner of Public Infrastructure and/or City Engineer may deem necessary

Adm. Manager  
City Engineer

Carmelina DaCosta  
Signature of Property Owner or Representative

INSPECTOR'S REPORT

INSPECTED BY: \_\_\_\_\_  
DATE: \_\_\_\_\_  
COMMENTS: \_\_\_\_\_

APPROVED \_\_\_\_\_ DISAPPROVED \_\_\_\_\_

SIGNATURE \_\_\_\_\_

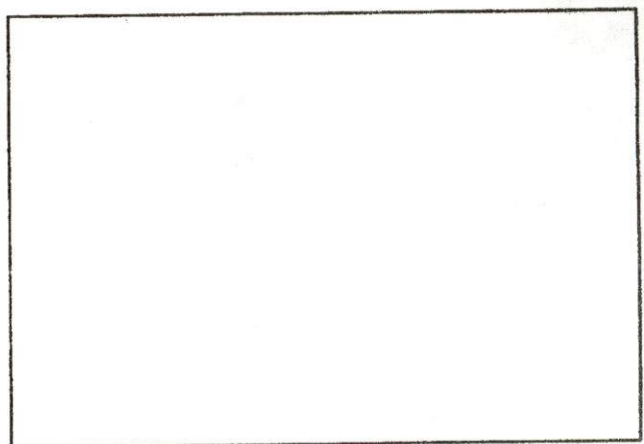

SKETCH PLAN





on Plat

F-18 P.1994



Inspector

Expires 4/10/19

PERMIT NO.

24574

CITY OF NEW BEDFORD  
SEWER AND/OR STORM DRAIN PERMIT

DATE 4/10/18

This certifies that permission is granted to

Property Owner Carmelina DaCosta Address 567 Middle St. Acushnet, Ma. Tel. 508-320-8732

To connect a sewer and/or storm drain located at 1033-1035 Marlboro St.

Assessor's Plot 132-H Lot 199, to the sewer and/or storm drain in Marlboro St. Street

To be laid in accordance with the conditions in this application and the City of New Bedford ordinances.

TYPE OF USE: RESIDENTIAL COMMERCIAL INDUSTRIAL FLOW \_\_\_\_\_ G.P.D.

If applicant other than actual property owner, attach Letter of Authorization from Property Owner.

Name \_\_\_\_\_ Tel. \_\_\_\_\_

Mailing Address \_\_\_\_\_

The Bonded Contractor/Drain Layer authorized to perform this work is:

Cardoso Contracting

Name \_\_\_\_\_ Address \_\_\_\_\_ Tel. \_\_\_\_\_

Type of Pipe Required: SDR 35

PERMIT EXPIRES ONE YEAR AFTER DATE OF ISSUE

- Requires separate connections for sewage and storm drain where applicable. Storm water cannot be discharged to a sanitary sewer.
  - All work must be inspected and approved by a D.P.I. inspector before backfilling.
  - If this connection is to be part of a private service shared jointly with other building owners, attach copy of Recorded Joint Maintenance Agreement.
  - Permits can be issued to Industrial and/or Commercial Applicants only upon receipt and approval by the Commissioner of Public Infrastructure of required plans and supplemental information.
  - In addition, a City-issued Industrial User Discharge Permit and/or a Sewer Extension/Connection Permit issued by the Commonwealth of Massachusetts D.E.P. shall be required by the City for Industrial Discharge into the sewer system.
- Industrial User Discharge Permit No. \_\_\_\_\_ Date \_\_\_\_\_

Comm. Mass. Sewer Conn./Ext. Permit No. \_\_\_\_\_ Date \_\_\_\_\_

A Filing and Inspection Fee of \$450., plus an Entrance Fee of \$461.25 where applicable, must accompany this application.

Bank# Bank of America Check# 110 / 109 Date 4/10/18 Receipt# #1612298

Other requirements: 24 hr. notice for sewer inspection

Connection made to Sewer Part of jointly-shared private line YES NO  
Storm Drain

Applicant agrees to abide by the above terms, as well as all pertinent ordinances of the City of New Bedford, and such other special rules as the Commissioner of Public Infrastructure and/or City Engineer may deem necessary

Antonio Lemos  
City Engineer

Carmelina DaCosta  
Signature of Property Owner or Representative

INSPECTOR'S REPORT

INSPECTED BY: Antonio Lemos

DATE: 4/11/2018

COMMENTS: OK

New service + go  
Abandonment of septic system.

APPROVED \_\_\_\_\_ DISAPPROVED \_\_\_\_\_

Antonio Lemos

SIGNATURE

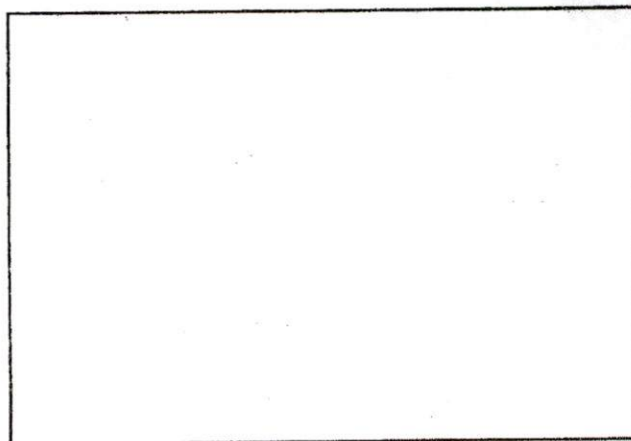

SKETCH PLAN





24574

DATE 4/10/18

This certifies that permission is granted to

Property Owner	Address	Tel.
Carmelina DaCosta	567 Middle St. Houshnet, Mo.	308-336-8732

To connect a sewer and/or storm drain located at 1033 1055 Marlboro St.

Assessor's Plot 132-H Lot 199 to the sewer and/or storm drain in Marlboro St. Street

To be laid in accordance with the conditions in this application and the City of New Bedford ordinances.

TYPE OF USE: RESIDENTIAL COMMERCIAL INDUSTRIAL FLOW G.P.D.

**If applicant other than actual property owner, attach Letter of Authorization from Property Owner.**

Name..... Tel.....

Mailing Address.....

The Bonded Contractor/Drain Layer authorized to perform this work is:

The Bonded Contractor/Team Leader authorized to perform this work is:

Cardoso Contracting

Name	Address	Tel.
------	---------	------

Type of Pipe Required: SDR 35

**PERMIT EXPIRES ONE YEAR AFTER DATE OF ISSUE**

- Requires separate connections for sewage and storm drain where applicable. Storm water cannot be discharged to a sanitary sewer.
- All work must be inspected and approved by a D.P.I. inspector before backfilling.
- If this connection is to be part of a private service shared jointly with other building owners, attach copy of Recorded Joint Maintenance Agreement.
- Permits can be issued to Industrial and/or Commercial Applicants only upon receipt and approval by the Commissioner of Public Infrastructure of required plans and supplemental information.
- In addition, a City-issued Industrial User Discharge Permit and/or a Sewer Extension/Connection Permit issued by the Commonwealth of Massachusetts D.E.P. shall be required by the City for Industrial Discharge into the sewer system.

Industrial User Discharge Permit No. .... Date .....

Comm. Mass. Sewer Conn./Ext. Permit No. .... Date. ....

A Filing and Inspection Fee of \$450.00, plus an Entrance Fee of \$461.25 where applicable, must accompany this application.

Bank# Bank of America Check# 110 / 109 Date 4/10/18 Receipt# 41612298

Other requirements: 24 hr. notice for sewer inspection

Connection made to Sewer Part of jointly-shared private line YES NO  
Storm Drain

**Applicant agrees to abide by the above terms, as well as all pertinent ordinances of the City of New Bedford, and such other special rules as the Commissioner of Public Infrastructure and/or City Engineer may deem necessary**

.....  
City Engineer

.....  
Signature of Property Owner or Representative

## INSPECTOR'S REPORT

INSPECTED BY: \_\_\_\_\_

DATE: \_\_\_\_\_

**COMMENTS:**

APPROVED

DISAPPROVED

**SIGNATURE**

### SKETCH PLAN



CARMELINA DACOSTA

RENTAL PROPERTIES

567 MIDDLE RD

ACUSHNET MA 02743

109

53-13/110 MA

846533

4-16-85

Date

Pay to the

Order of

CITY of New Bedford

\$ 461.25

Four hundred sixty one and 25/100

Dollars



Bank of America

ACH/R/T 011000138

For

*[Signature]*

⑆01⑆000138⑆ 466002228738⑆0109

No. 18-04

FEE \$60.00

# COMMONWEALTH OF MASSACHUSETTS

Board of Health, NEW BEDFORD, MA.

## DISPOSAL SYSTEM CONSTRUCTION PERMIT

Permission is hereby granted to; Construct( ) Repair( ) Upgrade( ) Abandon(☒) an individual sewage disposal system at 1033-1035 Marlboro St New Bedford, MA 02745 as described in the application for Disposal System Construction Permit No. \_\_\_\_\_, dated \_\_\_\_\_.

**Provided:** Construction shall be completed within three years of the date of this permit. All local conditions must be met.

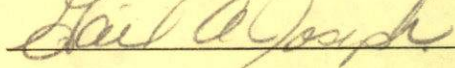
Date 4/9/18 Board of Health 



#1023

#1031

627/6

788

627/4

811

FEET  
22

19

19

19

#1024

FOR  
7 MARLBORO ST

#1032  
23158-06

OTIS STREET

# 23855  
6/30/06

#1059

#1033/1035

#24210  
8/23/10  
#1029/1027

#1025

057

8

MARBORO STREET

439/3

439/

22'

15'

25'

40' →  
439/4

19'

#1060  
23880  
8/14/06

#1058

#1032

↑  
Is this stub  
for #1032

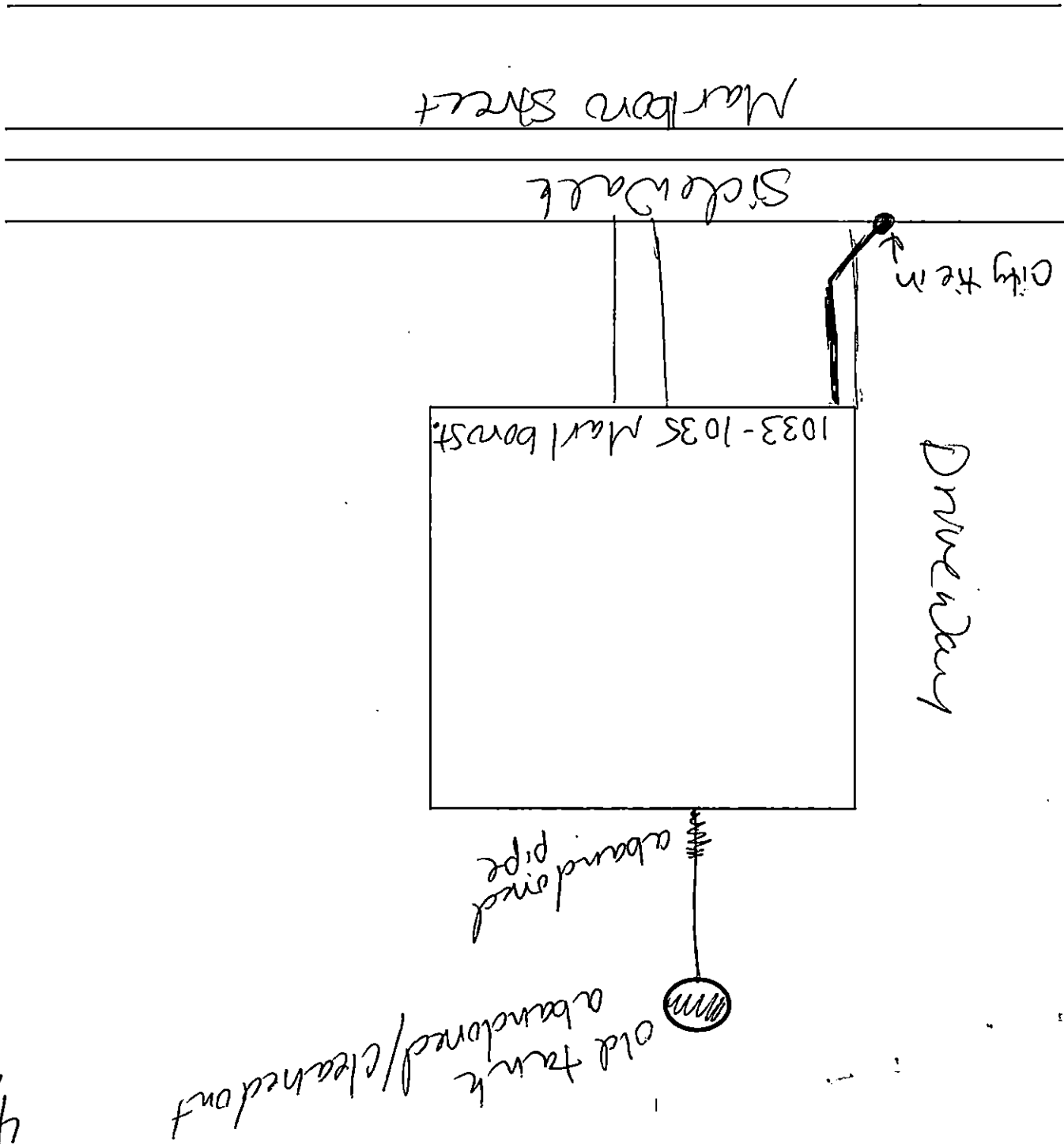

4/10/11