



24573

DATE 4/5/18

Property Owner

Address

Tel.

To connect a sewer and/or storm drain located at: 207 State St. / cap service & install new

Assessor's Plot 78 Lot 199, to the sewer and/or storm drain in 8" sewer on State Street

To be laid in accordance with the conditions in this application and the City of New Bedford ordinances.

TYPE OF USE: RESIDENTIAL COMMERCIAL INDUSTRIAL FLOW _____ G.P.D.

If applicant other than actual property owner, attach Letter of Authorization from Property Owner.

Name.

Tel

Mailing Address.

The Bonded Contractor/Drain Layer authorized to perform this work is:

Name

Address

Tel.

Type of Pipe Required:.....SDR 35.....

PERMIT EXPIRES ONE YEAR AFTER DATE OF ISSUE

- Requires separate connections for sewage and storm drain where applicable. Storm water cannot be discharged to a sanitary sewer.
 - All work must be inspected and approved by a D.P.I. inspector before backfilling.
 - If this connection is to be part of a private service shared jointly with other building owners, attach copy of Recorded Joint Maintenance Agreement.
 - Permits can be issued to Industrial and/or Commercial Applicants only upon receipt and approval by the Commissioner of Public Infrastructure of required plans and supplemental information.
 - In addition, a City-issued Industrial User Discharge Permit and/or a Sewer Extension/Connection Permit issued by the Commonwealth of Massachusetts D.E.P. shall be required by the City for Industrial Discharge into the sewer system.
- Industrial User Discharge Permit No. Date.

Comm. Mass. Sewer Conn./Ext. Permit No. Date.
A Filing and Inspection Fee of \$450., plus an Entrance Fee of \$..... where applicable, must accompany this application.

Bank# Citizen's Bank Check# 2932 Date 4/5/18 Receipt# _____

Other requirements:

Connection made to	Sewer	Part of jointly-shared private line	YES	NO
	Storm Drain			

Applicant agrees to abide by the above terms, as well as all pertinent ordinances of the City of New Bedford, and such other special rules as the Commissioner of Public Infrastructure and/or City Engineer may deem necessary

.....
Manuel H. Silva
 City Engineer
Deputy Commissioner

.....
Michael G. Halset
 Representative

INSPECTOR'S REPORT

INSPECTED BY: SEE WHITE SHEET

DATE:

COMMENTS:

APPROVED

DISAPPRO

SIGNATURE

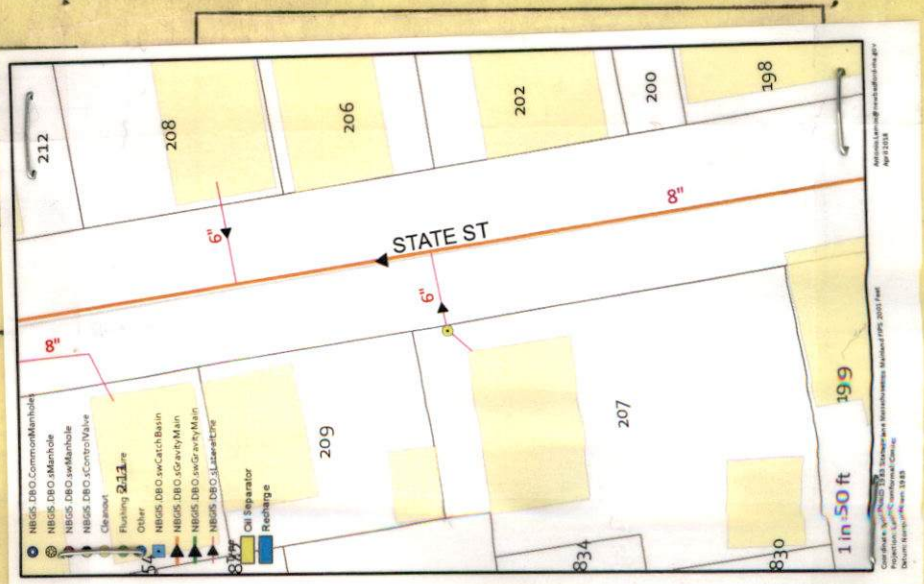



Inspector

Expires

4/5/19

PERMIT NO.

24573

CITY OF NEW BEDFORD
SEWER AND/OR STORM DRAIN PERMIT

DATE 4/5/18

This certifies that permission is granted to

Michael G. Hubert 207 State St. New Bedford Ma. 02746
Property Owner Address Tel. 774-319-3178

To connect a sewer and/or storm drain located at 207 State St/cap service & install new

Assessor's Plot 78 Lot 199, to the sewer and/or storm drain in 8" sewer on State Street

To be laid in accordance with the conditions in this application and the City of New Bedford ordinances.

TYPE OF USE: RESIDENTIAL COMMERCIAL INDUSTRIAL FLOW G.P.D.

If applicant other than actual property owner, attach Letter of Authorization from Property Owner.

Name Tel.

Mailing Address

The Bonded Contractor/Drain Layer authorized to perform this work is:

J.H.C. Construction

Name Address Tel.

Type of Pipe Required: SDR 35

PERMIT EXPIRES ONE YEAR AFTER DATE OF ISSUE

- Requires separate connections for sewage and storm drain where applicable. Storm water cannot be discharged to a sanitary sewer.
 - All work must be inspected and approved by a D.P.I. inspector before backfilling.
 - If this connection is to be part of a private service shared jointly with other building owners, attach copy of Recorded Joint Maintenance Agreement.
 - Permits can be issued to Industrial and/or Commercial Applicants only upon receipt and approval by the Commissioner of Public Infrastructure of required plans and supplemental information.
 - In addition, a City-issued Industrial User Discharge Permit and/or a Sewer Extension/Connection Permit issued by the Commonwealth of Massachusetts D.E.P. shall be required by the City for Industrial Discharge into the sewer system.
- Industrial User Discharge Permit No. Date

Comm. Mass. Sewer Conn./Ext. Permit No. Date

A Filing and Inspection Fee of \$450, plus an Entrance Fee of \$ where applicable, must accompany this application.

Bank# Citizen's Bank Check# 2932 Date 4/5/18 Receipt#

Other requirements: FOR INSPECTION ONLY A 24 HOUR NOTICE IS REQUIRED AND THE CONTRACTOR/APPLICANT IS REQUIRED TO NOTIFY THE D.P.I. @ 508 979-1550 Press 4 Repair PERMIT EXPIRES 1 YEAR

Connection made to Sewer Storm Drain NO

Applicant agrees to abide by the above terms, as well as all pertinent ordinances of the City of New Bedford, and such other special rules as the Commissioner of Public Infrastructure and/or City Engineer may deem necessary

Manuel H. Silva City Engineer
Michael G. Hubert Signature of Property Owner or Representative

INSPECTOR'S REPORT

INSPECTED BY: Antonio Lemos

DATE: 4/10/2018

COMMENTS:

SEWER REPAIR
6" + CO

APPROVED DISAPPROVED

Antonio Lemos

SIGNATURE

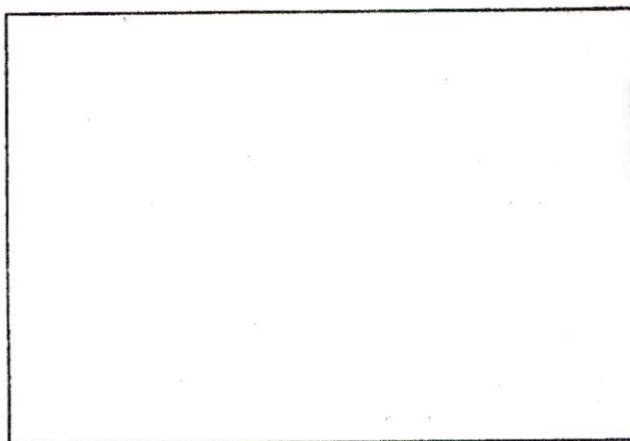

SKETCH PLAN

Work Order Number: 18-005234

4/10/2018
8:28 AM

Category: Service Lateral Gravity Priority: _____
Problem: Locate Request Crew: _____
Cause: _____ Supervisor: STEPHANIE DUPRAS
Main Task: Investigate / Inspect Status: New Work Order
Work Order Start Date/Time: _____ Work Order End Date/Time: _____

Location (s) _____
207 STATE ST

Comments from Request _____
SEWER INSPECTION SCHED FOR 4/10/18 @ 1:00PM, SEWR # 24573 PLOT 78 LOT 199

Task Start Date/Time: _____ Task End Date/Time: _____

Task Code: SWT220 Task Description: Investigate / Inspect

Employee Number	Employee Name	Time Type				Units
		Reg	OT	Normal	Type	
14950	ANTONIO LEMOS	0.00	0.00	0.00	REGULAR TIME	Hours

_____	_____	_____	_____	_____	_____	_____
_____	_____	_____	_____	_____	_____	_____
_____	_____	_____	_____	_____	_____	_____

Equipment Code	Equipment Description	Units
----------------	-----------------------	-------

_____	_____	_____
_____	_____	_____
_____	_____	_____

Material Code	Material Description	Units
---------------	----------------------	-------

_____	_____	_____
_____	_____	_____
_____	_____	_____

Fluid Code	Fluid Description	Units
------------	-------------------	-------

_____	_____	_____
_____	_____	_____
_____	_____	_____