



Expires 2/14/19

PERMIT NO.

24560

CITY OF NEW BEDFORD
SEWER AND/OR STORM DRAIN PERMIT

DATE 2/14/18

This certifies that permission is granted to

Property Owner

Address

Tel.

To connect a sewer and/or storm drain located at

Assessor's Plot 123A Lot 1109, to the sewer and/or storm drain in Cox - 8" PVC main Street

To be laid in accordance with the conditions in this application and the City of New Bedford ordinances.

TYPE OF USE: RESIDENTIAL COMMERCIAL INDUSTRIAL FLOW G.P.D.

If applicant other than actual property owner, attach Letter of Authorization from Property Owner.

Name

Tel.

Mailing Address

The Bonded Contractor/Drain Layer authorized to perform this work is:

Name

Address

Tel.

Type of Pipe Required

PERMIT EXPIRES ONE YEAR AFTER DATE OF ISSUE

- Requires separate connections for sewage and storm drain where applicable. Storm water cannot be discharged to a sanitary sewer.
 - All work must be inspected and approved by a D.P.I. inspector before backfilling.
 - If this connection is to be part of a private service shared jointly with other building owners, attach copy of Recorded Joint Maintenance Agreement.
 - Permits can be issued to Industrial and/or Commercial Applicants only upon receipt and approval by the Commissioner of Public Infrastructure of required plans and supplemental information.
 - In addition, a City-issued Industrial User Discharge Permit and/or a Sewer Extension/Connection Permit issued by the Commonwealth of Massachusetts D.E.P. shall be required by the City for Industrial Discharge into the sewer system.
- Industrial User Discharge Permit No. Date

Comm. Mass. Sewer Conn./Ext. Permit No. Date

A Filing and Inspection Fee of \$441, plus an Entrance Fee of \$50 where applicable, must accompany this application.

Bank# First Citizens Check# 1830/1829 Date 2-14-18 Receipt#

Other requirements:

Connection made to ☒ Sewer ☐ Storm Drain Part of jointly-shared private line YES ☒ NO

Applicant agrees to abide by the above terms, as well as all pertinent ordinances of the City of New Bedford, and such other special rules as the Commissioner of Public Infrastructure and/or City Engineer may deem necessary

City Engineer

Signature of Property Owner or Representative

INSPECTOR'S REPORT

INSPECTED BY: DATE: COMMENTS:

APPROVED

DIS

SIGNATURE

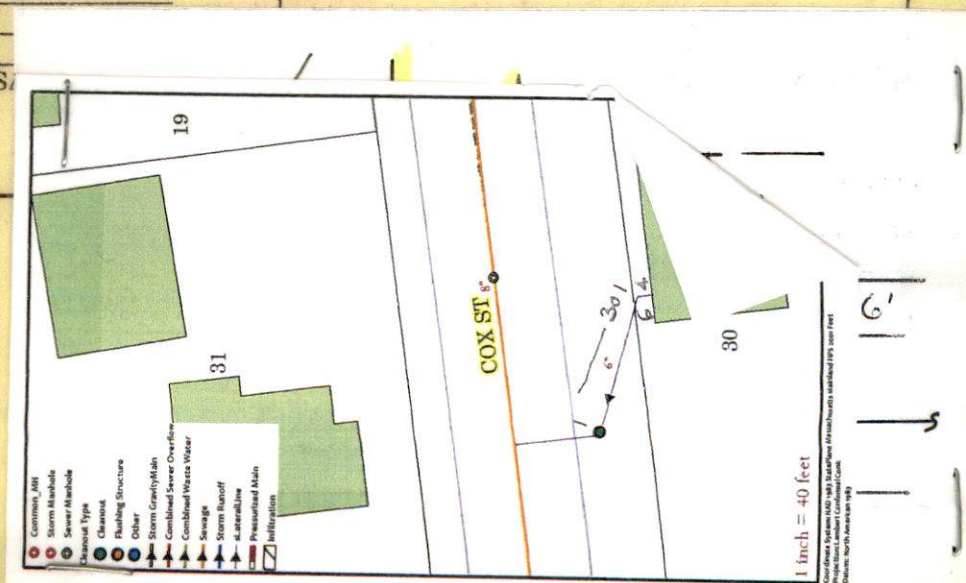

WN-18-10

Expires 2/14/19



PERMIT NO.

24560

CITY OF NEW BEDFORD
SEWER AND/OR STORM DRAIN PERMIT

DATE 2/14/18

This certifies that permission is granted to

Paul Brodeur 30 Cox St (508) 9957490
Property Owner Address Tel.

To connect a sewer and/or storm drain located at 30 Cox Street

Assessor's Plot 123A Lot 169, to the sewer and/or storm drain in Cox - 8" PVC main Street

To be laid in accordance with the conditions in this application and the City of New Bedford ordinances.

TYPE OF USE: RESIDENTIAL COMMERCIAL INDUSTRIAL FLOW G.P.D.

If applicant other than actual property owner, attach Letter of Authorization from Property Owner.

Name N/A Tel.

Mailing Address N/A

The Bonded Contractor/Drain Layer authorized to perform this work is:

Name Demetri Const. Address Tel.

Type of Pipe Required 12" Construction

PERMIT EXPIRES ONE YEAR AFTER DATE OF ISSUE

- Requires separate connections for sewage and storm drain where applicable. Storm water cannot be discharged to a sanitary sewer.
- All work must be inspected and approved by a D.P.I. inspector before backfilling.
- If this connection is to be part of a private service shared jointly with other building owners, attach copy of Recorded Joint Maintenance Agreement.
- Permits can be issued to Industrial and/or Commercial Applicants only upon receipt and approval by the Commissioner of Public Infrastructure of required plans and supplemental information.
- In addition, a City-issued Industrial User Discharge Permit and/or a Sewer Extension/Connection Permit issued by the Commonwealth of Massachusetts D.E.P. shall be required by the City for Industrial Discharge into the sewer system.

Industrial User Discharge Permit No. Date

Comm. Mass. Sewer Conn./Ext. Permit No. Date

A Filing and Inspection Fee of \$441., plus an Entrance Fee of \$50. where applicable, must accompany this application.

Bank# First Citizens Check# 1830/1829 Date 2-14-18 Receipt#

Other requirements: FOR INSPECTION ONLY A 24 HOUR NOTICE IS REQUIRED AND THE CONTRACTOR/APPLICANT IS REQUIRED TO NOTIFY THE D.P.I.

@ 508 979-1550 Press 4 Repair

PERMIT EXPIRES 1 YEAR

Connection made to Sewer

Storm Drain

NO

Applicant agrees to abide by the above terms, as well as all pertinent ordinances of the City of New Bedford, and such other special rules as the Commissioner of Public Infrastructure and/or City Engineer may deem necessary

David M. Amode City Engineer

Admin. Manager

Paul R. Brodeur Signature of Property Owner or Representative

INSPECTOR'S REPORT

INSPECTED BY:

DATE:

COMMENTS:

APPROVED

DISAPPROVED

SIGNATURE

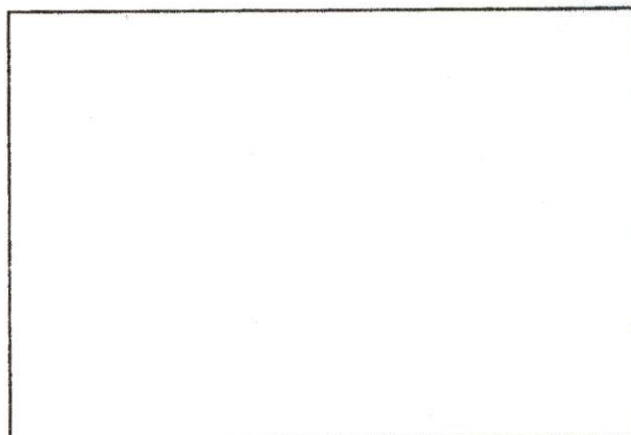

SKETCH PLAN



Expires 2/14/19

PERMIT NO.

24560

CITY OF NEW BEDFORD
SEWER AND/OR STORM DRAIN PERMIT

DATE 2/14/18

This certifies that permission is granted to

Paul Brodeur 30 Cox St (508) 99574190
Property Owner Address Tel.

To connect a sewer and/or storm drain located at 30 Cox Street

Assessor's Plot 123A Lot 1169, to the sewer and/or storm drain in Cox - 8" PVC main Street

To be laid in accordance with the conditions in this application and the City of New Bedford ordinances.

TYPE OF USE: RESIDENTIAL COMMERCIAL INDUSTRIAL FLOW G.P.D.

If applicant other than actual property owner, attach Letter of Authorization from Property Owner.

Name Tel.

Mailing Address N/A

The Bonded Contractor/Drain Layer authorized to perform this work is:

Name Demetri Const. Address Tel.

Type of Pipe Required 8" Construction

PERMIT EXPIRES ONE YEAR AFTER DATE OF ISSUE

- Requires separate connections for sewage and storm drain where applicable. Storm water cannot be discharged to a sanitary sewer.
 - All work must be inspected and approved by a D.P.I. inspector before backfilling.
 - If this connection is to be part of a private service shared jointly with other building owners, attach copy of Recorded Joint Maintenance Agreement.
 - Permits can be issued to Industrial and/or Commercial Applicants only upon receipt and approval by the Commissioner of Public Infrastructure of required plans and supplemental information.
 - In addition, a City-issued Industrial User Discharge Permit and/or a Sewer Extension/Connection Permit issued by the Commonwealth of Massachusetts D.E.P. shall be required by the City for Industrial Discharge into the sewer system.
- Industrial User Discharge Permit No. Date

Comm. Mass. Sewer Conn./Ext. Permit No. Date

A Filing and Inspection Fee of \$441., plus an Entrance Fee of \$450. where applicable, must accompany this application.

Bank# First Citizens Check# 1830/1829 Date 2-14-18 Receipt#

Other requirements: FOR INSPECTION ONLY A 24 HOUR NOTICE IS REQUIRED AND THE CONTRACTOR/APPLICANT IS REQUIRED TO NOTIFY THE D.P.I. @ 508 979-1550 Press 4 Repair PERMIT EXPIRES 1 YEAR

Connection made to Sewer Storm Drain

Applicant agrees to abide by the above terms, as well as all pertinent ordinances of the City of New Bedford, and such other special rules as the Commissioner of Public Infrastructure and/or City Engineer may deem necessary

Antonio Lemos
City Engineer
Admin. Manager

Paul R. Brodeur
Signature of Property Owner or Representative

INSPECTOR'S REPORT

INSPECTED BY: Antonio Lemos
DATE: 2/15/2018
COMMENTS: Abandonment of septic system. AER Service 6" CO
APPROVED DISAPPROVED

Antonio Lemos
SIGNATURE

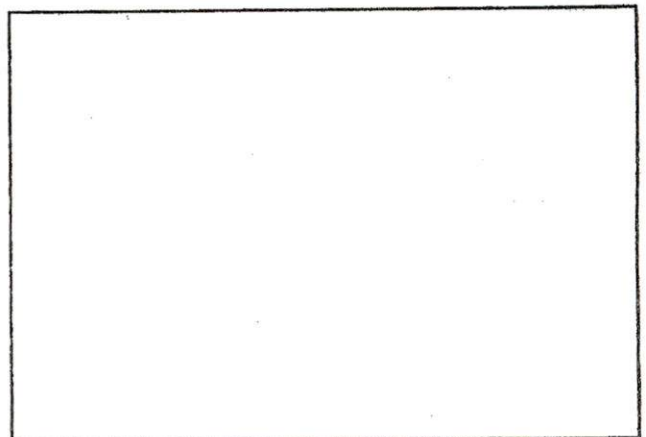

SKETCH PLAN



Expire 2/14/19

PERMIT NO.

24560

CITY OF NEW BEDFORD
SEWER AND/OR STORM DRAIN PERMIT

DATE 2/14/18

This certifies that permission is granted to

Property Owner

Address

Tel.

To connect a sewer and/or storm drain located at

Assessor's Plot Lot, to the sewer and/or storm drain in Street

To be laid in accordance with the conditions in this application and the City of New Bedford ordinances.

TYPE OF USE: RESIDENTIAL COMMERCIAL INDUSTRIAL FLOW G.P.D.

If applicant other than actual property owner, attach Letter of Authorization from Property Owner.

Name

Tel.

Mailing Address

The Bonded Contractor/Drain Layer authorized to perform this work is:

Name

Address

Tel.

Type of Pipe Required:

PERMIT EXPIRES ONE YEAR AFTER DATE OF ISSUE

- Requires separate connections for sewage and storm drain where applicable. Storm water cannot be discharged to a sanitary sewer.
 - All work must be inspected and approved by a D.P.I. inspector before backfilling.
 - If this connection is to be part of a private service shared jointly with other building owners, attach copy of Recorded Joint Maintenance Agreement.
 - Permits can be issued to Industrial and/or Commercial Applicants only upon receipt and approval by the Commissioner of Public Infrastructure of required plans and supplemental information.
 - In addition, a City-issued Industrial User Discharge Permit and/or a Sewer Extension/Connection Permit issued by the Commonwealth of Massachusetts D.E.P. shall be required by the City for Industrial Discharge into the sewer system.
- Industrial User Discharge Permit No. Date

Comm. Mass. Sewer Conn./Ext. Permit No. Date

A Filing and Inspection Fee of \$, plus an Entrance Fee of \$, where applicable, must accompany this application.

Bank# Check# Date Receipt#

Other requirements:

Connection made to Sewer Part of jointly-shared private line YES NO
Storm Drain

Applicant agrees to abide by the above terms, as well as all pertinent ordinances of the City of New Bedford, and such other special rules as the Commissioner of Public Infrastructure and/or City Engineer may deem necessary

City Engineer

Signature of Property Owner or Representative

INSPECTOR'S REPORT

INSPECTED BY:
DATE:
COMMENTS:

APPROVED

DISAPPROVED

SIGNATURE

SKETCH PLAN

Cheveli A. Torres

From: Sarah Porter
Sent: Thursday, July 20, 2017 12:54 PM
To: Cheveli A. Torres
Subject: RE: 30 Cox St

That is all set Cheveli

From: Cheveli A. Torres
Sent: Thursday, July 20, 2017 11:12 AM
To: Sarah Porter
Subject: 30 Cox St

Good Afternoon,

30 Cox Street will be abandoning septic system. Are they ok as far as wet lands. Thank you!

*Cheveli Torres
Department of Public Infrastructure
1105 Shawmut Ave
New Bedford, MA 02745
Principal Clerk
(508) 979-1550 Ext.506*

NUMBER
18-02

2018
THE COMMONWEALTH OF MASSACHUSETTS

FEE
\$60.00

CITY of NEW BEDFORD

Board of Health

This is to Certify that Demetrio Costa- JLC Construction Co Inc
NAME

415 Lake RD, Tiverton, RI 02878
ADDRESS

IS HEREBY GRANTED A "DISPOSAL WORKS INSTALLER'S PERMIT" TO
CONSTRUCT, ALTER, INSTALL, or REPAIR,
Individual Sewage Disposal Systems

This permit is granted in conformity with the State Sanitary Code Title V, Regulation 2.2;
and expires December 31, 2018 unless sooner suspended or revoked.

Feb 14, 2018

WHITE COPY - Original

YELLOW COPY - Board of Health

PINK COPY - Mailed immediately to
Regional Environmental Engineer,
Department of Environmental
Protection.

FORM 1255 A.M. SULKIN CO. - BOSTON, MA

Board
of
Health

Damon O. Chaplin
Damon O. Chaplin, Director

No. 18-02

FEE \$60.00

COMMONWEALTH OF MASSACHUSETTS

Board of Health, NEW BEDFORD, MA.

DISPOSAL SYSTEM CONSTRUCTION PERMIT

Permission is hereby granted to; Construct() Repair() Upgrade() Abandon(X) an individual sewage disposal system
at 30 Cox Street New Bedford MA as described in the application for
Disposal System Construction Permit No. N/A, dated _____.

Provided: Construction shall be completed within three years of the date of this permit. All local conditions must be met.

Form 1255 Rev. 5/96 A.M. Sulkin Co. Boston, MA

Date 2/14/18 Board of Health Heil A Joseph

Work Order Number: 18-002332

2/14/2018
1:39 PM

Category: Service Lateral Gravity Priority: _____
Problem: Locate Request Crew: _____
Cause: _____ Supervisor: STEPHANIE DUPRAS
Main Task: Investigate / Inspect Status: New Work Order
Work Order Start Date/Time: _____ Work Order End Date/Time: _____

Location (s) _____
30 COX ST

Comments from Request _____
SEWER INSPECTION SCHED FOR 2/15/18@11:30AM, (SEWER PERMIT # 24560) (PLOT 123A LOT 169)

Task Start Date/Time: _____ Task End Date/Time: _____

Task Code: SWT220 Task Description: Investigate / Inspect

| Employee Number | Employee Name | Time Type | | | | Units |
|-----------------|---------------|-----------|------|--------|--------------|-------|
| | | Reg | OT | Normal | Type | |
| 14950 | ANTONIO LEMOS | 0.00 | 0.00 | 0.00 | REGULAR TIME | Hours |

| | | | | | | |
|-------|-------|-------|-------|-------|-------|-------|
| _____ | _____ | _____ | _____ | _____ | _____ | _____ |
| _____ | _____ | _____ | _____ | _____ | _____ | _____ |
| _____ | _____ | _____ | _____ | _____ | _____ | _____ |

| Equipment Code | Equipment Description | Units |
|----------------|-----------------------|-------|
|----------------|-----------------------|-------|

| | | |
|-------|-------|-------|
| _____ | _____ | _____ |
| _____ | _____ | _____ |
| _____ | _____ | _____ |

| Material Code | Material Description | Units |
|---------------|----------------------|-------|
|---------------|----------------------|-------|

| | | |
|-------|-------|-------|
| _____ | _____ | _____ |
| _____ | _____ | _____ |
| _____ | _____ | _____ |

| Fluid Code | Fluid Description | Units |
|------------|-------------------|-------|
|------------|-------------------|-------|

| | | |
|-------|-------|-------|
| _____ | _____ | _____ |
| _____ | _____ | _____ |
| _____ | _____ | _____ |

Abandonment of septic system.
New Service.
6" + 20

Antonio Lemos
2/15/2018