



PERMIT NO.

24534

CITY OF NEW BEDFORD
SEWER AND/OR STORM DRAIN PERMIT

DATE 8/18/17

This certifies that permission is granted to

Property Owner

Address

Tel.

To connect a sewer and/or storm drain located at

Assessor's Plot 51 Lot 209 to the sewer and/or storm drain in Sewer 54' x 58' reinforced concrete Street

To be laid in accordance with the conditions in this application and the City of New Bedford ordinances.

TYPE OF USE: RESIDENTIAL COMMERCIAL INDUSTRIAL FLOW G.P.D.

If applicant other than actual property owner, attach Letter of Authorization from Property Owner.

Name

Tel.

Mailing Address

The Bonded Contractor/Drain Layer authorized to perform this work is:

Name

Address

Tel.

Type of Pipe Required:

PERMIT EXPIRES ONE YEAR AFTER DATE OF ISSUE

- Requires separate connections for sewage and storm drain where applicable. Storm water cannot be discharged to a sanitary sewer.
- All work must be inspected and approved by a D.P.I. inspector before backfilling.
- If this connection is to be part of a private service shared jointly with other building owners, attach copy of Recorded Joint Maintenance Agreement.
- Permits can be issued to Industrial and/or Commercial Applicants only upon receipt and approval by the Commissioner of Public Infrastructure of required plans and supplemental information.
- In addition, a City-issued Industrial User Discharge Permit and/or a Sewer Extension/Connection Permit issued by the Commonwealth of Massachusetts D.E.P. shall be required by the City for Industrial Discharge into the sewer system.

Industrial User Discharge Permit No. Date

Comm. Mass. Sewer Conn./Ext. Permit No. Date

A Filing and Inspection Fee of \$450, plus an Entrance Fee of \$ where applicable, must accompany this application.

Bank# Citizens Bank Check# 214 Date 8/18/17 Receipt# 1261688

Other requirements:

Connection made to ☒ Sewer ☐ Storm Drain Part of jointly-shared private line YES NO

Applicant agrees to abide by the above terms, as well as all pertinent ordinances of the City of New Bedford, and such other special rules as the Commissioner of Public Infrastructure and/or City Engineer may deem necessary

City Engineer

Signature of Property Owner or Representative

INSPECTOR'S REPORT

INSPECTED BY: SEE WORK ORDER

DATE: WHITE SLIP

COMMENTS:

APPROVED

DISAPPROVED

SIGNATURE

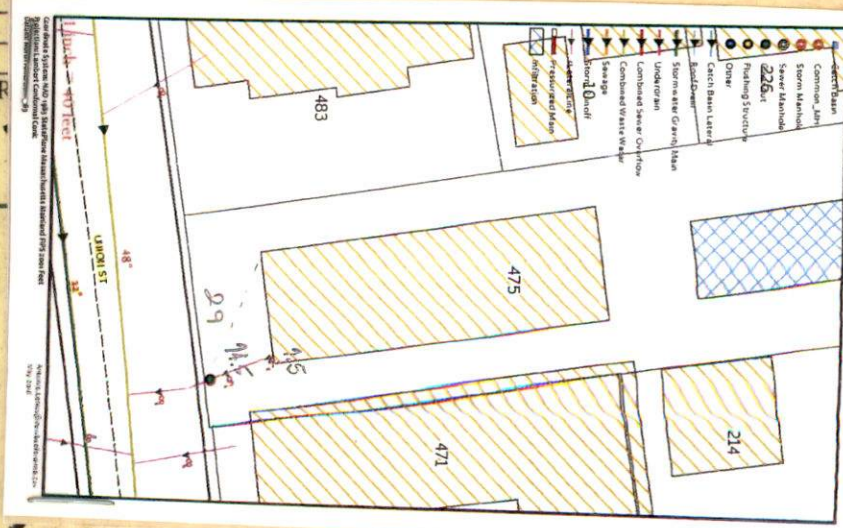

Expires: 8/18/18

PERMIT NO.

24534

CITY OF NEW BEDFORD
SEWER AND/OR STORM DRAIN PERMIT

DATE 8/18/17

This certifies that permission is granted to

Robert Jones

Property Owner

P.O. Box 40714

Address Philadelphia Pennsylvania Tel.

617-719-6789

To connect a sewer and/or storm drain located at Union St (NS) 73' E x Newton St

Assessor's Plot 51 Lot 269, to the sewer and/or storm drain in Sewer 54' x 58' Reinforced concrete Street Union St

To be laid in accordance with the conditions in this application and the City of New Bedford ordinances.

TYPE OF USE: RESIDENTIAL COMMERCIAL INDUSTRIAL FLOW 2 Bedrooms 600 G.P.D.

If applicant other than actual property owner, attach Letter of Authorization from Property Owner.

Name N/A Tel.

Mailing Address

The Bonded Contractor/Drain Layer authorized to perform this work is:

Name PENDING Address Tel.

Type of Pipe Required

PERMIT EXPIRES ONE YEAR AFTER DATE OF ISSUE

NO UTILITIES TO BE INSTALLED
UNTIL PG-CO

- Requires separate connections for sewage and storm drain where applicable. Storm water cannot be discharged to a sanitary sewer.
- All work must be inspected and approved by a D.P.I. inspector before backfilling.
- If this connection is to be part of a private service shared jointly with other building owners, attach copy of Recorded Joint Maintenance Agreement.
- Permits can be issued to Industrial and/or Commercial Applicants only upon receipt and approval by the Commissioner of Public Infrastructure of required plans and supplemental information.
- In addition, a City-issued Industrial User Discharge Permit and/or a Sewer Extension/Connection Permit issued by the Commonwealth of Massachusetts D.E.P. shall be required by the City for Industrial Discharge into the sewer system.

Industrial User Discharge Permit No. Date

Comm. Mass. Sewer Conn./Ext. Permit No. Date

A Filing and Inspection Fee of \$ 4500, plus an Entrance Fee of \$ where applicable, must accompany this application.

Bank# Citizens Bank Check# 214 Date 8/18/17 Receipt# 1261688

Other requirements: FOR INSPECTION ONLY A 24 HOUR

NOTICE IS REQUIRED AND THE

CONTRACTOR/APPLICANT IS

REQUIRED TO NOTIFY THE D.P.I.

at 508 979-1550 Press 3 Repair

Connection made to Sewer NO

Storm Drain

Applicant agrees to abide by the above terms, as well as all pertinent ordinances of the City of New Bedford, and such other special rules as the Commissioner of Public Infrastructure and/or City Engineer may deem necessary

William M. Amadeo

City Engineer

Admin. Manager

Sam M. A

Signature of Property Owner or Representative

Get Robert R. Y. Sur LLC

INSPECTOR'S REPORT

INSPECTED BY: Antonio Jones

DATE: 5/15/2018

COMMENTS:

NEW SERVICE

APPROVED

DISAPPROVED

Paulo Silva

SIGNATURE

SKETCH PLAN

DISPLAY PERMIT IN A CONSPICUOUS PLACE ON THE PREMISES



Commonwealth of Massachusetts

City of New Bedford

133 William Street New Bedford, MA 02740

SEWER PERMIT



Date: 10/13/2017

No. WW-17-32

Sewer Connection Fee: \$450.00

Pipe Size: 0.00

Trench Length: 0.00

Service Location: 475 UNION ST

Owner Name: PREFERRED REALTY SERVICES

Type of Occupancy: Commercial

Type of Work: Sewer - New Sewer Service

Work Description: service# 24534

P.51
L.269

Union St NS 73' E x Newton St

Sewer 54' x 58' Reinforced concrete sewer

expires 8/18/18

No. of Units : 0 Required Design Daily Flow : 0.00 Provided Daily Flow : 0.00

The undersigned petitions you to grant permission to ENTER INTO THE MAIN SEWER and, if such permission is granted, hereby agrees to the following:

1. To abide by the conditions and regulations imposed by the Commissioner of Public Works by statute or by ordinance now in force, or as amended from time to time.
2. That the connection of said sewer with the main sewer shall be inspected by an employee of the department of Public Works or by a designated agent of the Town before burial of said connection.
3. That the work shall at all times be under the direction and control of the Commissioner of Public Works or his authorized agent, and that any expense incurred by the Town shall be charged to the permittee, and said

permittee

agrees to reimburse the Town for said expense.

Installing Company Name: License Type:

Address: City/Town/State:

Call (781) 942-9077 For Inspection

Work Order Number: 18-006932

5/14/2018
3:02 PM

Category: Service Lateral Gravity Priority: _____
Problem: Contractor Inspection Crew: _____
Cause: _____ Supervisor: MANUEL SILVA
Main Task: Investigate / Inspect Status: New Work Order
Work Order Start Date/Time: _____ Work Order End Date/Time: _____

Location (s)

UNION ST

Comments from Request

Union St NS 73' E x Newton St- P.51 L.269 sewer inspection 05/15/18 Tuesday 1pm : Fairhaven Excavating 508-999-6749 Ed

Task Start Date/Time: _____ Task End Date/Time: _____

Task Code: SWT220 Task Description: Investigate / Inspect

Employee Number	Employee Name	Time Type				Units
		Reg	OT	Normal	Type	
14950	ANTONIO LEMOS	0.00	0.00	0.00	REGULAR TIME	Hours

_____	_____	_____	_____	_____	_____	_____
_____	_____	_____	_____	_____	_____	_____
_____	_____	_____	_____	_____	_____	_____

Equipment Code	Equipment Description	Units
----------------	-----------------------	-------

_____	_____	_____
_____	_____	_____
_____	_____	_____

Material Code	Material Description	Units
---------------	----------------------	-------

_____	_____	_____
_____	_____	_____
_____	_____	_____

Fluid Code	Fluid Description	Units
------------	-------------------	-------

_____	_____	_____
_____	_____	_____
_____	_____	_____