



NO YELLOW SHEET

PERMIT NO.

24520

CITY OF NEW BEDFORD
SEWER AND/OR STORM DRAIN PERMIT

DATE 4/20/17

This certifies that permission is granted to

Property Owner: DPM DEVELOPMENT CORP. Address: 70 LAMBERT ST Tel: 508-993-0300

To connect a sewer and/or storm drain located at: 1022 St. August Avenue

Assessor's Plot: 130 Lot: 532, to the sewer and/or storm drain in: ROSA DR. Street

To be laid in accordance with the conditions in this application and the City of New Bedford ordinances.

TYPE OF USE: RESIDENTIAL COMMERCIAL INDUSTRIAL FLOW G.P.D.

If applicant other than actual property owner, attach Letter of Authorization from Property Owner.

Name: Tel:

Mailing Address:

The Bonded Contractor/Drain Layer authorized to perform this work is:

Name: Address: Tel:

Type of Pipe Required: 12" SCH 40 PVC

PERMIT EXPIRES ONE YEAR AFTER DATE OF ISSUE

- Requires separate connections for sewage and storm drain where applicable. Storm water cannot be discharged to a sanitary sewer.
- All work must be inspected and approved by a D.P.I. inspector before backfilling.
- If this connection is to be part of a private service shared jointly with other building owners, attach copy of Recorded Joint Maintenance Agreement.
- Permits can be issued to Industrial and/or Commercial Applicants only upon receipt and approval by the Commissioner of Public Infrastructure of required plans and supplemental information.
- In addition, a City-issued Industrial User Discharge Permit and/or a Sewer Extension/Connection Permit issued by the Commonwealth of Massachusetts D.E.P. shall be required by the City for Industrial Discharge into the sewer system.

Industrial User Discharge Permit No. Date:

Comm. Mass. Sewer Conn./Ext. Permit No. Date:

A Filing and Inspection Fee of \$450, plus an Entrance Fee of \$ where applicable, must accompany this application.

Bank# Webster Bank Check# 7072 Date 4/20/17 Receipt# 11541051

Other requirements: Please contact us at 24 hours for inspection

Connection made to: Sewer Part of jointly-shared private line YES NO
Storm Drain

Applicant agrees to abide by the above terms, as well as all pertinent ordinances of the City of New Bedford, and such other special rules as the Commissioner of Public Infrastructure and/or City Engineer may deem necessary

City Engineer: David M. Amato
Signature of Property Owner or Representative: [Signature]

INSPECTOR'S REPORT

INSPECTED BY: SEE INSPECTION SHEET

DATE:

COMMENTS:

APPROVED

DISAPPROVED

SIGNATURE

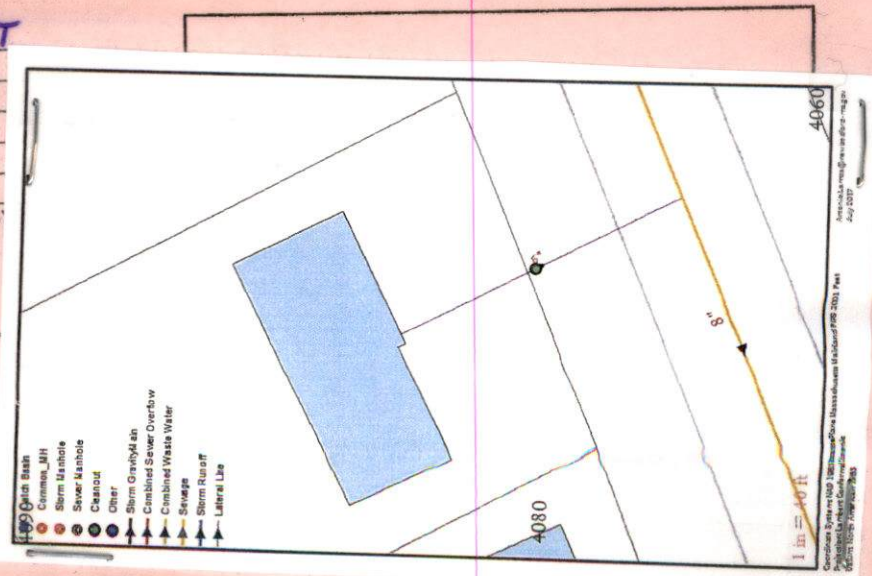



Exp: 6/20/18

PERMIT NO.
24520

CITY OF NEW BEDFORD
SEWER AND/OR STORM DRAIN PERMIT

DATE 6/20/17

This certifies that permission is granted to

Property Owner: DPM Development Corp. Address: 70 Lambert St NB MA 02745 Tel: 508-993-0381

To connect a sewer and/or storm drain located at: Rosa Dr. 142' Ex Acushnet Avenue

Assessor's Plot: 130 Lot: 532, to the sewer and/or storm drain in: Rosa Dr. Street

To be laid in accordance with the conditions in this application and the City of New Bedford ordinances.

TYPE OF USE: RESIDENTIAL COMMERCIAL INDUSTRIAL FLOW G.P.D.

If applicant other than actual property owner, attach Letter of Authorization from Property Owner.

Name: Tel:

Mailing Address:

The Bonded Contractor/Drain Layer authorized to perform this work is:

Name: Address: Tel:

Type of Pipe Required: 4 inch PVC

PERMIT EXPIRES ONE YEAR AFTER DATE OF ISSUE

- Requires separate connections for sewage and storm drain where applicable. Storm water cannot be discharged to a sanitary sewer.
- All work must be inspected and approved by a D.P.I. inspector before backfilling.
- If this connection is to be part of a private service shared jointly with other building owners, attach copy of Recorded Joint Maintenance Agreement.
- Permits can be issued to Industrial and/or Commercial Applicants only upon receipt and approval by the Commissioner of Public Infrastructure of required plans and supplemental information.
- In addition, a City-issued Industrial User Discharge Permit and/or a Sewer Extension/Connection Permit issued by the Commonwealth of Massachusetts D.E.P. shall be required by the City for Industrial Discharge into the sewer system.

Industrial User Discharge Permit No. Date:

Comm. Mass. Sewer Conn./Ext. Permit No. Date:

A Filing and Inspection Fee of \$450 plus an Entrance Fee of \$ where applicable, must accompany this application.

Bank# Webster Bank Check# 7072 Date 6/20/17 Receipt# 1154051

Other requirements: Please contact us w/ 24 hours for inspection

Connection made to: Sewer Part of jointly-shared private line YES NO

Applicant agrees to abide by the above terms, as well as all pertinent ordinances of the City of New Bedford, and such other special rules as the Commissioner of Public Infrastructure and/or City Engineer may deem necessary.

Signature of City Engineer: Admin. Manager

Signature of Property Owner or Representative: Rosa M...

INSPECTOR'S REPORT

INSPECTED BY:

DATE:

COMMENTS:

APPROVED

DISAPPROVED

SIGNATURE

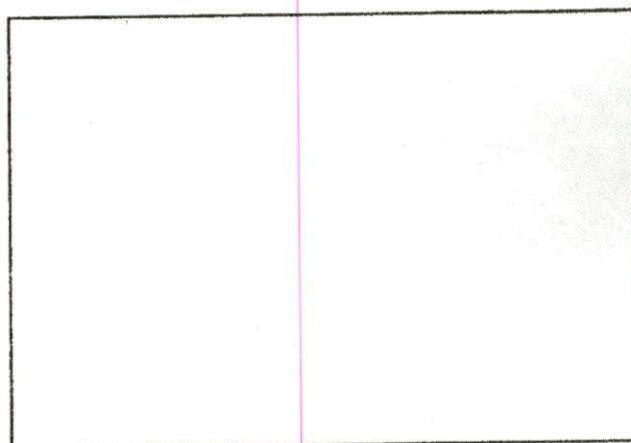

SKETCH PLAN

MAP 136
LOT 249

MAP 136
LOT 283

N 61°40'25" E
87.53'

MAP 136
LOT 532
10,679 S.F.

MAP 136
LOT 248

N 27°03'38" W
123.28'

S 24°34'35" E
128.89'

LOT 2

EXISTING
FOUNDATION
TOF: 138.46'

13.4'

12.2'

8.62'

S 65°25'25" W
82.00'

ROSA DRIVE

AS BUILT FOUNDATION PLAN - MAP 136 LOT 532

ROSA DRIVE
IN
NEW BEDFORD, MA

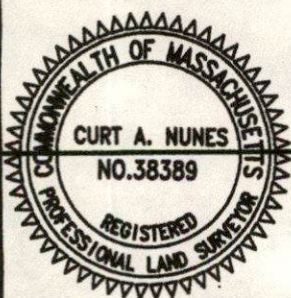

I CERTIFY THAT THE FOUNDATION SHOWN
HEREON, AS BUILT, CONFORMS TO THE CITY
OF NEW BEDFORD ZONING SETBACK
REQUIREMENTS.

[Signature] 6/19/17
PROFESSIONAL LAND SURVEYOR DATE

DATE: JUNE 19, 2017

SCALE: 1" = 20'

ROMANELLI ASSOCIATES INC.

PROFESSIONAL LAND SURVEYORS

1162 Rockdale Ave. New Bedford, MA 02740
Phone (508) 995-0100 - (508) 995-6678

WWW.ROMANELLI-INC.COM



JN 16-088

DISPLAY PERMIT IN A CONSPICUOUS PLACE ON THE PREMISES



Commonwealth of Massachusetts

City of New Bedford

133 William Street New Bedford, MA 02740

SEWER PERMIT



Date: 7/22/2017

No. WW-17-19

Sewer Connection Fee: \$450.00

Pipe Size: 0.00

Trench Length: 0.00

Service Location: NS ROSA DR

Owner Name: DPM DEVELOPMENT CORP

Type of Occupancy: Residential

Type of Work: Sewer - New Sewer Service

Work Description: sewer service #24520

P. 136

L.532

Rosa Dr 162' E x Acushnet Avenue

connecting new sewer service into Rosa Drive

No. of Units : 0 Required Design Daily Flow : 0.00 Provided Daily Flow : 0.00

The undersigned petitions you to grant permission to ENTER INTO THE MAIN SEWER and, if such permission is granted, hereby agrees to the following:

1. To abide by the conditions and regulations imposed by the Commissioner of Public Works by statute or by ordinance now in force, or as amended from time to time.
2. That the connection of said sewer with the main sewer shall be inspected by an employee of the department of Public Works or by a designated agent of the Town before burial of said connection.
3. That the work shall at all times be under the direction and control of the Commissioner of Public Works or his authorized agent, and that any expense incurred by the Town shall be charged to the permittee, and said

permittee

agrees to reimburse the Town for said expense.

Installing Company Name: Robert J. Canessa

License Type: DPI - Other

Address: P. O. Box 51643

City/Town/State: New Bedford

MA

Call (781) 942-9077 For Inspection

Work Order Number: 17-008287

7/11/2017
3:39 PM

Category: Service Lateral Gravity Priority:
Problem: Contractor Inspection Crew:
Cause: Supervisor: STEPHANIE DUPRAS
Main Task: Investigate / Inspect Status: New Work Order
Work Order Start Date/Time: Work Order End Date/Time:

Location (s)

ROSA DR

Comments from Request

Rosa Dr 162' E x Acushnet Avenue: Sewer Inspection 11:00 AM Wednesday ; RJ CANESSA

Task Start Date/Time: Task End Date/Time:

Task Code: SWT220 Task Description: Investigate / Inspect

Employee Number	Employee Name	Time Type				Units
		Reg	OT	Normal	Type	
14950	ANTONIO LEMOS	0.00	0.00	0.00	REGULAR TIME	Hours

Equipment Code	Equipment Description	Units
----------------	-----------------------	-------

Material Code	Material Description	Units
---------------	----------------------	-------

Fluid Code	Fluid Description	Units
------------	-------------------	-------



PERMIT NO.
24520

CITY OF NEW BEDFORD
SEWER AND/OR STORM DRAIN PERMIT

Inspector 11:00AM 7/11/17
Exp: 6/20/18
DATE 6/20/17

This certifies that permission is granted to

DPM Development Corp. 70 Lambeth St NB MA 02745 508-993-038
Property Owner Address Tel.

To connect a sewer and/or storm drain located at... Rosa Dr. 102' Ex Acushnet Avenue

Assessor's Plot 130 Lot 532, to the sewer and/or storm drain in... Rosa Dr. Street

To be laid in accordance with the conditions in this application and the City of New Bedford ordinances.

TYPE OF USE: RESIDENTIAL COMMERCIAL INDUSTRIAL FLOW G.P.D.

If applicant other than actual property owner, attach Letter of Authorization from Property Owner.

Name Tel.

Mailing Address

The Bonded Contractor/Drain Layer authorized to perform this work is:

Name Address Tel.

Type of Pipe Required: 4 inch PVC

PERMIT EXPIRES ONE YEAR AFTER DATE OF ISSUE

- Requires separate connections for sewage and storm drain where applicable. Storm water cannot be discharged to a sanitary sewer.
- All work must be inspected and approved by a D.P.I. inspector before backfilling.
- If this connection is to be part of a private service shared jointly with other building owners, attach copy of Recorded Joint Maintenance Agreement.
- Permits can be issued to Industrial and/or Commercial Applicants only upon receipt and approval by the Commissioner of Public Infrastructure of required plans and supplemental information.
- In addition, a City-issued Industrial User Discharge Permit and/or a Sewer Extension/Connection Permit issued by the Commonwealth of Massachusetts D.E.P. shall be required by the City for Industrial Discharge into the sewer system.

Industrial User Discharge Permit No. Date

Comm. Mass. Sewer Conn./Ext. Permit No. Date

A Filing and Inspection Fee of \$450 plus an Entrance Fee of \$ where applicable, must accompany this application.

Bank# Webster Bank Check# 7072 Date 6/20/17 Receipt# 1154051

Other requirements: Please contact us w/ 24 hours for inspection

Connection made to Sewer Part of jointly-shared private line YES NO
Storm Drain

Applicant agrees to abide by the above terms, as well as all pertinent ordinances of the City of New Bedford, and such other special rules as the Commissioner of Public Infrastructure and/or City Engineer may deem necessary.

David M. Amato
City Engineer
Admin. Manager

Rosa Mon
Signature of Property Owner or Representative

INSPECTOR'S REPORT

INSPECTED BY: Antonio Lemos
DATE: 7/11/17
COMMENTS: OK

APPROVED DISAPPROVED
New Service

Antonio Lemos
SIGNATURE

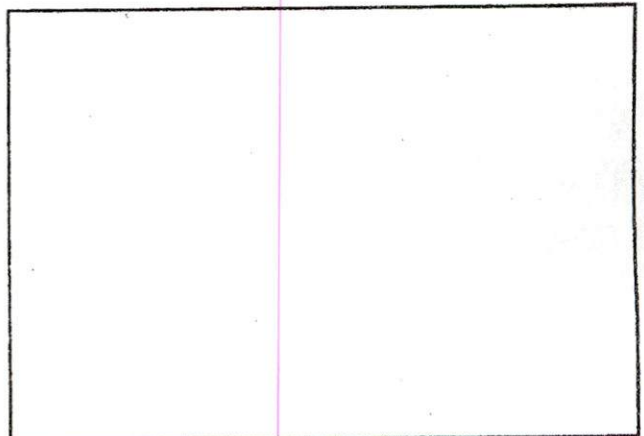

SKETCH PLAN