



Expiry 1/10/18

PERMIT NO.  
**24502**

CITY OF NEW BEDFORD  
SEWER AND/OR STORM DRAIN PERMIT

DATE 1/10/17

This certifies that permission is granted to

*Hammond Trust* Property Owner Eric Medeiros Address 601 Hathaway Rd Dartmouth, MA, 02547 Tel. (508) 394-1503

To connect a sewer and/or storm drain located at (S.S.) 310' W x M4 Pleasant St

Assessor's Plot 133A Lot 246-250 to the sewer and/or storm drain in 6" SDR 35 Sewer existing Street Hammond St 8' sewer

To be laid in accordance with the conditions in this application and the City of New Bedford ordinances.  
TYPE OF USE: RESIDENTIAL COMMERCIAL INDUSTRIAL FLOW 330 G.P.D.

If applicant other than actual property owner, attach Letter of Authorization from Property Owner.  
Name \_\_\_\_\_ Tel. \_\_\_\_\_  
Mailing Address \_\_\_\_\_

The Bonded Contractor/Drain Layer authorized to perform this work is:

Name \_\_\_\_\_ Address \_\_\_\_\_ Tel. \_\_\_\_\_  
Type of Pipe Required: SDR 35 PVC

PERMIT EXPIRES ONE YEAR AFTER DATE OF ISSUE

- Requires separate connections for sewage and storm drain where applicable. Storm water cannot be discharged to a sanitary sewer.
- All work must be inspected and approved by a D.P.I. inspector before backfilling.
- If this connection is to be part of a private service shared jointly with other building owners, attach copy of Recorded Joint Maintenance Agreement.
- Permits can be issued to Industrial and/or Commercial Applicants only upon receipt and approval by the Commissioner of Public Infrastructure of required plans and supplemental information.
- In addition, a City-issued Industrial User Discharge Permit and/or a Sewer Extension/Connection Permit issued by the Commonwealth of Massachusetts D.E.P. shall be required by the City for Industrial Discharge into the sewer system.

Industrial User Discharge Permit No. \_\_\_\_\_ Date \_\_\_\_\_

Comm. Mass. Sewer Conn./Ext. Permit No. \_\_\_\_\_ Date \_\_\_\_\_

A Filing and Inspection Fee of \$ 450, plus an Entrance Fee of \$ \_\_\_\_\_ where applicable, must accompany this application.

Bank# Bank 5 Check# 1580 Date 1/10/17 Receipt# 863540

Other requirements: \_\_\_\_\_

Connection made to Sewer Part of jointly-shared private line YES NO  
Storm Drain

Applicant agrees to abide by the above terms, as well as all pertinent ordinances of the City of New Bedford, and such other special rules as the Commissioner of Public Infrastructure and/or City Engineer may deem necessary

X. Norman Amadio City Engineer X. [Signature] Signature of Property Owner or Representative  
*Clerk of the Works*

INSPECTOR'S REPORT

INSPECTED BY: \_\_\_\_\_  
DATE: \_\_\_\_\_  
COMMENTS: \_\_\_\_\_

APPROVED \_\_\_\_\_ DISAPPROVED \_\_\_\_\_  
SEE WHITE SHEET  
SIGNATURE

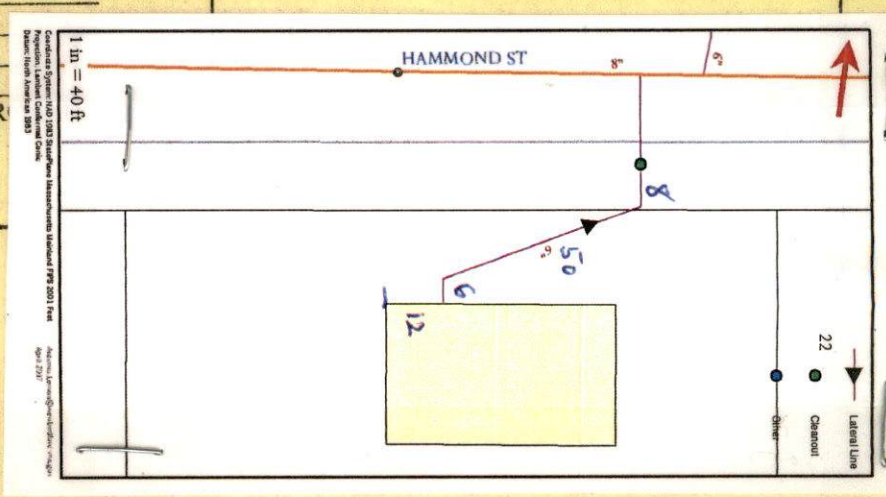





PERMIT NO.

24502

CITY OF NEW BEDFORD  
SEWER AND/OR STORM DRAIN PERMIT

DATE 1/10/17

This certifies that permission is granted to

Eric Medeiros / Hammond Trust  
Property Owner  
60A Hathaway Rd  
Address DARTMOUTH MA, 02747  
Tel. (508) 394-1503

To connect a sewer and/or storm drain located at (SS) 310' W x N4 Pleasant St

Assessor's Plot 123A Lot 246-250 to the sewer and/or storm drain in 6" SDR 35 sewer existing Street  
Hammond St 8' sewer

To be laid in accordance with the conditions in this application and the City of New Bedford ordinances.

TYPE OF USE: RESIDENTIAL COMMERCIAL INDUSTRIAL FLOW 330 G.P.D.

If applicant other than actual property owner, attach Letter of Authorization from Property Owner.

Name: Carvessa Tel.:

Mailing Address:

The Bonded Contractor/Drain Layer authorized to perform this work is:

Name Address Tel.

Type of Pipe Required: SDR 35 PVC

PERMIT EXPIRES ONE YEAR AFTER DATE OF ISSUE

- Requires separate connections for sewage and storm drain where applicable. Storm water cannot be discharged to a sanitary sewer.
  - All work must be inspected and approved by a D.P.I. inspector before backfilling.
  - If this connection is to be part of a private service shared jointly with other building owners, attach copy of Recorded Joint Maintenance Agreement.
  - Permits can be issued to Industrial and/or Commercial Applicants only upon receipt and approval by the Commissioner of Public Infrastructure of required plans and supplemental information.
  - In addition, a City-issued Industrial User Discharge Permit and/or a Sewer Extension/Connection Permit issued by the Commonwealth of Massachusetts D.E.P. shall be required by the City for Industrial Discharge into the sewer system.
- Industrial User Discharge Permit No. Date

Comm. Mass. Sewer Conn./Ext. Permit No. Date

A Filing and Inspection Fee of \$450, plus an Entrance Fee of \$ where applicable, must accompany this application.

Bank# Bank 5 Check# 1580 Date 1/10/17 Receipt# 863540

Other requirements: 1 FOR INSPECTION ONLY A 24 HOUR NOTICE IS REQUIRED AND THE CONTRACTOR/APPLICANT IS REQUIRED TO NOTIFY THE D.P.I. @ 508 979-1550 Press 7 Repair

Connection made to Sewer Storm Drain ES NO

Applicant agrees to abide by the above terms, as well as all pertinent ordinances of the City of New Bedford, and such other special rules as the Commissioner of Public Infrastructure and/or City Engineer may deem necessary

X. Person Amade City Engineer  
Clerk of the Works  
Signature of Property Owner or Representative

INSPECTOR'S REPORT

INSPECTED BY: Antonio Lemos  
DATE:  
COMMENTS:

1/12/2017  
APPROVED DISAPPROVED

Antonio Paulo Lemos  
SIGNATURE

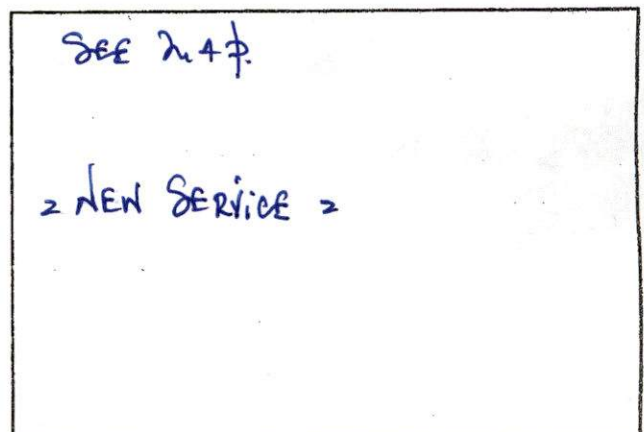

SKETCH PLAN



Expires 1/10/18

17-2



PERMIT NO.  
24502

CITY OF NEW BEDFORD  
SEWER AND/OR STORM DRAIN PERMIT

DATE 1/10/17

This certifies that permission is granted to

Hammond Trust Eric Medeiros Property Owner  
Address 60A Hathaway Rd Dartmouth MA, 02747  
Tel. (508) 394-1503

To connect a sewer and/or storm drain located at (S.S.) 310' W x Mt Pleasant St

Assessor's Plot B3A Lot 246-250 to the sewer and/or storm drain in 6" SDR 35 sewer existing Street Hammond St 8' sewer

To be laid in accordance with the conditions in this application and the City of New Bedford ordinances.

TYPE OF USE: RESIDENTIAL COMMERCIAL INDUSTRIAL FLOW 330 G.P.D.

If applicant other than actual property owner, attach Letter of Authorization from Property Owner.

Name C. Vessal Tel.

Mailing Address

The Bonded Contractor/Drain Layer authorized to perform this work is:

Name Address Tel.

Type of Pipe Required: SDR 35 PVC

PERMIT EXPIRES ONE YEAR AFTER DATE OF ISSUE

- Requires separate connections for sewage and storm drain where applicable. Storm water cannot be discharged to a sanitary sewer.
- All work must be inspected and approved by a D.P.I. inspector before backfilling.
- If this connection is to be part of a private service shared jointly with other building owners, attach copy of Recorded Joint Maintenance Agreement.
- Permits can be issued to Industrial and/or Commercial Applicants only upon receipt and approval by the Commissioner of Public Infrastructure of required plans and supplemental information.
- In addition, a City-issued Industrial User Discharge Permit and/or a Sewer Extension/Connection Permit issued by the Commonwealth of Massachusetts D.E.P. shall be required by the City for Industrial Discharge into the sewer system.

Industrial User Discharge Permit No. Date

Comm. Mass. Sewer Conn./Ext. Permit No. Date

A Filing and Inspection Fee of \$450, plus an Entrance Fee of \$ where applicable, must accompany this application.

Bank# Bank 5 Check# 1580 Date 1/10/17 Receipt# 863540

Other requirements: 1 FOR INSPECTION ONLY A 24 HOUR NOTICE IS REQUIRED AND THE CONTRACTOR/APPLICANT IS REQUIRED TO NOTIFY THE D.P.I. @ 508 979-1550 Press 3 Repair

Connection made to Sewer Storm Drain ES NO

Applicant agrees to abide by the above terms, as well as all pertinent ordinances of the City of New Bedford, and such other special rules as the Commissioner of Public Infrastructure and/or City Engineer may deem necessary

City Engineer Clerk of the Works  
Signature of Property Owner or Representative

INSPECTOR'S REPORT

INSPECTED BY:  
DATE:  
COMMENTS:

APPROVED DISAPPROVED

SIGNATURE

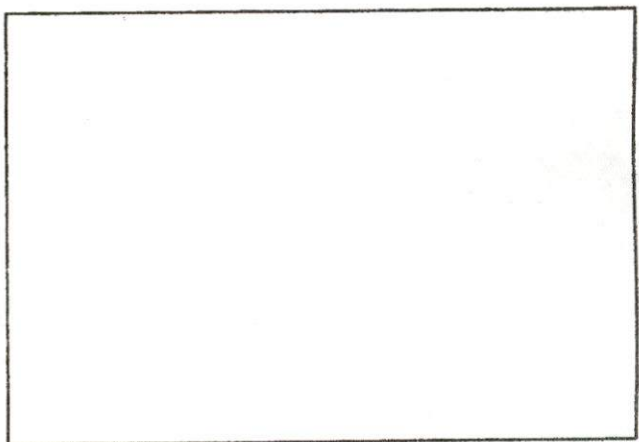

SKETCH PLAN



**DISPLAY PERMIT IN A CONSPICUOUS PLACE ON THE PREMISES**



Commonwealth of Massachusetts

**City of New Bedford**

133 William Street New Bedford, MA 02740

**SEWER PERMIT**



Date: **2/15/2017**

No. **WW-17-2**

Sewer Connection Fee: **\$450.00**

Pipe Size: **0.00**

Trench Length: **0.00**

Service Location: **SS HAMMOND ST**

Owner Name: **ROSS J ARTHUR ROSS ROSA M**

Type of Occupancy: **Residential**

Type of Work: **Sewer - New Sewer Service**

Work Description: **sewer #24502**

**SS 310' W x Mt.Pleasant St**

**using existing service, had to pay permit fees**

**old water service #22975/ 33926**

No. of Units : **0** Required Design Daily Flow : **0.00** Provided Daily Flow : **0.00**

The undersigned petitions you to grant permission to ENTER INTO THE MAIN SEWER and, if such permission is granted, hereby agrees to the following:

1. To abide by the conditions and regulations imposed by the Commissioner of Public Works by statute or by ordinance now in force, or as amended from time to time.
2. That the connection of said sewer with the main sewer shall be inspected by an employee of the department of Public Works or by a designated agent of the Town before burial of said connection.
3. That the work shall at all times be under the direction and control of the Commissioner of Public Works or his authorized agent, and that any expense incurred by the Town shall be charged to the permittee, and said

permittee

agrees to reimburse the Town for said expense.

Installing Company Name: **Robert J. Canessa**

License Type: **CSL-DM**  
**Residential**  
**Demolition Only**

Address: **P. O. Box 51643** City/Town/State: **New Bedford MA**

**Call (781) 942-9077 For Inspection**

2016 00029229  
Bk: 11907 Pg: 74 Pg: 1 of 2 BS  
Doc: DEED 11/30/2016 10:23 AM

## QUITCLAIM DEED

MASSACHUSETTS EXCISE TAX  
Bristol ROD South 001  
Date: 11/30/2016 10:23 AM  
Ctrl# 02000026354 Doc# 00029229  
Fee: \$328.32 Cons: \$72,000.00

24 HAMMOND STREET  
NEW BEDFORD, MA

J. ARTHUR ROSS & ROSA M. ROSS, 106 James Street, Acushnet, MA 02743 for consideration paid and in full consideration of Seventy-Two Thousand and 00/100 (\$ 72,000.00) Dollars

grant to ERIC MEDEIROS, TRUSTEE OF DP HAMMOND STREET REALTY TRUST, w/d/t dated November 30, 2016 and recorded herewith, 6A Hathaway Road, Dartmouth, Massachusetts, 02747, the property hereinafter described

with *Quitclaim Covenants*

The land, with buildings thereon, in New Bedford, Bristol County, Massachusetts, more fully described as:

### PARCEL ONE

Beginning at a point in the south line of Hammond Street, 240 feet west of the west line of Mt. Pleasant Street; thence running Southerly 84.90 feet; thence Westerly 60 feet; thence Northerly 84.90 feet to said south line of Hammond Street; and thence Easterly in said south line of Hammond Street 60 feet to the place of beginning.

Being Lots numbered 299, 300, and 301 on plan of Nash Villa dated April 1913 on file with Bristol County S.D. Registry of Deeds Plan Book 11 Page 42.

### PARCEL TWO

Lots numbered 304 and 305 on plan of Nash Villa, Section 1, filed in Bristol County S.D. Registry of Deeds in Plan Book 11 Page 42. To which reference may be had for particular description.

### PARCEL THREE

A lot of land located on the south side of Hammond Street being Plat 123A, Lot 249 and 250, containing 3396 square feet more or less, according to the 1959 plan on file in the Assessors Office, New Bedford, Massachusetts.

For Our Title see Deed of Joseph Correia and Rosalina B. Correia, dated October 26, 1990, and recorded with said Registry in Book 2561 Page 175.

Return to  
ATTY Matthew P. Thomas  
4 Park Place, Ste 101  
New Bedford MA  
02740

WITNESS our hands and seals this 30<sup>th</sup> day of November, 2016.

J. Arthur Ross  
J. ARTHUR ROSS

[Signature]  
Witness to Both RED C. NGO

Rosa M. Ross  
ROSA M. ROSS

**Commonwealth of Massachusetts**

BRISTOL, SS

On this 30<sup>th</sup> day of November, 2016, before me, the undersigned notary public, personally appeared J. ARTHUR ROSS, whose identity was proved to me through a Massachusetts Driver's Licenses to be the person whose name is signed on the preceding or attached document, and acknowledged to me that the signatory signed it voluntarily as his free act and deed



[Signature]  
MATTHEW J. THOMAS, ESQ.  
NOTARY PUBLIC  
MY COMMISSION EXPIRES: 8/17/23

**Commonwealth of Massachusetts**

BRISTOL, SS

On this 30<sup>th</sup> day of November, 2016, before me, the undersigned notary public, personally appeared ROSA M. ROSS, whose identity was proved to me through a Massachusetts Driver's Licenses to be the person whose name is signed on the preceding or attached document, and acknowledged to me that the signatory signed it voluntarily as her free act and deed



[Signature]  
MATTHEW J. THOMAS, ESQ.  
NOTARY PUBLIC  
MY COMMISSION EXPIRES: 8/17/23

Work Order Number: 17-000378

1/11/2017  
2:33 PM

Category: Water Service Priority: \_\_\_\_\_  
 Problem: Locate Request Crew: \_\_\_\_\_  
 Cause: \_\_\_\_\_ Supervisor: MANUEL SILVA  
 Main Task: Inspect Status: New Work Order  
 Work Order Start Date/Time: \_\_\_\_\_ Work Order End Date/Time: \_\_\_\_\_

Location (s) \_\_\_\_\_  
 HAMMOND ST

Comments from Request \_\_\_\_\_  
 sewer inspection 1/12/17 @ 1:00pm

Task Start Date/Time: \_\_\_\_\_ Task End Date/Time: \_\_\_\_\_

Task Code: WDT300 Task Description: Inspect

Employee Number	Employee Name	Time Type				Units
		Reg	OT	Normal	Type	
14950	ANTONIO LEMOS	0.00	0.00	0.00	REGULAR TIME	Hours
1/12/2017		1/2				
1/12/2017		1/2				

Equipment Code	Equipment Description	Units

Material Code	Material Description	Units

Fluid Code	Fluid Description	Units



