

PERMIT NO.

CITY OF NEW BEDFORD  
SEWER AND/OR STORM DRAIN PERMIT

DATE 11/17/17

This certifies that permission is granted to

Property Owner

Address

Tel.

To connect a sewer and/or storm drain located at Emery St (N.S.) Block on Freeman Plackett

Assessor's Plot 13 Lot 3+122 to the sewer and/or storm drain in Emery St Street

To be laid in accordance with the conditions in this application and the City of New Bedford ordinances.

TYPE OF USE: RESIDENTIAL COMMERCIAL INDUSTRIAL FLOW G.P.D.

If applicant other than actual property owner, attach Letter of Authorization from Property Owner.

Name

Tel.

Mailing Address

The Bonded Contractor/Drain Layer authorized to perform this work is:

Name

Address

Tel.

Type of Pipe Required:

PERMIT EXPIRES ONE YEAR AFTER DATE OF ISSUE

- Requires separate connections for sewage and storm drain where applicable. Storm water cannot be discharged to a sanitary sewer.
- All work must be inspected and approved by a D.P.I. inspector before backfilling.
- If this connection is to be part of a private service shared jointly with other building owners, attach copy of Recorded Joint Maintenance Agreement.
- Permits can be issued to Industrial and/or Commercial Applicants only upon receipt and approval by the Commissioner of Public Infrastructure of required plans and supplemental information.
- In addition, a City-issued Industrial User Discharge Permit and/or a Sewer Extension/Connection Permit issued by the Commonwealth of Massachusetts D.E.P. shall be required by the City for Industrial Discharge into the sewer system.

Industrial User Discharge Permit No. Date

Comm. Mass. Sewer Conn./Ext. Permit No. Date

A Filing and Inspection Fee of \$, plus an Entrance Fee of \$, where applicable, must accompany this application.

Bank# WIA Check# N/C Date Receipt#

Other requirements: Please contact us with 24

Connection made to Sewer Part of jointly-shared private line YES NO  
Storm Drain

Applicant agrees to abide by the above terms, as well as all pertinent ordinances of the City of New Bedford, and such other special rules as the Commissioner of Public Infrastructure and/or City Engineer may deem necessary

City Engineer

Signature of Property Owner or Representative

INSPECTOR'S REPORT

INSPECTED BY:

DATE:

COMMENTS:

APPROVED

DIS

SEE INSPEC WORK ORDER  
SIGNATURE

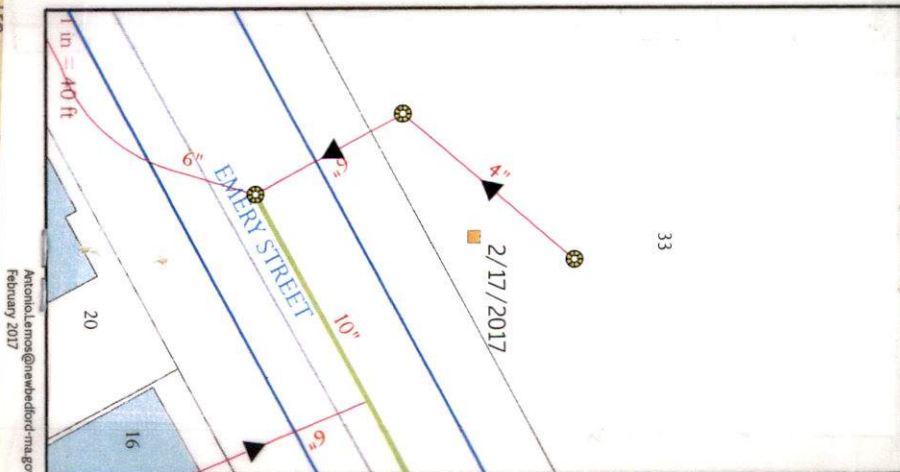



HANAGAN 24498A Schwal

PERMIT NO.



CITY OF NEW BEDFORD  
SEWER AND/OR STORM DRAIN PERMIT

exp: 11/17/17  
DATE 11/17/16

This certifies that permission is granted to

al Oliveria 250 Parker St  
Property Owner Address Tel.

To connect a sewer and/or storm drain located at Emery St (N.S) Btwn Freeman & Brackett

Assessor's Plot 13 Lot 3+122 to the sewer and/or storm drain in Emma Emery St Street

To be laid in accordance with the conditions in this application and the City of New Bedford ordinances.

TYPE OF USE: RESIDENTIAL COMMERCIAL INDUSTRIAL FLOW G.P.D.

If applicant other than actual property owner, attach Letter of Authorization from Property Owner.

Name Tel.

Mailing Address

The Bonded Contractor/Drain Layer authorized to perform this work is:

Name Address Tel.

Type of Pipe Required: RI CON PVC 6 inch

PERMIT EXPIRES ONE YEAR AFTER DATE OF ISSUE

- Requires separate connections for sewage and storm drain where applicable. Storm water cannot be discharged to a sanitary sewer.
- All work must be inspected and approved by a D.P.I. inspector before backfilling.
- If this connection is to be part of a private service shared jointly with other building owners, attach copy of Recorded Joint Maintenance Agreement.
- Permits can be issued to Industrial and/or Commercial Applicants only upon receipt and approval by the Commissioner of Public Infrastructure of required plans and supplemental information.
- In addition, a City-issued Industrial User Discharge Permit and/or a Sewer Extension/Connection Permit issued by the Commonwealth of Massachusetts D.E.P. shall be required by the City for Industrial Discharge into the sewer system.

Industrial User Discharge Permit No. Date

Comm. Mass. Sewer Conn./Ext. Permit No. N/A Date

A Filing and Inspection Fee of \$ plus an Entrance Fee of \$ where applicable, must accompany this application.

Bank# N/A Check# N/C- Date Receipt#

Other requirements: Please Contact us with 24 hours for inspection

Connection made to Sewer Storm Drain Part of jointly-shared private line YES NO

Applicant agrees to abide by the above terms, as well as all pertinent ordinances of the City of New Bedford, and such other special rules as the Commissioner of Public Infrastructure and/or City Engineer may deem necessary

City Engineer Clerk of the Works Signature of Property Owner or Representative

INSPECTOR'S REPORT

INSPECTED BY:

DATE:

COMMENTS:

APPROVED

DISAPPROVED

SIGNATURE

SKETCH PLAN



Department of Public Infrastructure

Ronald H. Labelle  
Commissioner

CITY OF NEW BEDFORD

Jonathan F. Mitchell, Mayor

Water  
Wastewater  
Highways  
Engineering  
Cemetery

To Whom It May Concern:

I AL OLIVEIRA, 256 PARKER STREET, being  
(Name) (Mailing Address)

Owner of property located at

33 EMERY STREET, NEW BEDFORD, MA

Plot 13, Lot 3+122, hereby agree to allow RICON  
(Name)

PO Box 8137 CUNNINGHAM RE 02920 act on my behalf including affixing my  
(Mailing Address)

signature in securing permit for:

|          |                               |
|----------|-------------------------------|
| <u>X</u> | Sewer/Drain Service Permits   |
| <u>X</u> | Water Service Permits         |
| <u>X</u> | Driveway Installation Permits |
| <u>X</u> | Sidewalk Installation Permits |

I further agree to conform to, and abide by, All City rules and ask regulations applicable to the permit (s) being applied for:

Name [Signature] NEW BEDFORD PUBLIC SCHOOL  
Signature  
256 PARKER STREET, N.B. MA  
Address  
14 NOV 2016 508-997-4511 x2296  
Date Telephone number





Commonwealth of Massachusetts

# CITY OF NEW BEDFORD

City Hall, Room 308, 133 William Street New Bedford, MA 02740 (508) 979-1540



## FOUNDATION PERMIT

9/9/2016

No. **B-16-1951**

MSBC Sect. 111.8 - Any permit issued shall be deemed abandoned and invalid unless the work authorized by it shall have been commenced within six (6) months after its issuance.

FEE PAID \$0.00

This certifies that **David R. Martel**

owner/contractor has permission to: **33 EMERY ST**

on: **Foundations Only Comm and Indust. 200.00**

Providing that the person accepting this permit shall in every respect conform to the terms of application therefore on file in this office; to the provisions of the statute of the Commonwealth and to the by-laws of the City of New Bedford relating to the inspection, erection, enlarging, altering, raising, moving, repairing, or tearing down of a building.

Permit is issued subject to the following special requirements: (Restrictions)



**Wiring Inspector**

---

---

---

---



**Plumbing Inspector**

---

---

---

---



**Building Inspector**

---

---

---

---

YOUR AREA INSPECTOR IS: **James E. Berube**

Tel. (508) 979-1540 Between 8:00am - 9:00am

**NOTICE: NOTIFY INSPECTOR 48 HOURS IN ADVANCE OF APPLYING SHEATHING OR LATHING**

**OCCUPANCY PERMIT REQUIRED BEFORE OCCUPANCY**

No Building or Structure shall be used or occupied until the Certificate of Use and Occupancy shall have been issued by the Building Commissioner - MSBC, Sect. 120.1

**This Card Must Be Displayed in a Conspicuous Place on the Premises and Not Torn Down or Removed Until Completion of Work**

SUBJECT TO MASSACHUSETTS  
STATE BUILDING CODE

*James E. Berube*

Building Inspector

Plan Review Comments:

Work Order Number: 17-001803

2/14/2017  
8:16 AM

Category: Service Lateral Gravity Priority: \_\_\_\_\_  
 Problem: Contractor Inspection Crew: \_\_\_\_\_  
 Cause: \_\_\_\_\_ Supervisor: MANUEL SILVA  
 Main Task: Investigate / Inspect Status: New Work Order  
 Work Order Start Date/Time: \_\_\_\_\_ Work Order End Date/Time: \_\_\_\_\_

Location (s) \_\_\_\_\_  
 EMERY ST

Comments from Request \_\_\_\_\_  
 inspection hanagan school

Task Start Date/Time: \_\_\_\_\_ Task End Date/Time: \_\_\_\_\_

Task Code: SWT220 Task Description: Investigate / Inspect

| Employee Number | Employee Name | Time Type |      |        |              | Units |
|-----------------|---------------|-----------|------|--------|--------------|-------|
|                 |               | Reg       | OT   | Normal | Type         |       |
| 14950           | ANTONIO LEMOS | 0.00      | 0.00 | 0.00   | REGULAR TIME | Hours |
| 2/16/2017       | 1h            |           |      |        |              |       |
| 2/17/2017       | 3h            |           |      |        |              |       |
|                 |               |           |      |        |              |       |
|                 |               |           |      |        |              |       |

| Equipment Code | Equipment Description | Units |
|----------------|-----------------------|-------|
|                |                       |       |
|                |                       |       |
|                |                       |       |

| Material Code | Material Description | Units |
|---------------|----------------------|-------|
|               |                      |       |
|               |                      |       |
|               |                      |       |

| Fluid Code | Fluid Description | Units |
|------------|-------------------|-------|
|            |                   |       |
|            |                   |       |
|            |                   |       |

See map.  
 Connection to SEWER line at Emery St.  
 Harrison School.  
 Antonio Lemos  
 2/24/2017



# Inspections

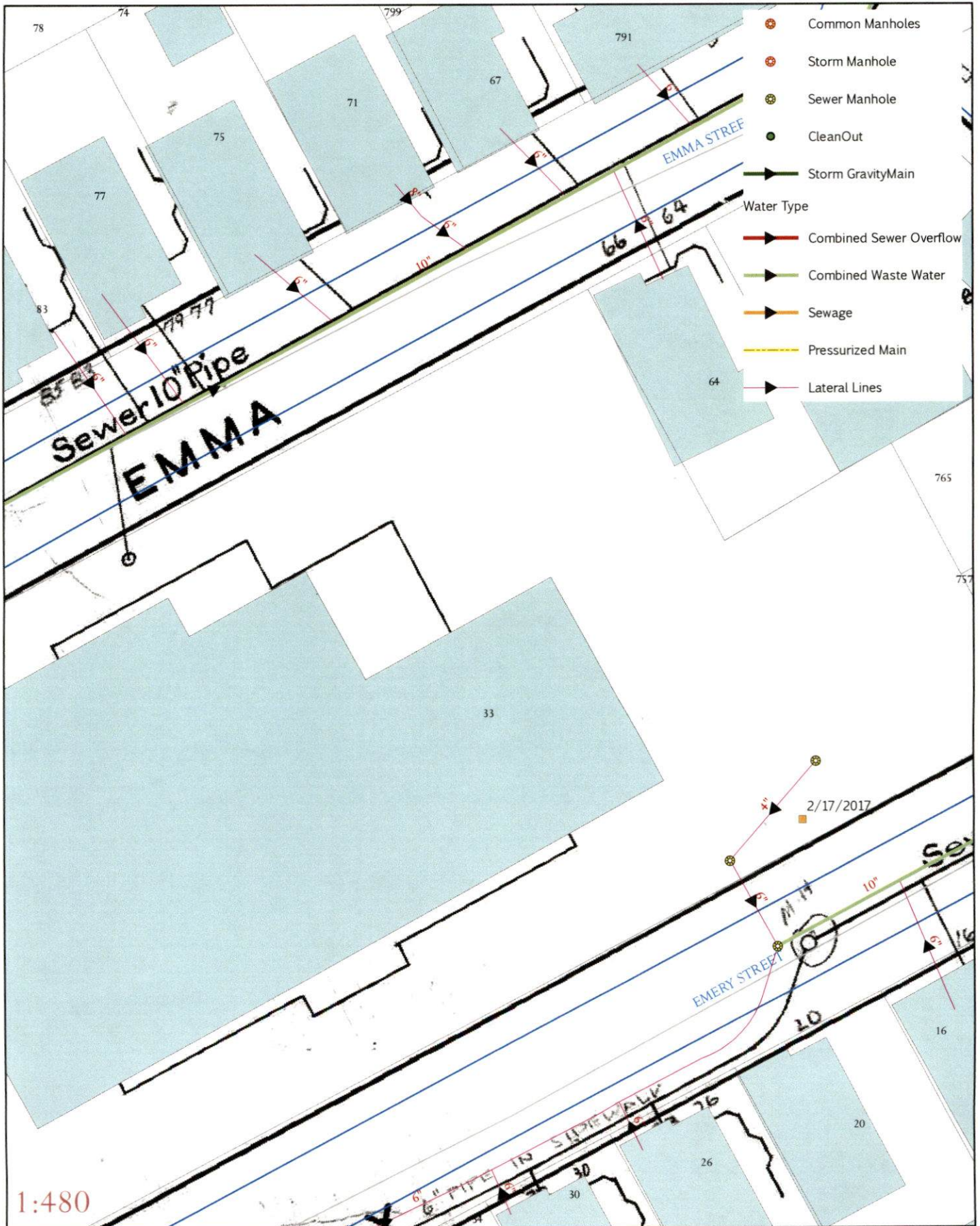



# Inspections

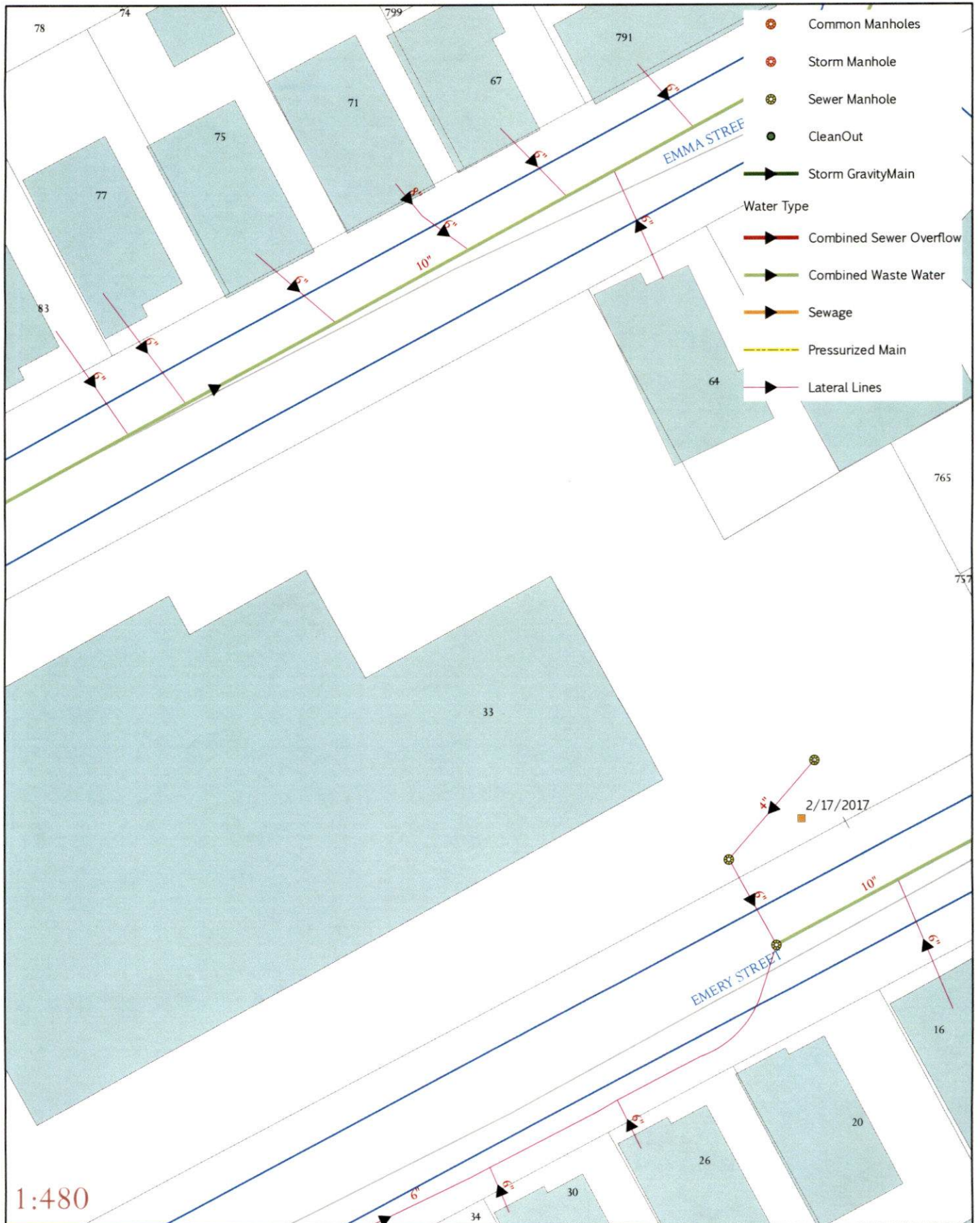

Work Order Number: 18-007273

5/22/2018  
11:37 AM

Category: Service Lateral Gravity Priority: \_\_\_\_\_  
 Problem: Locate Request Crew: \_\_\_\_\_  
 Cause: \_\_\_\_\_ Supervisor: STEPHANIE DUPRAS  
 Main Task: Investigate / Inspect Status: New Work Order  
 Work Order Start Date/Time: \_\_\_\_\_ Work Order End Date/Time: \_\_\_\_\_

Location (s) \_\_\_\_\_  
 33 EMERY ST

Comments from Request \_\_\_\_\_  
 DRAIN INSPECTION FOR HANNIGAN SCHOOL .. TODAY @ 1:00 (OK PER ANTONIO LEMOS) JIMMY 401-323-3900

Task Start Date/Time: \_\_\_\_\_ Task End Date/Time: \_\_\_\_\_

Task Code: SWT220 Task Description: Investigate / Inspect

| Employee Number | Employee Name | Time Type |      |        |              | Units<br>Hours |
|-----------------|---------------|-----------|------|--------|--------------|----------------|
|                 |               | Reg       | OT   | Normal | Type         |                |
| 14950           | ANTONIO LEMOS | 0.00      | 0.00 | 0.00   | REGULAR TIME |                |
|                 |               |           |      |        |              |                |
|                 |               |           |      |        |              |                |
|                 |               |           |      |        |              |                |
|                 |               |           |      |        |              |                |

| Equipment Code | Equipment Description | Units |
|----------------|-----------------------|-------|
|                |                       |       |
|                |                       |       |
|                |                       |       |
|                |                       |       |

| Material Code | Material Description | Units |
|---------------|----------------------|-------|
|               |                      |       |
|               |                      |       |
|               |                      |       |
|               |                      |       |

| Fluid Code | Fluid Description | Units |
|------------|-------------------|-------|
|            |                   |       |
|            |                   |       |
|            |                   |       |
|            |                   |       |

Info: OK.

DRAINAGE (ductil line) extension + dry well.  
 ↓ 116 ft / 6"

Antonio Lemos  
 5/29/2018