

24480 A



exp: 8/16/17

PERMIT NO.
24480 A

CITY OF NEW BEDFORD
SEWER AND/OR STORM DRAIN PERMIT

DATE 8/16/16

This certifies that permission is granted to

Property Owner Carmen Teixeira Address 1103 Sheffield St NB MA Tel. _____

To connect a sewer and/or storm drain located at sheffield st 508-995-6559

Assessor's Plot 1324 Lot 35, to the sewer and/or storm drain in sheffield st Street 8 inch sewer

To be laid in accordance with the conditions in this application and the City of New Bedford ordinances.

TYPE OF USE: RESIDENTIAL COMMERCIAL INDUSTRIAL FLOW 500 G.P.D.

If applicant other than actual property owner, attach Letter of Authorization from Property Owner.

Name _____ Tel. _____

Mailing Address _____

The Bonded Contractor/Drain Layer authorized to perform this work is:

Name _____ Address _____ Tel. _____

Type of Pipe Required: PVC SDR35

PERMIT EXPIRES ONE YEAR AFTER DATE OF ISSUE

- Requires separate connections for sewage and storm drain where applicable. Storm water cannot be discharged to a sanitary sewer.
- All work must be inspected and approved by a D.P.I. inspector before backfilling.
- If this connection is to be part of a private service shared jointly with other building owners, attach copy of Recorded Joint Maintenance Agreement.
- Permits can be issued to Industrial and/or Commercial Applicants only upon receipt and approval by the Commissioner of Public Infrastructure of required plans and supplemental information.
- In addition, a City-issued Industrial User Discharge Permit and/or a Sewer Extension/Connection Permit issued by the Commonwealth of Massachusetts D.E.P. shall be required by the City for Industrial Discharge into the sewer system.

Industrial User Discharge Permit No. _____ Date _____

Comm. Mass. Sewer Conn./Ext. Permit No. 16-056 Date 8/16/16

A Filing and Inspection Fee of \$ 450.00 plus an Entrance Fee of \$ 500.00 where applicable, must accompany this application.

Bank# webster Bank Check# 211 Date 8/16/16 Receipt# 440004

Other requirements: Please contact us with 24 hours for inspection

Connection made to Sewer Part of jointly-shared private line YES NO
Storm Drain

Applicant agrees to abide by the above terms, as well as all pertinent ordinances of the City of New Bedford, and such other special rules as the Commissioner of Public Infrastructure and/or City Engineer may deem necessary

Clara M. Amato
City Engineer

Carmen Teixeira
Signature of Property Owner or Representative

INSPECTOR'S REPORT

INSPECTED BY: _____

DATE: _____

COMMENTS: _____

APPROVED

DISAPPROVE

SEE WORK ORDER

SIGNATURE

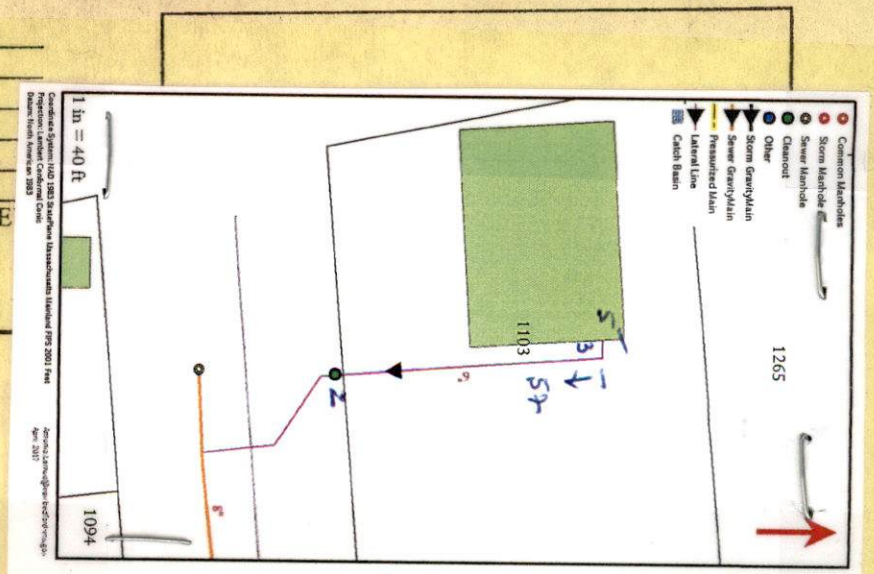



TTW-16-15

exp: 8/16/17

PERMIT NO.
244 80A

CITY OF NEW BEDFORD
SEWER AND/OR STORM DRAIN PERMIT

DATE 8/16/16

This certifies that permission is granted to

Carmen Teixeira 1103 Sheffield St NB MA
Property Owner Address Tel.

To connect a sewer and/or storm drain located at Sheffield St 508-995-4559

Assessor's Plot 132H Lot 35, to the sewer and/or storm drain in Sheffield St Street
8 inch sewer

To be laid in accordance with the conditions in this application and the City of New Bedford ordinances.

TYPE OF USE: RESIDENTIAL COMMERCIAL INDUSTRIAL FLOW 300 G.P.D.

If applicant other than actual property owner, attach Letter of Authorization from Property Owner.

Name N/A Tel. _____

Mailing Address _____

The Bonded Contractor/Drain Layer authorized to perform this work is:

R. Banessa
Name Address Tel.

Type of Pipe Required: PVC SDR 35

PERMIT EXPIRES ONE YEAR AFTER DATE OF ISSUE

- Requires separate connections for sewage and storm drain where applicable. Storm water cannot be discharged to a sanitary sewer.
 - All work must be inspected and approved by a D.P.I. inspector before backfilling.
 - If this connection is to be part of a private service shared jointly with other building owners, attach copy of Recorded Joint Maintenance Agreement.
 - Permits can be issued to Industrial and/or Commercial Applicants only upon receipt and approval by the Commissioner of Public Infrastructure of required plans and supplemental information.
 - In addition, a City-issued Industrial User Discharge Permit and/or a Sewer Extension/Connection Permit issued by the Commonwealth of Massachusetts D.E.P. shall be required by the City for Industrial Discharge into the sewer system.
- Industrial User Discharge Permit No. _____ Date _____

Comm. Mass. Sewer Conn./Ext. Permit No. 16-06 Date 8/16/16

A Filing and Inspection Fee of \$ 450.00, plus an Entrance Fee of \$ 522.75 where applicable, must accompany this application.
(Stub cost) 1748 130.75-

Bank# webster Bank Check# 211 Date 8/16/16 Receipt# 440004
440003

Other requirements: Please contact us with 24 hours
for inspection

Connection made to Sewer Part of jointly-shared private line YES NO
Storm Drain

Applicant agrees to abide by the above terms, as well as all pertinent ordinances of the City of New Bedford, and such other special rules as the Commissioner of Public Infrastructure and/or City Engineer may deem necessary

Randy Amato
City Engineer
Clerk of the Works

Carmen Teixeira
Signature of Property Owner or Representative

INSPECTOR'S REPORT

INSPECTED BY: _____
DATE: _____
COMMENTS: _____

APPROVED DISAPPROVED

SIGNATURE

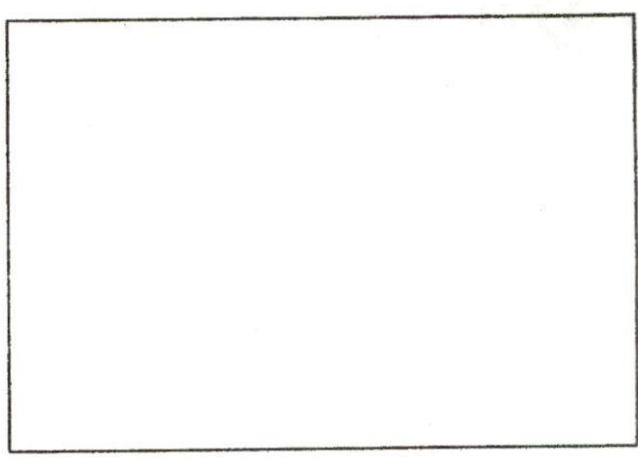

SKETCH PLAN

DISPLAY PERMIT IN A CONSPICUOUS PLACE ON THE PREMISES



Commonwealth of Massachusetts

City of New Bedford

133 William Street New Bedford, MA 02740

SEWER PERMIT



Date: **9/2/2016**

No. **WW-16-15**

Sewer Connection Fee: **\$972.75**

Pipe Size: **0.00**

Trench Length: **0.00**

Service Location: **1103 SHEFFIELD ST**

Owner Name: **TEIXEIRA CARMEN RTEIXEIRA**

Type of Occupancy: **Residential**

Type of Work: **Sewer - New Service Abandon
Septic**

Work Description: **SEWER # 24480A
P 132H L35**

1103 SHEFFIELD ST

ABANDONMENT OF SEPTIC SYSTEM

EXPIRES 8/16/17

**17FT @ 30.75 FOR STUB
ABANDONMENT PERMIT# 16-06**

No. of Units : **0**

Required Design Daily Flow : **0.00**

Provided Daily Flow : **0.00**

The undersigned petitions you to grant permission to ENTER INTO THE MAIN SEWER and, if such permission is granted, hereby agrees to the following:

1. To abide by the conditions and regulations imposed by the Commissioner of Public Works by statute or by ordinance now in force, or as amended from time to time.
2. That the connection of said sewer with the main sewer shall be inspected by an employee of the department of Public Works or by a designated agent of the Town before burial of said connection.
3. That the work shall at all times be under the direction and control of the Commissioner of Public Works or his authorized agent, and that any expense incurred by the Town shall be charged to the permittee, and said

permittee

agrees to reimburse the Town for said expense.

Installing Company Name: _____

License Type: _____

Address: _____ City/Town/State: _____

Call (781) 942-9077 For Inspection

No. 16-06

FEE \$60.00

COMMONWEALTH OF MASSACHUSETTS

Board of Health, NEW BEDFORD, MA

DISPOSAL SYSTEM CONSTRUCTION PERMIT

Permission is hereby granted to: Construct () Repair () Upgrade () Abandon (X) an individual sewage disposal system
at 1103 Sheffield St. as described in the application for
Disposal System Construction Permit No. 16-06, dated _____

Provided: Construction shall be completed within three years of the date of this permit. All local conditions must be met.

Form 1255 Rev. 5/96 A.M. Sulkin Co. Boston, MA

Date 8-16-16 Board of Health

Margaret J. McKinnon

Received

sewer insp. @ 1pm 8/24/16
APPLICATION/AGREEMENT

For Trench/Disturbance Permit within the City of New Bedford

Permit # 354-14
Dig Safe # 5016-330-5603

Date 8-17-16

AUG 17 2016
TO THE MAYOR AND CITY COUNCIL:

DISTURBANCE PERMIT/TRENCH SAFETY PERMIT

Department of Public Infrastructure
Permission is hereby requested to excavate the surface of: ☒ City Property and/or ☒ Private Property

Location of Work: 1103 Sheffield Street

Provide Sketch

4501.01
2

Substantially as per plan annexed, for the purpose of: sewer connection

ROADWAY CLOSURES WILL REQUIRE
AUTHORIZATION FROM THE
COMMISSIONER OF PUBLIC
INFRASTRUCTURE. TRAFFIC MANAGEMENT
PLANS MAY BE REQUIRED.

FOR INSPECTION ONLY A 24 HOUR
NOTICE IS REQUIRED AND THE
CONTRACTOR/APPLICANT IS
REQUIRED TO NOTIFY THE D.P.I.
@ 508 979-1550 Press 3 Repair

Work will begin (weather permitting) on: 8/18/16

Work will end (weather permitting) on: 11/18/16

Applicant Name: Robert J. Canessa

Excavator(s) Name: R.J. Canessa Excavator

Company Name: RT Canessa Excavating

Hoisting Equipment License Number: 137115

Grade: SA Expiration Date: 7/24/2017

Contact Number: 508-916-1144

Name & Contact Number of Insurer: Ria-Dumont Audet

Competent Person on Work Site: Bob

APPROVED BY: Dan M. Amato DATE: 8/17/16

TITLE: Clerk of the Works

This permit shall be posted at the work site, and shall remain until the work is completed. It is subject to inspection at all times.

Info: Septic system killed.
Tied to SEWER LINE.

SEE ATT.

Dan's Log 8/24/2016