



TWw. 15-12

exp. 4/22/16

Inspection @ 9:00 AM

5/15/15

DATE 4/22/15

PERMIT NO.
24428

CITY OF NEW BEDFORD
SEWER AND/OR STORM DRAIN PERMIT

This certifies that permission is granted to

Maella + Henri Thivierge 947 Glen St
Property Owner Address

5089951520
Tel.

To connect a sewer and/or storm drain located at.....

Assessor's Plot 130D Lot 1216, to the sewer and/or storm drain in..... Glen..... Street

To be paid in accordance with the conditions in this application and the City of New Bedford ordinances.

TYPE OF USE: RESIDENTIAL COMMERCIAL INDUSTRIAL FLOW _____ G.P.D.

If applicant other than actual property owner, attach Letter of Authorization from Property Owner.

Name..... Tel.....

Mailing Address.....

The Bonded Contractor/Drain Layer authorized to perform this work is:

Cardoso Construting

Name..... Address..... Tel.....

Type of Pipe Required: PVC 35 SDR

PERMIT EXPIRES ONE YEAR AFTER DATE OF ISSUE

- Requires separate connections for sewage and storm drain where applicable. Storm water cannot be discharged to a sanitary sewer.
 - All work must be inspected and approved by a D.P.I. inspector before backfilling.
 - If this connection is to be part of a private service shared jointly with other building owners, attach copy of Recorded Joint Maintenance Agreement.
 - Permits can be issued to Industrial and/or Commercial Applicants only upon receipt and approval by the Commissioner of Public Infrastructure of required plans and supplemental information.
 - In addition, a City-issued Industrial User Discharge Permit and/or a Sewer Extension/Connection Permit issued by the Commonwealth of Massachusetts D.E.P. shall be required by the City for Industrial Discharge into the sewer system.
- Industrial User Discharge Permit No..... Date.....

Comm. Mass. Sewer Conn./Ext. Permit No..... Date.....

A Filing and Inspection Fee of \$7.50, plus an Entrance Fee of \$153.50, where applicable, must accompany this application.

Bank# First Citizens Check# 428 Date 4/22/15 Receipt# 33604
\$2003.50

Other requirements:.....

Connection made to Sewer Part of jointly-shared private line YES NO
Storm Drain

Applicant agrees to abide by the above terms, as well as all pertinent ordinances of the City of New Bedford, and such other special rules as the Commissioner of Public Infrastructure and/or City Engineer may deem necessary

Antonio Paulo Lima
City Engineer

Henri Thivierge
Signature of Property Owner or Representative

INSPECTOR'S REPORT

INSPECTED BY: Antonio Paulo Lima
DATE: 5/18/2015
COMMENTS:

APPROVED DISAPPROVED

Antonio Paulo Lima
SIGNATURE

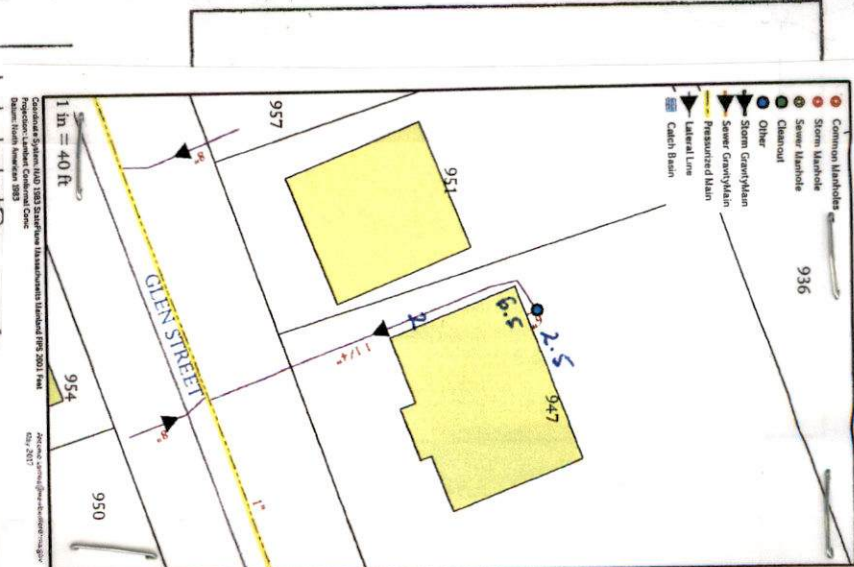



000.15.12

exp. 4/22/16

PERMIT NO.
24428

CITY OF NEW BEDFORD
SEWER AND/OR STORM DRAIN PERMIT

DATE 4/22/15

This certifies that permission is granted to

Noella+Henri Thivierge 947 Glen St 5089951520
Property Owner Address Tel.

To connect a sewer and/or storm drain located at.....

Assessor's Plot 1300 Lot 1216 to the sewer and/or storm drain in Glen Street

To be laid in accordance with the conditions in this application and the City of New Bedford ordinances.

TYPE OF USE: RESIDENTIAL COMMERCIAL INDUSTRIAL FLOW G.P.D.

If applicant other than actual property owner, attach Letter of Authorization from Property Owner.

Name..... Tel.....

Mailing Address.....

The Bonded Contractor/Drain Layer authorized to perform this work is:

Cardoso Construting

Name..... Address..... Tel.....

Type of Pipe Required: PVC 35 SDR

PERMIT EXPIRES ONE YEAR AFTER DATE OF ISSUE

- Requires separate connections for sewage and storm drain where applicable. Storm water cannot be discharged to a sanitary sewer.
- All work must be inspected and approved by a D.P.I. inspector before backfilling.
- If this connection is to be part of a private service shared jointly with other building owners, attach copy of Recorded Joint Maintenance Agreement.
- Permits can be issued to Industrial and/or Commercial Applicants only upon receipt and approval by the Commissioner of Public Infrastructure of required plans and supplemental information.
- In addition, a City-issued Industrial User Discharge Permit and/or a Sewer Extension/Connection Permit issued by the Commonwealth of Massachusetts D.E.P. shall be required by the City for Industrial Discharge into the sewer system.

Industrial User Discharge Permit No..... Date.....

Comm. Mass. Sewer Conn./Ext. Permit No..... Date.....

A Filing and Inspection Fee of \$7.50, plus an Entrance Fee of \$1533.50 where applicable, must accompany this application.

Bank# First Citizens Check# 428 Date 4/22/15 Receipt# 33604
\$2003.50

Other requirements:.....

Connection made to Sewer Part of jointly-shared private line YES NO
Storm Drain

Applicant agrees to abide by the above terms, as well as all pertinent ordinances of the City of New Bedford, and such other special rules as the Commissioner of Public Infrastructure and/or City Engineer may deem necessary

Henri Thivierge
City Engineer
Clerk of the Works

Henri Thivierge
Signature of Property Owner or Representative

INSPECTOR'S REPORT

INSPECTED BY: _____
DATE: _____
COMMENTS: _____

APPROVED DISAPPROVED

SIGNATURE

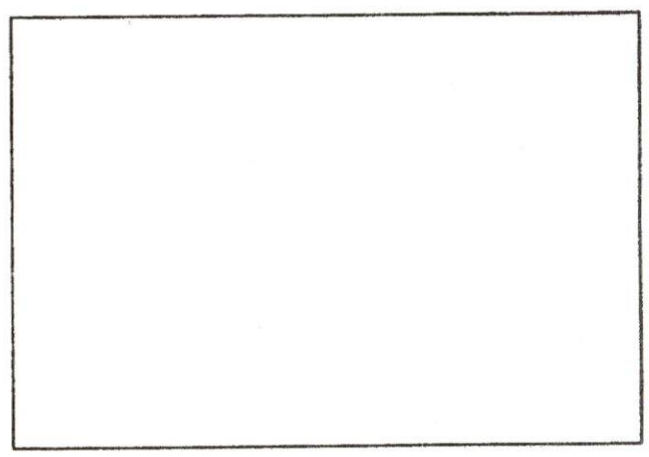

SKETCH PLAN

DISPLAY PERMIT IN A CONSPICUOUS PLACE ON THE PREMISES



Commonwealth of Massachusetts
City of New Bedford

133 William Street New Bedford, MA 02740

SEWER PERMIT



Date: **7/16/2015**

No. **WW-15-12**

Sewer Connection Fee: **\$2,003.50**

Pipe Size: **0.00**

Trench Length: **0.00**

Service Location: **947 GLEN ST**

Owner Name: **THIVIERGE NOELLATHIVIERGE**

Type of Occupancy: **Residential**

Type of Work: **Sewer - New Service Abandon
Septic**

Work Description: **PVC SDR35**

SEWER PERMIT# 24428

P130D L126

EXPIRES: 4/22/16

No. of Units : **0** Required Design Daily Flow : **0.00** Provided Daily Flow : **0.00**

The undersigned petitions you to grant permission to ENTER INTO THE MAIN SEWER and, if such permission is granted, hereby agrees to the following:

1. To abide by the conditions and regulations imposed by the Commissioner of Public Works by statute or by ordinance now in force, or as amended from time to time.
2. That the connection of said sewer with the main sewer shall be inspected by an employee of the department of Public Works or by a designated agent of the Town before burial of said connection.
3. That the work shall at all times be under the direction and control of the Commissioner of Public Works or his authorized agent, and that any expense incurred by the Town shall be charged to the permittee, and said

permittee

agrees to reimburse the Town for said expense.

Installing Company Name: _____ License Type: _____

Address: _____ City/Town/State: _____

GRANTED WITH THE USUAL CONDITIONS

Call (781) 942-9077 For Inspection

No. 75-

FEE 60.

Twu. 15.12
COMMONWEALTH OF MASSACHUSETTS

Board of Health, NEW BEDFORD, MA.

DISPOSAL SYSTEM CONSTRUCTION PERMIT

Permission is hereby granted to; Construct() Repair() Upgrade() Abandon^X an individual sewage disposal system
at 947 Glen St as described in the application for

Disposal System Construction Permit No. 15-, dated 4/22/15.

Provided: Construction shall be completed within three years of the date of this permit. All local conditions must be met.

6
Date 4/22/15 Board of Health *[Signature]*

Erin J. Lopes

From: Sarah Porter
Sent: Wednesday, April 22, 2015 11:15 AM
To: Erin J. Lopes
Subject: RE: 947 GLEN ST

Good Morning Erin, that property is all set, no wetlands
Thank you

From: Erin J. Lopes
Sent: Wednesday, April 22, 2015 10:48 AM
To: Sarah Porter
Subject: 947 GLEN ST

Good Morning, the above address listed is looking to be able to abandon their septic system. Is this an acceptable area? Please advise

Erin J. Lopes

Administrative Specialist
Department of Public Infrastructure
1105 Shawmut Avenue
New Bedford, MA 02746
ph: 508-979-1550 x143
fx: 508-961-3054

City of New Bedford
Dept of Public Infrastructure
1105 Shawmut Ave
New Bedford, MA 02740
(508) 979-1550

102339-0005 Erin I. 04/22/2015 02:02PM

ISCELLANEOUS

Description: DPI SEWER
PERMITS AND EXTENSIONS
(DPISEW)

Reference 1: 947 GLEN

Reference 2: 24428

DPI SEWER PERMITS AND
EXTENSIONS

1 @ 2,003.50

DPI SEWER PERMITS AND
EXTENSIONS

Principal 2,003.50

Interest 0.00

TW05-101009- 2,003.50D

63906000-422185- 2,003.50C

Payment Id: 33604

2,003.50

Subtotal 2,003.50

Total 2,003.50

CHECK 2,003.50

Check Number 428

Change due 0.00

Paid by: NOELLA THIVIEGE

Thank you for your payment

CUSTOMER COPY
DUPLICATE RECEIPT

NOELLA Y THIVIERGE
DIANE KRAIHANZEL
947 GLEN ST.
NEW BEDFORD, MA 027453414

53-9458/2113

428

DATE 4/22/15

PAY TO
THE ORDER OF

City of New Bedford

\$2003.50

Two thousand three hundred and 50/100

DOLLARS



Security Features
Included
Details on Back



FIRST CITIZENS
FEDERAL CREDIT UNION

Think First.

Fairhaven, Massachusetts 02719
www.firstcitizens.org

MEMO

permitted tree fee

Noella Y Thivierge

MP

⑆211384586⑆ 0023895776⑆ 0428

© 2014 First Citizens