

Expires 12/19/15



PERMIT NO.

CITY OF NEW BEDFORD  
SEWER AND/OR STORM DRAIN PERMIT

DATE 12/19/14

24415

This certifies that permission is granted to

J&T home Builders P.O. Box 80038 Dorham, NH 02748 Tel. 724-930-1024  
Property Owner Address

To connect a sewer and/or storm drain located at Chaffee St (S.S.) 113' E Haywood St  
Assessor's Plot 130C Lot 772, to the sewer and/or storm drain in 12" inch on Chaffee Street

To be laid in accordance with the conditions in this application and the City of New Bedford ordinances.  
TYPE OF USE: RESIDENTIAL COMMERCIAL INDUSTRIAL FLOW 330 G.P.D.

If applicant other than actual property owner, attach Letter of Authorization from Property Owner.

Name N/A Tel. N/A  
Mailing Address N/A

The Bonded Contractor/Drain Layer authorized to perform this work is:

P.J. CAMPBELL  
Name Address Tel.  
Type of Pipe Required: SDR 35 PVC

PERMIT EXPIRES ONE YEAR AFTER DATE OF ISSUE

- Requires separate connections for sewage and storm drain where applicable. Storm water cannot be discharged to a sanitary sewer.
  - All work must be inspected and approved by a D.P.I. inspector before backfilling.
  - If this connection is to be part of a private service shared jointly with other building owners, attach copy of Recorded Joint Maintenance Agreement.
  - Permits can be issued to Industrial and/or Commercial Applicants only upon receipt and approval by the Commissioner of Public Infrastructure of required plans and supplemental information.
  - In addition, a City-issued Industrial User Discharge Permit and/or a Sewer Extension/Connection Permit issued by the Commonwealth of Massachusetts D.E.P. shall be required by the City for Industrial Discharge into the sewer system.
- Industrial User Discharge Permit No. \_\_\_\_\_ Date \_\_\_\_\_

Comm. Mass. Sewer Conn./Ext. Permit No. \_\_\_\_\_ Date \_\_\_\_\_  
A Filing and Inspection Fee of \$ 450.00, plus an Entrance Fee of \$ \_\_\_\_\_ where applicable, must accompany this application.

Bank# Bank Five Check# 3303 Date 12/22/14 Receipt# 29146

Other requirements: Please call ahead 24 hr notice for inspection. Existing  
Sewer Service must be pressure tested.

Connection made to Sewer Part of jointly-shared private line YES NO  
Storm Drain

Applicant agrees to abide by the above terms, as well as all pertinent ordinances of the City of New Bedford, and such other special rules as the Commissioner of Public Infrastructure and/or City Engineer may deem necessary

[Signature] City Engineer  
[Signature] Signature of Property Owner or Representative

INSPECTOR'S REPORT

INSPECTED BY: \_\_\_\_\_  
DATE: \_\_\_\_\_  
COMMENTS: \_\_\_\_\_

APPROVED \_\_\_\_\_ DISAPPROVED \_\_\_\_\_

SIGNATURE \_\_\_\_\_

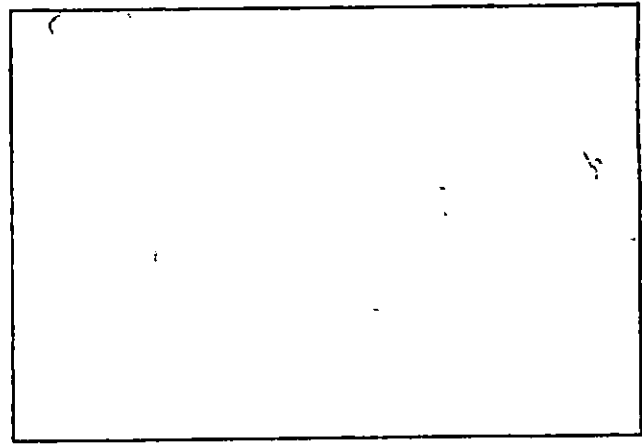

SKETCH PLAN





Expires 12/19/15

PERMIT NO.

CITY OF NEW BEDFORD  
SEWER AND/OR STORM DRAIN PERMIT

DATE 12/19/14

24415

This certifies that permission is granted to

J.T. Home Builders, P.O. Box 80037  
Property Owner Address Tel. 774-930-1024

To connect a sewer and/or storm drain located at Chaffee St (S.S.) 113' E x Hollywood St

Assessor's Plot 1300 Lot 772, to the sewer and/or storm drain in 18' from on Chaffee Street

To be laid in accordance with the conditions in this application and the City of New Bedford ordinances.

TYPE OF USE: RESIDENTIAL COMMERCIAL INDUSTRIAL FLOW 330 G.P.D.

If applicant other than actual property owner, attach Letter of Authorization from Property Owner.

Name..... Tel.....

Mailing Address.....

The Bonded Contractor/Drain Layer authorized to perform this work is:

J.T. CANON

Name..... Address..... Tel.....

Type of Pipe Required: SDR 35 PVC

PERMIT EXPIRES ONE YEAR AFTER DATE OF ISSUE

- Requires separate connections for sewage and storm drain where applicable. Storm water cannot be discharged to a sanitary sewer.
- All work must be inspected and approved by a D.P.I. inspector before backfilling.
- If this connection is to be part of a private service shared jointly with other building owners, attach copy of Recorded Joint Maintenance Agreement.
- Permits can be issued to Industrial and/or Commercial Applicants only upon receipt and approval by the Commissioner of Public Infrastructure of required plans and supplemental information.
- In addition, a City-issued Industrial User Discharge Permit and/or a Sewer Extension/Connection Permit issued by the Commonwealth of Massachusetts D.E.P. shall be required by the City for Industrial Discharge into the sewer system.

Industrial User Discharge Permit No..... Date.....

Comm. Mass. Sewer Conn./Ext. Permit No..... Date.....

A Filing and Inspection Fee of \$450.00, plus an Entrance Fee of \$..... where applicable, must accompany this application.

Bank# Bank Five Check# 3303 Date 12/1/14 Receipt# 291116

Other requirements: Please call Chaffee St. 2111111111 for connection. E.T. 11/1/14

Sewer Service must be pressure tested.

Connection made to Sewer Part of jointly-shared private line YES NO  
Storm Drain

Applicant agrees to abide by the above terms, as well as all pertinent ordinances of the City of New Bedford, and such other special rules as the Commissioner of Public Infrastructure and/or City Engineer may deem necessary

City Engineer

Signature of Property Owner or Representative

INSPECTOR'S REPORT

INSPECTED BY: \_\_\_\_\_

DATE: \_\_\_\_\_

COMMENTS: \_\_\_\_\_

APPROVED

DISAPPROVED

SEE WHITE SHEET  
SIGNATURE

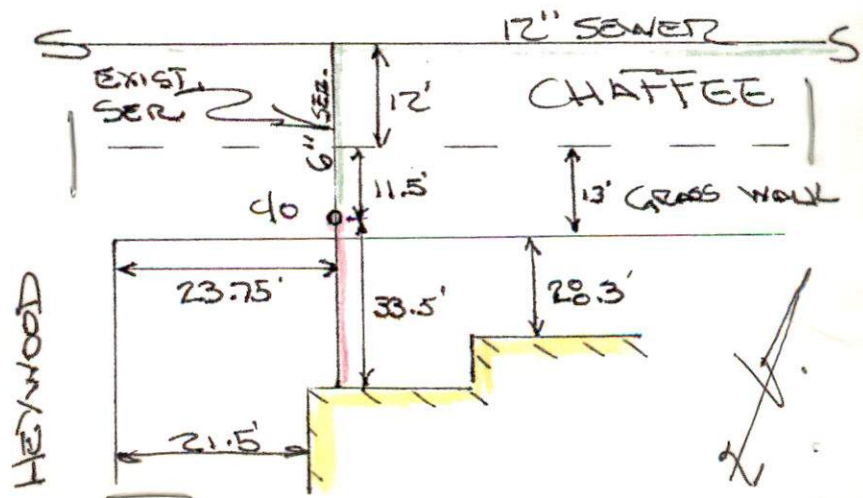





3/25/14 @ 1:00

Inspector Expires 12/19/11

PERMIT NO.

24415

CITY OF NEW BEDFORD  
SEWER AND/OR STORM DRAIN PERMIT

DATE 12/19/14

This certifies that permission is granted to

J&T home Builders P.O. Box 80038 774-930-1024  
Property Owner Address Darnmouth 02748 Tel.

To connect a sewer and/or storm drain located at Chaffee St (S.S.) 113' 2x Heywood St.  
Assessor's Plot 1300 Lot 772, to the sewer and/or storm drain in 12" inch on Chaffee Street

To be laid in accordance with the conditions in this application and the City of New Bedford ordinances.  
TYPE OF USE: RESIDENTIAL COMMERCIAL INDUSTRIAL FLOW 330 G.P.D.

If applicant other than actual property owner, attach Letter of Authorization from Property Owner.

Name Mailing Address Tel.

The Bonded Contractor/Drain Layer authorized to perform this work is:

Name Address Tel.  
Type of Pipe Required: SDR 35 PVC

PERMIT EXPIRES ONE YEAR AFTER DATE OF ISSUE

- Requires separate connections for sewage and storm drain where applicable. Storm water cannot be discharged to a sanitary sewer.
  - All work must be inspected and approved by a D.P.I. inspector before backfilling.
  - If this connection is to be part of a private service shared jointly with other building owners, attach copy of Recorded Joint Maintenance Agreement.
  - Permits can be issued to Industrial and/or Commercial Applicants only upon receipt and approval by the Commissioner of Public Infrastructure of required plans and supplemental information.
  - In addition, a City-issued Industrial User Discharge Permit and/or a Sewer Extension/Connection Permit issued by the Commonwealth of Massachusetts D.E.P. shall be required by the City for Industrial Discharge into the sewer system.
- Industrial User Discharge Permit No. Date

Comm. Mass. Sewer Conn./Ext. Permit No. Date  
A Filing and Inspection Fee of \$450.00, plus an Entrance Fee of \$ where applicable, must accompany this application.

Bank# Bank Five Check# 3303 Date 12/22/14 Receipt# 29146

Other requirements: Please call ahead 24 hr notice for inspection. Existing  
Sewer Service must be pressure tested.

Connection made to Sewer Part of jointly-shared private line YES NO  
Storm Drain

Applicant agrees to abide by the above terms, as well as all pertinent ordinances of the City of New Bedford, and such other special rules as the Commissioner of Public Infrastructure and/or City Engineer may deem necessary

City Engineer

Signature of Property Owner or Representative

INSPECTOR'S REPORT

INSPECTED BY: DATE: 3/25/15 COMMENTS:

APPROVED

DISAPPROVED

SIGNATURE

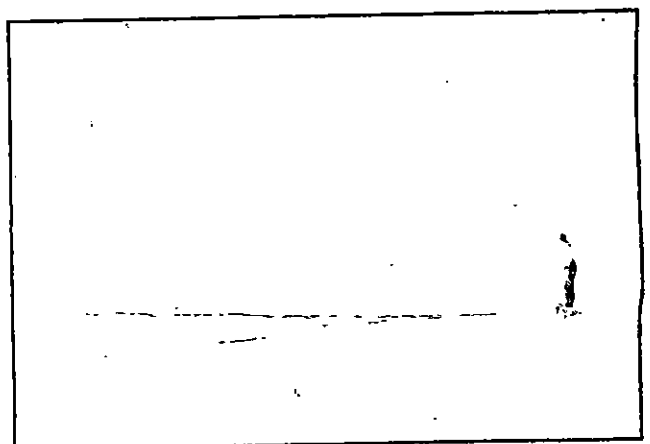

SKETCH PLAN



Commonwealth of Massachusetts

# CITY OF NEW BEDFORD

City Hall, Room 308, 133 William Street New Bedford, MA 02740 (508) 979-1540



## FOUNDATION PERMIT

11/26/2014

No. **B-14-2243**

MSBC Sect. 111.8 - Any permit issued shall be deemed abandoned and invalid unless the work authorized by it shall have been commenced within six (6) months after its issuance.

FEE PAID \$100.00

This certifies that Jose DeSousa

owner/contractor has permission to:

1116

CHAFFEE ST

on: Foundations Only 1-2 Family - 100.00

*P. 130C / 772.*

Providing that the person accepting this permit shall in every respect conform to the terms of application therefore on file in this office; to the provisions of the statute of the Commonwealth and to the by-laws of the City of New Bedford relating to the inspection, erection, enlarging, altering, raising, moving, repairing, or tearing down of a building.

Permit is issued subject to the following special requirements: (Restrictions)

 **Wiring Inspector**



**Plumbing Inspector**



**Building Inspector**

\_\_\_\_\_  
\_\_\_\_\_  
\_\_\_\_\_  
\_\_\_\_\_

\_\_\_\_\_  
\_\_\_\_\_  
\_\_\_\_\_  
\_\_\_\_\_

\_\_\_\_\_  
\_\_\_\_\_  
\_\_\_\_\_  
\_\_\_\_\_

YOUR AREA INSPECTOR IS: Thomas Welch

Tel. (508) 979-1540 Between 8:00am - 9:00am

**NOTICE: NOTIFY INSPECTOR 48 HOURS IN ADVANCE OF APPLYING SHEATHING OR LATHING**

**OCCUPANCY PERMIT REQUIRED BEFORE OCCUPANCY**

No Building or Structure shall be used or occupied until the Certificate of Use and Occupancy shall have been issued by the Building Commissioner - MSBC, Sect. 120.1

**This Card Must Be Displayed in a Conspicuous Place on the Premises and Not Torn Down or Removed Until Completion of Work**

SUBJECT TO MASSACHUSETTS  
STATE BUILDING CODE

*Danny D. Ronowicz*



Building Inspector

Plan Review Comments:

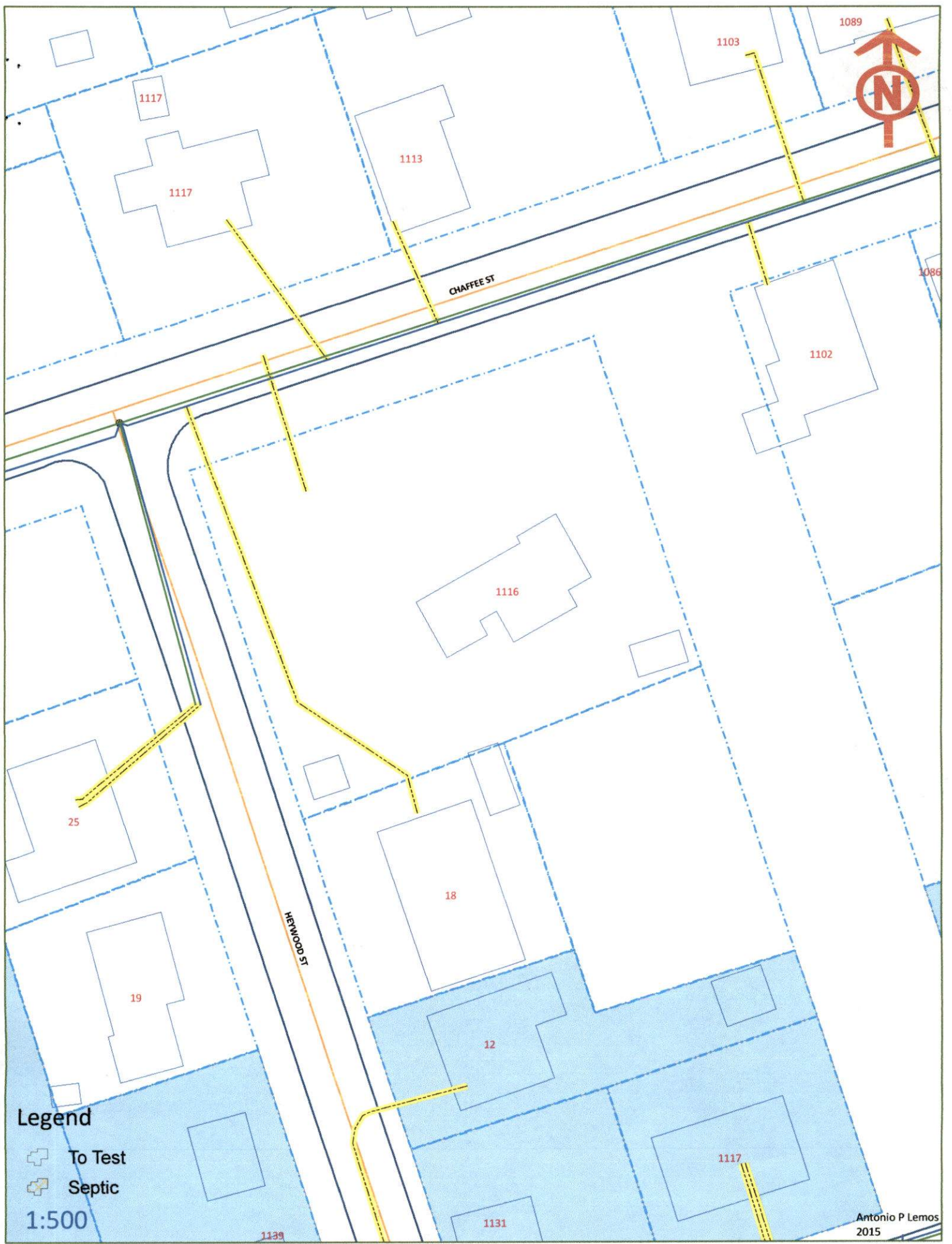



Legend

-  To Test
-  Septic

1:500

# DPI: Repair Request Log

Work Order#: **5513**

Today's Date: 3/24/2015

User: Angela

Type of Request: **Call Center**  
E-mail  
Walk in  
SeeClickFix  
In-House

Division: Highway

Request Type: Inspection

Description: sewer inspection @ 1:00 on 3/25

Location: 1116 Chaffee St

ExtraComments:

Customer Name: RJ Canessa

Customer Number:

Customer Email:

☐ Emergency? (Check for Yes)

CensusTrack:  
Pothole Use: Block:

## CORRECTED ACTION TAKEN

Request Sent To: Bob B

Worker Comment:

☐ Completed? (Check for Yes)

Completed By:

Date Complete:

☐ Customer notified of completed work? (Check for Yes)



Save Record Add Record Print Record Delete Record

Main Menu