



PERMIT NO.

24413

CITY OF NEW BEDFORD
SEWER AND/OR STORM DRAIN PERMIT

DATE 11/20/14

This certifies that permission is granted to

Property Owner: Michael Pinnegar Address: 133 Fayano Corner Rd. Tel: (508) 998-3711

To connect a sewer and/or storm drain located at 53 Adams Island (Dunkin Donuts) Building
Assessor's Plot 100 Lot 22 to the sewer and/or storm drain in South side of 11th lying into 3rd Street
face main

To be laid in accordance with the conditions in this application and the City of New Bedford ordinances.

TYPE OF USE: RESIDENTIAL COMMERCIAL INDUSTRIAL FLOW G.P.D.

If applicant other than actual property owner, attach Letter of Authorization from Property Owner.

Name: J.B. Leregans Tel: (508) 326-8757
Mailing Address: 21 East Edge Drive North Dartmouth, MA 02747

The Bonded Contractor/Drain Layer authorized to perform this work is:

Name: J.B. Leregans Address: 21 East Edge Drive Tel: (508) 326-1608
Type of Pipe Required:

PERMIT EXPIRES ONE YEAR AFTER DATE OF ISSUE

- Requires separate connections for sewage and storm drain where applicable. Storm water cannot be discharged to a sanitary sewer.
- All work must be inspected and approved by a D.P.I. inspector before backfilling.
- If this connection is to be part of a private service shared jointly with other building owners, attach copy of Recorded Joint Maintenance Agreement.
- Permits can be issued to Industrial and/or Commercial Applicants only upon receipt and approval by the Commissioner of Public Infrastructure of required plans and supplemental information.
- In addition, a City-issued Industrial User Discharge Permit and/or a Sewer Extension/Connection Permit issued by the Commonwealth of Massachusetts D.E.P. shall be required by the City for Industrial Discharge into the sewer system.

Industrial User Discharge Permit No. 1117 Date 11/15/14

Comm. Mass. Sewer Conn./Ext. Permit No. 11-17 Date 11/15/14

A Filing and Inspection Fee of \$450.00, plus an Entrance Fee of \$ where applicable, must accompany this application.

Bank# Bp/Coast Bank Check# 33157 Date 11/20/14 Receipt# 27337

Other requirements: Please call ahead 24hr notice for inspection. See attached site & letter dated October 9th, 2014. Also, DPT letter October 15, 2014. Attachment A is also included in this permit to be signed by owner.

Connection made to: Sewer Part of jointly-shared private line YES NO
Storm Drain

Applicant agrees to abide by the above terms, as well as all pertinent ordinances of the City of New Bedford, and such other special rules as the Commissioner of Public Infrastructure and/or City Engineer may deem necessary

City Engineer

Signature of Property Owner or Representative

INSPECTED BY:

DATE:

COMMENTS:

APPROVED

DISAPPROVED

SIGNATURE

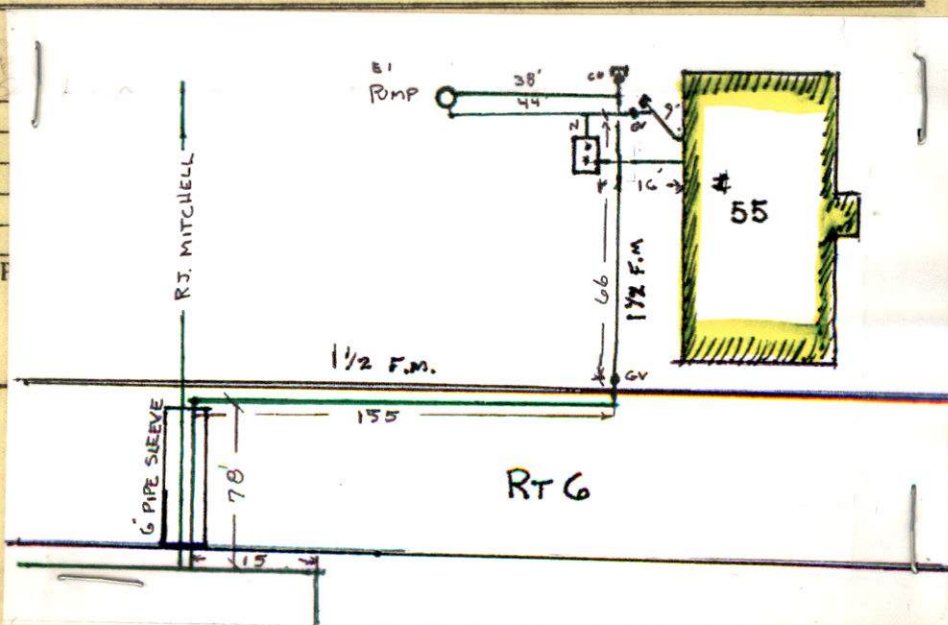



PERMIT NO.

24413

CITY OF NEW BEDFORD
SEWER AND/OR STORM DRAIN PERMIT

DATE 11/20/14

This certifies that permission is granted to

Michael Panagos 133 Faynce Corner Rd. (508) 998-3111
Property Owner Address Tel.

To connect a sewer and/or storm drain located at 53 Popes Island (Dunkin Donuts) Building
Assessor's Plot 600 Lot 22, to the sewer and/or storm drain in South side of Et. 6. tieing into Street
force main

To be laid in accordance with the conditions in this application and the City of New Bedford ordinances.

TYPE OF USE: RESIDENTIAL COMMERCIAL INDUSTRIAL FLOW G.P.D.

If applicant other than actual property owner, attach Letter of Authorization from Property Owner.

Name J.B. Lenagan Tel. (508) 326-8757
Mailing Address 21 East River Drive North Dorchester, MA 02127
The Bonded Contractor/Drain Layer authorized to perform this work is:

Name J.B. Lenagan Address 21 East River Drive Tel. (508) 984-1608
Type of Pipe Required:

PERMIT EXPIRES ONE YEAR AFTER DATE OF ISSUE

- Requires separate connections for sewage and storm drain where applicable. Storm water cannot be discharged to a sanitary sewer.
 - All work must be inspected and approved by a D.P.I. inspector before backfilling.
 - If this connection is to be part of a private service shared jointly with other building owners, attach copy of Recorded Joint Maintenance Agreement.
 - Permits can be issued to Industrial and/or Commercial Applicants only upon receipt and approval by the Commissioner of Public Infrastructure of required plans and supplemental information.
 - In addition, a City-issued Industrial User Discharge Permit and/or a Sewer Extension/Connection Permit issued by the Commonwealth of Massachusetts D.E.P. shall be required by the City for Industrial Discharge into the sewer system.
- Industrial User Discharge Permit No. 14-17 Date 11-17

Comm. Mass. Sewer Conn./Ext. Permit No. 14-17 attached Date 11/18/14
A Filing and Inspection Fee of \$450.00, plus an Entrance Fee of \$..... where applicable, must accompany this application.

Bank# Baycoast Bank Check# 33157 Date 11/20/14 Receipt# 27337

Other requirements: Please call ahead 24 hr notice for inspection. See attached Site C letter, dated October 9th, 2014. SOS 977-1550 ext. 506. CUSO, DPI letter October 15, 2014. Attachment A is also included in this permit to be signed by owner.

INSPECTOR'S REPORT

INSPECTED BY: _____
DATE: _____
COMMENTS: _____

APPROVED _____ DISAPPROVED _____

SIGNATURE

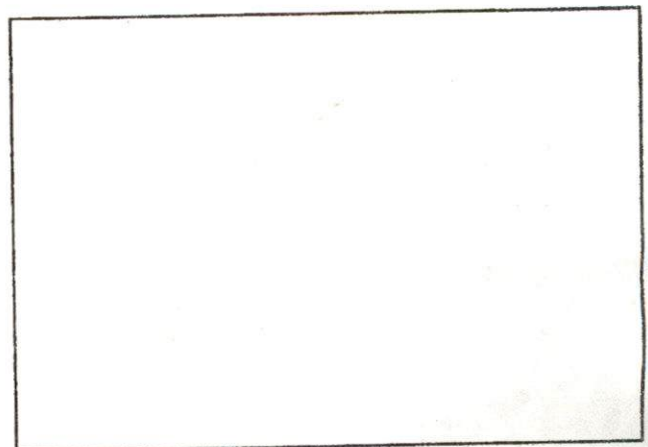

SKETCH PLAN



CITY OF NEW BEDFORD
Jonathan F. Mitchell, Mayor

Department of Public Infrastructure

Ronald H. Labelle
Commissioner

Water
Wastewater
Highways
Engineering
Cemetery

To Whom It May Concern:

I Michael Panagakos 133 Fawcett Corner Rd. Dartmouth, being
(Name) (Mailing Address)

Owner of property located at

53 Pope's Island

Plot 60, Lot 20, hereby agree to allow JB Lanagan + Co. Inc.
(Name)

21 East River Dr., Dartmouth, MA, to act on my behalf including affixing my
(Mailing Address) 02747

signature in securing permit for:

- ☒ Sewer/Drain Service Permits
- ☒ Water Service Permits
- ☒ Driveway Installation Permits
- ☒ Sidewalk Installation Permits

I further agree to conform to, and abide by, All City rules and ask regulations applicable to the permit (s) being applied for:

Name [Signature]
Signature

133 Fawcett Corner Rd. Dartmouth, MA
Address

508-998-3911
Date Telephone number

B. P. W. SEWER DIVISION
TOWN OF FAIRHAVEN

No. 344

Fairhaven, Mass. 11-19 - 2014

RECEIVED OF J. B. Lanagan
the sum of \$ 5,684.40 as a deposit to cover the cost of making sewer connection from
No. 53 Popes Island Street to sewer main in Popes Island (Rte 6) Street in
accordance with the above numbered application.

$5000. + 684.40 = 5684.40$
 $342259 \text{ Ft} \times .20159 \text{ Ft} = 684.40$
B. P. W.

Dunkin Donuts
53 Popes Island
N.B.

CK # 33161
Receipt # 227899

Town of Fairhaven

by [Signature]

NOTES

RECEIPT

DATE 11-19-14

NO. 227899

RECEIVED FROM J. B. Lanagan

ADDRESS _____

FOR deeper 53 Popes Island \$ 5684.40

N.B.

ACCOUNT		HOW PAID	
AMT. OF ACCOUNT		CASH	
AMT. PAID		CHECK	<u>33161</u>
BALANCE DUE		MONEY ORDER	

BY Charlene Lawton

©2001. REDIFORM. © 81808



Department of Public Infrastructure

Ronald H. Labelle
Commissioner

CITY OF NEW BEDFORD

Jonathan F. Mitchell, Mayor

Water
Wastewater
Highways
Engineering
Cemeteries

ATTACHMENT A

PERMIT # 24413

THIS DOCUMENT IS HEREBY ATTACHED AND MADE PART OF PERMIT # 24413
AND IS CONSIDERED TO BE A SPECIAL RULE DEEMED NECESSARY DUE TO SPECIAL
CIRCUMSTANCES ASSOCIATED WITH THE CONSTRUCTION APPROVED BY THIS
PERMIT.

Be advised that the signatory on this permit assumes the risk and agrees to further indemnification as described below during construction and for a period of not less than one year following completion of this construction.

The signatory agrees to indemnify the owner of the property at Map 60 Lot 19 against loss of and consequential damages to and resulting from the existing low pressure sewer service located in the six inch (6") sleeve pipe to be shared with the second low pressure sewer service pipe that is proposed to be installed in the same sleeve as approved by this permit.

In the event of failure of the existing low pressure sewer service for the property at Map 60 Lot 19 that occurs within the sleeve pipe and/or within three feet (3') of the entry or exit point of the sleeve pipe on or before the one year anniversary date of the completion of construction, the signatory shall be responsible for repairing and restoring said service pipe at no cost to the owner of the property at Map 60 Lot 19.

The SITEC letter dated October 9, 2014 containing responses to the Department of Public Infrastructure (DPI) letter dated September 30, 2014 (on file) is explicitly included and made a part of this permit and the list of ten items and two notations mentioned in the SITEC letter are considered as enforceable elements of this permit.

The DPI letter dated October 15, 2014 containing the final response to the SITEC letter mentioned above is explicitly included and made part of this permit approval.

An inspection hold-point is specifically declared in association with the work approved in this permit. The contractor performing the work shall ensure that a DPI inspector is on site to witness the north end sleeve entry conditions adjacent to the property at Map 60 Lot 19 prior to inserting the proposed low pressure sewer pipe into the sleeve pipe.

City Engineer 11/17/2014

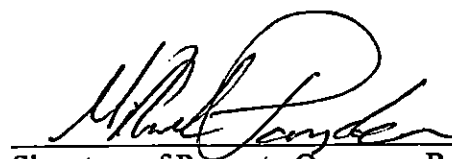
Signature of Property Owner or Representative 11/18/2014

Cheveli A. Torres

From: Sarah Porter
Sent: Monday, November 17, 2014 4:36 PM
To: David Fredette
Cc: Ronald Labelle; Zeb Arruda; Manuel Silva; Cheveli A. Torres
Subject: RE: RE: Panagakos Sewer Service for Dunkin Donuts

Hi Dave, thanks for the update, I will request the updated plans and review them with respect to the Con Com approved plans and let you know if they are all set or not

Sarah

From: David Fredette
Sent: Monday, November 17, 2014 2:32 PM
To: Sarah Porter
Cc: Ronald Labelle; Zeb Arruda; Manuel Silva; Cheveli A. Torres
Subject: RE: Panagakos Sewer Service for Dunkin Donuts

Hi Sarah,

Cheveli Torres showed me the email you sent her concerning 53 Popes Island. The contractor Jim Lanagan was at DPI this morning seeking the permit for the proposed sewer connection to be installed for the Dunkin Donuts operation. There is an RDA of which I have a copy of that was approved as of July 3, 2012. However that project was delayed by a number of issues. The most current plan for what is proposed has changed from the one submitted to your office in April 2012 so at the very least you should request a copy of the most recent plans but I believe that there has been no changes to the proposed work involving installation of the Environmental One pump near the existing septic system. I trust that you will have an opportunity to re-visit the project site as needed, evaluate the present situation and determine if the RDA on file can be sustained to enable this project to proceed. Please advise. DJF

Cheveli A. Torres

From: Sarah Porter
Sent: Wednesday, November 19, 2014 12:22 PM
To: Cheveli A. Torres
Cc: David Fredette
Subject: RE: 53 Popes Island

Cheveli, you can issue the permit for Pope's Island
Sarah

Dave, all changes were located outside of regulated areas so they are not required to appear back before the Commission.

From: Cheveli A. Torres
Sent: Monday, November 17, 2014 10:56 AM
To: Sarah Porter
Subject: 53 Popes Island

Hello,

I have a contractor here looking to pull a sewer permit, he is now going to BOH to get abandonment of septic. The location is 53 Popes Island- Dunkin donuts building. Let me know if this location is ok. Thanks

No. 14-19

FEE 60.00

COMMONWEALTH OF MASSACHUSETTS

Board of Health, New Bedford, MA.

DISPOSAL SYSTEM CONSTRUCTION PERMIT

Permission is hereby granted to; Construct() Repair() Upgrade() Abandon(☒) an individual sewage disposal system
at 58 Pope's Island as described in the application for

Disposal System Construction Permit No. 14-19, dated 11/18/14.

Provided: Construction shall be completed within three years of the date of this permit. All local conditions must be met.

Form 1255 Rev. 5/96 A.M. Sulkin Co. Boston, MA

Date 11/18/14 Board of Health by [Signature]