



EXPIRES 10/24/14

PERMIT NO.

CITY OF NEW BEDFORD
SEWER AND/OR STORM DRAIN PERMIT

DATE 10/24/14

24410

This certifies that permission is granted to

Property Owner

Address

706 Acushnet Ave

Tel.

508 509 6620

To connect a sewer and/or storm drain located at

5x Double Hung Co

Assessor's Plot

160

Lot

13

to the sewer and/or storm drain in

137-143 Popes Island

Street

To be laid in accordance with the conditions in this application and the City of New Bedford ordinances.

TYPE OF USE:

RESIDENTIAL

COMMERCIAL

INDUSTRIAL

FLOW

G.P.D.

If applicant other than actual property owner, attach Letter of Authorization from Property Owner.

Name

Charity A. Medeiros

Tel.

774 263 2629

Mailing Address

706 Acushnet Ave, NB, MA 02746

The Bonded Contractor/Drain Layer authorized to perform this work is:

Name

W.C. Smith + Sons

Address

148 Washburn St, NB, MA

Tel.

508 955 1447

Type of Pipe Required:

PERMIT EXPIRES ONE YEAR AFTER DATE OF ISSUE

- Requires separate connections for sewage and storm drain where applicable. Storm water cannot be discharged to a sanitary sewer.
- All work must be inspected and approved by a D.P.I. inspector before backfilling.
- If this connection is to be part of a private service shared jointly with other building owners, attach copy of Recorded Joint Maintenance Agreement.
- Permits can be issued to Industrial and/or Commercial Applicants only upon receipt and approval by the Commissioner of Public Infrastructure of required plans and supplemental information.
- In addition, a City-issued Industrial User Discharge Permit and/or a Sewer Extension/Connection Permit issued by the Commonwealth of Massachusetts D.E.P. shall be required by the City for Industrial Discharge into the sewer system.

Industrial User Discharge Permit No.

Date

Comm. Mass. Sewer Conn./Ext. Permit No.

14-15

Date

10/24/14

A Filing and Inspection Fee of \$400, plus an Entrance Fee of \$ where applicable, must accompany this application.

Bank#

Bank Five

Check#

15114544

Date

10/22/14

Receipt#

25755

Other requirements:

please call ahead 24h in advance

Connection made to

Sewer

Part of jointly-shared private line

YES

NO

Storm Drain

Applicant agrees to abide by the above terms, as well as all pertinent ordinances of the City of New Bedford, and such other special rules as the Commissioner of Public Infrastructure and/or City Engineer may deem necessary

City Engineer

Signature of Property Owner or Representative

INSPECTOR'S REPORT

INSPECTED BY:

DATE:

COMMENTS:

APPROVED

DISAPP

SIGNATURE

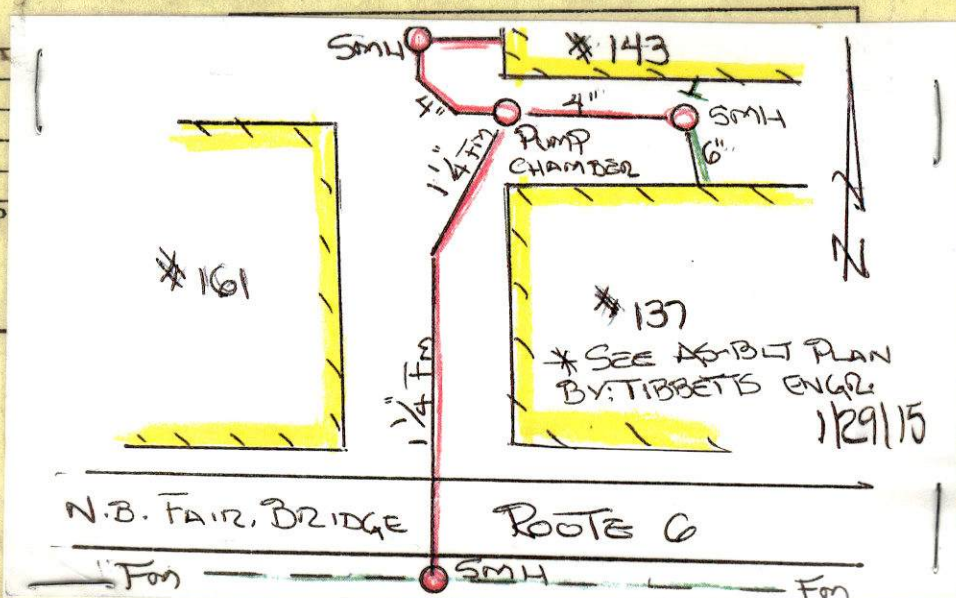

1

1

2

2

OFFICE OF THE SECRETARY OF THE ARMY

OFFICE OF THE SECRETARY OF THE ARMY

[Faint, illegible text and markings covering the majority of the page, including a large circular stamp on the left side.]



WW-14-31

expire 10/24/14

PERMIT NO. 24410

CITY OF NEW BEDFORD SEWER AND/OR STORM DRAIN PERMIT

DATE 10/24/14

6518/2.

This certifies that permission is granted to

SHORELINE RESOURCES LLC (Charles M Quinn)

Property Owner Address 700 Awshnet Ave NB, MA Tel. 508 509 6620

To connect a sewer and/or storm drain located at S. x Double Hazy Ln

Assessor's Plot 60 Lot 13 to the sewer and/or storm drain in 137-143 Popes Island Street

To be laid in accordance with the conditions in this application and the City of New Bedford ordinances.

TYPE OF USE: RESIDENTIAL COMMERCIAL INDUSTRIAL FLOW G.P.D.

If applicant other than actual property owner, attach Letter of Authorization from Property Owner.

Name Christopher A Medeiros Tel. 774 263 2129 Mailing Address 700 Awshnet Ave NB, MA 02740

The Bonded Contractor/Drain Layer authorized to perform this work is:

Name WC Smith + Sons Address 148 Washnet St NB, MA Tel. 508 955 1449

Type of Pipe Required:

PERMIT EXPIRES ONE YEAR AFTER DATE OF ISSUE

For BOA Service 137 + 137M

- Requires separate connections for sewage and storm drain where applicable. Storm water cannot be discharged to a sanitary sewer. All work must be inspected and approved by a D.P.I. inspector before backfilling. If this connection is to be part of a private service shared jointly with other building owners, attach copy of Recorded Joint Maintenance Agreement. Permits can be issued to Industrial and/or Commercial Applicants only upon receipt and approval by the Commissioner of Public Infrastructure of required plans and supplemental information. In addition, a City-issued Industrial User Discharge Permit and/or a Sewer Extension/Connection Permit issued by the Commonwealth of Massachusetts D.E.P. shall be required by the City for Industrial Discharge into the sewer system.

Industrial User Discharge Permit No. Date

Comm. Mass. Sewer Conn./Ext. Permit No. 14-15 Date 10/24/14

A Filing and Inspection Fee of \$... plus an Entrance Fee of \$... where applicable, must accompany this application.

Bank# Bank Five Check# 15114544 Date 10/22/14 Receipt# 25755

Other requirements: please call ahead 24hr in advance

for inspector

Connection made to Sewer Part of jointly-shared private line YES NO Storm Drain

Applicant agrees to abide by the above terms, as well as all pertinent ordinances of the City of New Bedford, and such other special rules as the Commissioner of Public Infrastructure and/or City Engineer may deem necessary

[Signature] City Engineer

[Signature] 10/24/2014 Signature of Property Owner or Representative City Engineer

INSPECTOR'S REPORT

INSPECTED BY: [Signature] DATE: 9/14/10 COMMENTS:

APPROVED DISAPPROVED

[Signature] SIGNATURE

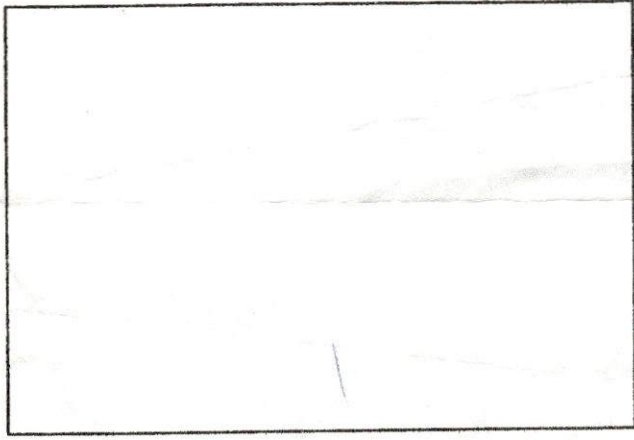

SKETCH PLAN



• НА БУДУЩЕ •

МИНИСТЕРСТВО НА КУЛЬТУРАТА И НАЧАЛНИКА НА КУЛЬТУРАТА

Handwritten scribbles and marks.

Main body of the document containing extremely faint, illegible text, possibly a list or report.

5410



Department of Public Infrastructure

Ronald H. Labelle
Commissioner

Water
Wastewater
Highways
Engineering
Cemetery

CITY OF NEW BEDFORD
Jonathan F. Mitchell, Mayor

To Whom It May Concern:

I Charles M. Quinn, Jr. 706 Acushnet Ave. New Bedford, being
(Name) Shoreline Resources, LLC (Mailing Address)

Owner of property located at

137-143 Popes Island New Bedford

Plot 60, Lot 13, hereby agree to allow Christopher A. Medeiros
(Name)

706 Acushnet Ave. New Bedford to act on my behalf including affixing my
(Mailing Address)

signature in securing permit for:

- Sewer/Drain Service Permits
- Water Service Permits
- Driveway Installation Permits
- Sidewalk Installation Permits

I further agree to conform to, and abide by, All City rules and ask regulations applicable to the permit (s) being applied for:

Name Charles M. Quinn, Jr.
Signature
706 Acushnet Ave. New Bedford, MA 02740
Address
10/24/2014 508-509-6620
Date Telephone number



No. 14-15

FEE 460.00

COMMONWEALTH OF MASSACHUSETTS

Board of Health, New Bedford, MA.

DISPOSAL SYSTEM CONSTRUCTION PERMIT

Permission is hereby granted to; Construct() Repair() Upgrade() Abandon() an individual sewage disposal system
at 137-143 Popes Island as described in the application for

Disposal System Construction Permit No. 14-15, dated 10-24.

Provided: Construction shall be completed within three years of the date of this permit. All local conditions must be met.

Form 1255 Rev. 5/96 A.M. Sulkin Co. Boston, MA

Date 10-24-14 Board of Health [Signature]

1000

1

CR #15114514
Receipt #

B. P. W. SEWER DIVISION
TOWN OF FAIRHAVEN

No. 340

Fairhaven, Mass. 10/22/2014

RECEIVED OF Chris Nedden - Shoreline Resources LLC

the sum of \$ 6959.20 as a deposit to cover the cost of making sewer connection from

No. 137-143 Popes Island Street to sewer main in Route 6 Street in

accordance with the above numbered application.

B. P. W.

Town of Fairhaven
by [Signature]



Commonwealth of Massachusetts

City of New Bedford

133 William Street New Bedford, MA 02740

SEWER PERMIT



Date: **12/10/2014**

No. **WW-14-31**

Sewer Connection Fee: \$450.00

Pipe Size: **0.00**

Trench Length: **0.00**

Service Location: **137-143 POPES ISLAND**

Owner Name: **NERI REALTY CO LLC**

Type of Occupancy: **Industrial**

Type of Work: **Sewer - New Service Abandon
Septic**

Work Description: **Service# 24410**

P.60 L.13

**S X Route Highway 6
137-143 Popes Island**

Abandonment of Septic form #14-15

Expires 10/24/15

No. of Units : **0** Required Design Daily Flow : **0.00** Provided Daily Flow : **0.00**

Sewer Permit

Installing Company Name: _____ License Type: _____

Address: _____ City/Town/State: _____

Call (781) 942-9077 For Inspection

Department of Transportation

City of New Bedford

SEWER PERMIT

Application No. _____ Date of Issuance _____

1. Name of Applicant: _____
2. Address: _____
3. City: _____ State: _____ Zip: _____

4. Description of Project: _____
5. Estimated Cost: _____

6. Date of Construction: _____
7. Signature of Applicant: _____
8. Signature of City Engineer: _____

9. Date of Permit: _____



Commonwealth of Massachusetts

City of New Bedford

133 William Street New Bedford, MA 02740



SEWER PERMIT

The undersigned petitions you to grant permission to ENTER INTO THE MAIN SEWER and, if such permission is granted, hereby agrees to the following:

1. To abide by the conditions and regulations imposed by the Commissioner of Public Works by statute or by ordinance now in force, or as amended from time to time.
2. That the connection of said sewer with the main sewer shall be inspected by an employee of the department of Public Works or by a designated agent of the Town before burial of said connection.
3. That the work shall at all times be under the direction and control of the Commissioner of Public Works or his authorized agent, and that any expense incurred by the Town shall be charged to the permittee, and said permittee agrees to reimburse the Town for said expense.

GRANTED WITH THE USUAL CONDITIONS

COMMISSIONER

OFFICE OF THE ATTORNEY GENERAL

STATE OF TEXAS

IN SENATE,
January 11, 1930.

REPORT OF THE ATTORNEY GENERAL
ON THE PROCEEDINGS OF THE
COMMISSIONERS OF THE GENERAL LAND OFFICE
IN CONNECTION WITH THE
LANDS BELONGING TO THE STATE OF TEXAS
AND THE PROCEEDINGS OF THE
COMMISSIONERS OF THE GENERAL LAND OFFICE
IN CONNECTION WITH THE
LANDS BELONGING TO THE STATE OF TEXAS

REPORT OF THE ATTORNEY GENERAL



Department of Public Infrastructure

Ronald H. Labelle
Commissioner

CITY OF NEW BEDFORD
Jonathan Mitchell, Mayor

Water
Wastewater
Highways
Engineering
Cemeteries
Park Maintenance

March 6th, 2015

#137 & #143
Popes Island
New Bedford, MA. 02740

RE: Sewer Permit # 24410

To Whom it May Concern,

All sewer construction performed by WC Smith & Son was inspected and field approved on a daily work basis by the City of New Bedford's / DPI Sewer Inspecting Engineer.

All new sewer lines and manhole structures installed met City of New Bedford's construction standards. Sewer As-built Plans have been reviewed and approved by the Department of Public Infrastructure.

Respectfully,

Robert R. Bichel
Supervising Civil Engineer
City of New Bedford
Dept. of Public Infrastructure

1. The first part of the document discusses the importance of maintaining accurate records of all transactions and activities.

2. It is essential to ensure that all data is entered correctly and consistently.

3. Regular audits should be conducted to verify the accuracy of the records.

4. The final section outlines the procedures for handling discrepancies and errors.

