



PERMIT NO.

24402

CITY OF NEW BEDFORD
SEWER AND/OR STORM DRAIN PERMIT

DATE

9/2/14

This certifies that permission is granted to

Property Owner Michelle Lavordiere Address 948 Barnum St. N.B. 02745 MA. Tel. (508) 951 5145

To connect a sewer and/or storm drain located at.....

Assessor's Plot 135A: 471 Lot....., to the sewer and/or storm drain in..... Street Grinder Pump force main into 21st Street (Paper Street)

To be laid in accordance with the conditions in this application and the City of New Bedford ordinances.

TYPE OF USE: RESIDENTIAL COMMERCIAL INDUSTRIAL FLOW 220 G.P.D.

If applicant other than actual property owner, attach Letter of Authorization from Property Owner.

Name..... Tel.....

Mailing Address.....

The Bonded Contractor/Drain Layer authorized to perform this work is:

Name D.J. Conner Address..... Tel.....Type of Pipe Required: SDR 35 PVC

PERMIT EXPIRES ONE YEAR AFTER DATE OF ISSUE

- Requires separate connections for sewage and storm drain where applicable. Storm water cannot be discharged to a sanitary sewer.
- All work must be inspected and approved by a D.P.I. inspector before backfilling.
- If this connection is to be part of a private service shared jointly with other building owners, attach copy of Recorded Joint Maintenance Agreement.
- Permits can be issued to Industrial and/or Commercial Applicants only upon receipt and approval by the Commissioner of Public Infrastructure of required plans and supplemental information.
- In addition, a City-issued Industrial User Discharge Permit and/or a Sewer Extension/Connection Permit issued by the Commonwealth of Massachusetts D.E.P. shall be required by the City for Industrial Discharge into the sewer system.

Industrial User Discharge Permit No..... Date.....

Comm. Mass. Sewer Conn./Ext. Permit No. 14-07 Date 8/22/14

A Filing and Inspection Fee of \$....., plus an Entrance Fee of \$..... where applicable, must accompany this application.

Bank# Bank of America Check# 1461503264 Date 9/2/14 Receipt# 22360Other requirements: Please call ahead 2hr notice for inspection(508) 979 1550 ext. 5020Connection made to Sewer Part of jointly-shared private line YES NO
Storm Drain

Applicant agrees to abide by the above terms, as well as all pertinent ordinances of the City of New Bedford, and such other special rules as the Commissioner of Public Infrastructure and/or City Engineer may deem necessary

City Engineer

Signature of Property Owner or Representative

INSPECTOR'S REPORT

INSPECTED BY:.....

DATE:.....

COMMENTS:.....

APPROVED

DISA

SEE WHITE SHEET

SIGNATURE

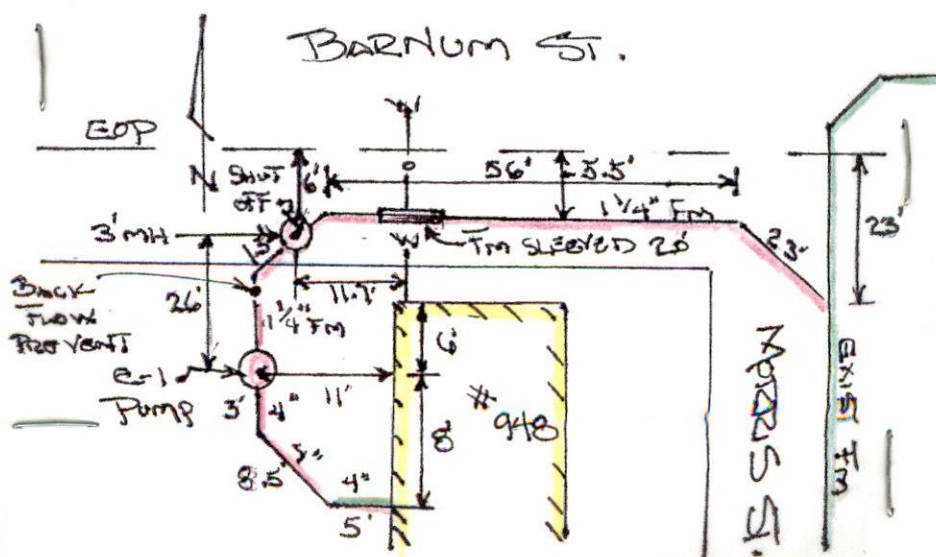



FORMER STAFF (R) 9/18/14 Expires 9/2/15
Inspector 1:00 PM Monday
DATE 9/2/14

PERMIT NO.
24402

CITY OF NEW BEDFORD
SEWER AND/OR STORM DRAIN PERMIT

This certifies that permission is granted to

Property Owner: Michele Laverdiere Address: 948 Barnum St (SOS) 951-5145
Tel. N.B. 02745

To connect a sewer and/or storm drain located at 948 Barnum Street
Assessor's Plot 130A 474 Lot 474, to the sewer and/or storm drain in Grinder Pump force main into 2nd Street
(Paper Street)

To be laid in accordance with the conditions in this application and the City of New Bedford ordinances.

TYPE OF USE: RESIDENTIAL COMMERCIAL INDUSTRIAL FLOW 220 G.P.D.

If applicant other than actual property owner, attach Letter of Authorization from Property Owner.

Name: N/A Tel.:

Mailing Address: N/A

The Bonded Contractor/Drain Layer authorized to perform this work is:

Name: R.J. Connessa Address: Tel.:

Type of Pipe Required: 35 PVC

PERMIT EXPIRES ONE YEAR AFTER DATE OF ISSUE

- Requires separate connections for sewage and storm drain where applicable. Storm water cannot be discharged to a sanitary sewer.
- All work must be inspected and approved by a D.P.I. inspector before backfilling.
- If this connection is to be part of a private service shared jointly with other building owners, attach copy of Recorded Joint Maintenance Agreement.
- Permits can be issued to Industrial and/or Commercial Applicants only upon receipt and approval by the Commissioner of Public Infrastructure of required plans and supplemental information.
- In addition, a City-issued Industrial User Discharge Permit and/or a Sewer Extension/Connection Permit issued by the Commonwealth of Massachusetts D.E.P. shall be required by the City for Industrial Discharge into the sewer system.

Industrial User Discharge Permit No. Date:

Comm. Mass. Sewer Conn./Ext. Permit No. 14-07 Date: 8/22/14

A Filing and Inspection Fee of \$450.00, plus an Entrance Fee of \$ where applicable, must accompany this application.

Bank# Bank of America Check# 1464563264 Date 9/2/14 Receipt#

Other requirements: Please call ahead 24hr notice for inspection
(SOS) 979-1550 ext-500

Connection made to: ☒ Sewer ☐ Storm Drain
Part of jointly-shared private line YES NO

Applicant agrees to abide by the above terms, as well as all pertinent ordinances of the City of New Bedford, and such other special rules as the Commissioner of Public Infrastructure and/or City Engineer may deem necessary

City Engineer: [Signature] 9/2/2014

Signature of Property Owner or Representative: Michele Laverdiere

INSPECTOR'S REPORT

INSPECTED BY: [Signature]
DATE: 9/9/14
COMMENTS:

APPROVED

DISAPPROVED

SIGNATURE

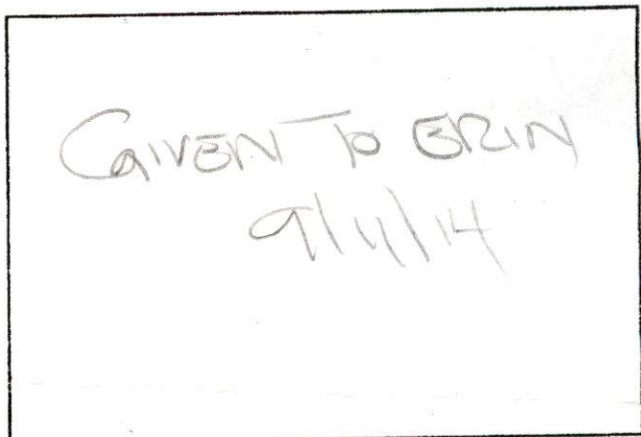

SKETCH PLAN

WW-17-23

EXP 9/2/15



PERMIT NO.
24402

CITY OF NEW BEDFORD
SEWER AND/OR STORM DRAIN PERMIT

DATE 9/2/14

This certifies that permission is granted to

Property Owner Michele Lavardiere Address 948 Barnum St Tel. (508) 951-5145
N.B 02745 MA

To connect a sewer and/or storm drain located at 948 Barnum Street
Assessor's Plot 130A Lot 474 to the sewer and/or storm drain in Grinder Pump force main into 2' Morris Street Street
(Paper Street)

To be laid in accordance with the conditions in this application and the City of New Bedford ordinances.
TYPE OF USE: RESIDENTIAL COMMERCIAL INDUSTRIAL FLOW 220 G.P.D.

If applicant other than actual property owner, attach Letter of Authorization from Property Owner.

Name N/A Tel. _____
Mailing Address _____

The Bonded Contractor/Drain Layer authorized to perform this work is:

Name R.J. Connessa Address _____ Tel. _____
Type of Pipe Required: SPR 35 PVC

PERMIT EXPIRES ONE YEAR AFTER DATE OF ISSUE

- Requires separate connections for sewage and storm drain where applicable. Storm water cannot be discharged to a sanitary sewer.
- All work must be inspected and approved by a D.P.I. inspector before backfilling.
- If this connection is to be part of a private service shared jointly with other building owners, attach copy of Recorded Joint Maintenance Agreement.
- Permits can be issued to Industrial and/or Commercial Applicants only upon receipt and approval by the Commissioner of Public Infrastructure of required plans and supplemental information.
- In addition, a City-issued Industrial User Discharge Permit and/or a Sewer Extension/Connection Permit issued by the Commonwealth of Massachusetts D.E.P. shall be required by the City for Industrial Discharge into the sewer system.

Industrial User Discharge Permit No. _____ Date _____

Comm. Mass. Sewer Conn./Ext. Permit No. 14-07 Date 8/22/14
A Filing and Inspection Fee of \$ 450.00 plus an Entrance Fee of \$ _____ where applicable, must accompany this application.

Bank# Bank of America Check# 1464503264 Date 9/2/14 Receipt# 22960

Other requirements: Please call ahead 2hr notice for inspection
(508) 979-1550 ext - 5020

Connection made to (Sewer) Part of jointly-shared private line YES NO
Storm Drain

Applicant agrees to abide by the above terms, as well as all pertinent ordinances of the City of New Bedford, and such other special rules as the Commissioner of Public Infrastructure and/or City Engineer may deem necessary

[Signature] 9/2/2014
City Engineer

[Signature]
Signature of Property Owner or Representative

INSPECTOR'S REPORT

INSPECTED BY: _____
DATE: _____
COMMENTS: _____

APPROVED _____ DISAPPROVED _____

SIGNATURE

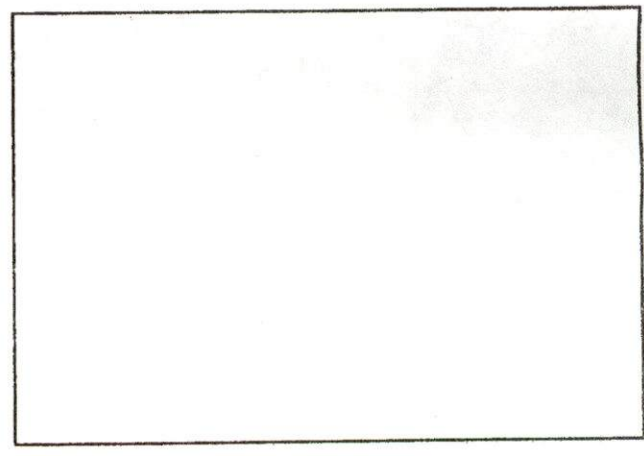

SKETCH PLAN



DISPLAY PERMIT IN A CONSPICUOUS PLACE ON THE PREMISES



Commonwealth of Massachusetts

City of New Bedford

133 William Street New Bedford, MA 02740

SEWER PERMIT



Date: 9/15/2014

No. WW-14-23

Sewer Connection Fee: \$450.00

Pipe Size: 0.00

Trench Length: 0.00

Service Location: 948 BARNUM ST

Owner Name: FERREIRA MICHELLE

Type of Occupancy: Residential

Type of Work: Sewer - New Service Abandon
Septic

Work Description: sewer permit #24402
P.130A L.474

948 Barnum St

abandonin septic system
permit #14-07

grinder pump force main into 2' on Morris St - Paper Street

Expires 9/2/15

No. of Units : 2

Required Design Daily Flow : 220.00

Provided Daily Flow : 220.00

The undersigned petitions you to grant permission to ENTER INTO THE MAIN SEWER and, if such permission is granted, hereby agrees to the following:

1. To abide by the conditions and regulations imposed by the Commissioner of Public Works by statute or by ordinance now in force, or as amended from time to time.
2. That the connection of said sewer with the main sewer shall be inspected by an employee of the department of Public Works or by a designated agent of the Town before burial of said connection.
3. That the work shall at all times be under the direction and control of the Commissioner of Public Works or his authorized agent, and that any expense incurred by the Town shall be charged to the permittee, and said

permittee

agrees to reimburse the Town for said expense.

Installing Company Name: Robert J. Canessa

License Type: CSI-DM
Residential
Demolition Only

Call (781) 942-9077 For Inspection

No. 14-07

COMMONWEALTH OF MASSACHUSETTS

Board of Health, NEW BEDFORD, MA.

DISPOSAL SYSTEM CONSTRUCTION PERMIT

FEE

60.00

BCA # 146440646
080658

Permission is hereby granted to; Construct() Repair() Upgrade() Abandon(☒) an individual sewage disposal system
at 948 Barnum ST as described in the application for

Disposal System Construction Permit No. 14-07, dated 8/22/14

Provided: Construction shall be completed within three years of the date of this permit. All local conditions must be met.

Date 8/22/14 Board of Health [Signature]

Cheveli A. Torres

From: Sarah Porter
Sent: Tuesday, September 02, 2014 9:46 AM
To: Cheveli A. Torres
Subject: RE: 948 BARNUM ST

That's OK – I already informed Manny and talked to the contractor
Thank you

From: Cheveli A. Torres
Sent: Tuesday, September 02, 2014 9:45 AM
To: Sarah Porter
Subject: 948 BARNUM ST

Hello, Sarah

I was just informed, that this location will be tying into sewer, I will later be given more information as far as if they are on septic or not. Just making sure that they are ok as far as wetlands. Location 948 Barnum Street.

Thank you,
Cheveli



Commonwealth of Massachusetts

CITY OF NEW BEDFORD

City Hall, Room 308, 133 William Street New Bedford, MA 02740 (508) 979-1540



FOUNDATION PERMIT

10/9/2015

No. B-15-1868

MSBC Sect. 111.8 - Any permit issued shall be deemed abandoned and invalid unless the work authorized by it shall have been commenced within six (6) months after its issuance.

FEE PAID \$100.00

This certifies that Daniel P Moniz

owner/contractor has permission to:

SS OSGOOD ST

ON: Foundations Only 1-2 Family - 100.00

Providing that the person accepting this permit shall in every respect conform to the terms of application therefore on file in this office; to the provisions of the statute of the Commonwealth and to the by-laws of the City of New Bedford relating to the inspection, erection, enlarging, altering, raising, moving, repairing, or tearing down of a building.

Permit is issued subject to the following special requirements: (Restrictions)



Wiring Inspector



Plumbing Inspector



Building Inspector

YOUR AREA INSPECTOR IS: Thomas Welch

Tel. (508) 979-1540 Between 8:00am - 9:00am

NOTICE: NOTIFY INSPECTOR 48 HOURS IN ADVANCE OF APPLYING SHEATHING OR LATHING

OCCUPANCY PERMIT REQUIRED BEFORE OCCUPANCY

No Building or Structure shall be used or occupied until the Certificate of Use and Occupancy shall have been issued by the Building Commissioner - MSBC, Sect. 120.1

This Card Must Be Displayed in a Conspicuous Place on the Premises and Not Torn Down or Removed Until Completion of Work

SUBJECT TO MASSACHUSETTS
STATE BUILDING CODE

Danny D. Romanowicz

Building Inspector

an Review Comments:

